

Notes on Parks
in
Katherine Street

$a = 17.50$ $b = 52 - r$
 $c = 21.40 + 2 = 10.70 + r$ x and y are semi circles
 $d = 2.28$ $z = 235.54$
 $e = 43.75 - r$ $n = 257.36$

INDEX

By 16/6/1900

R. R.

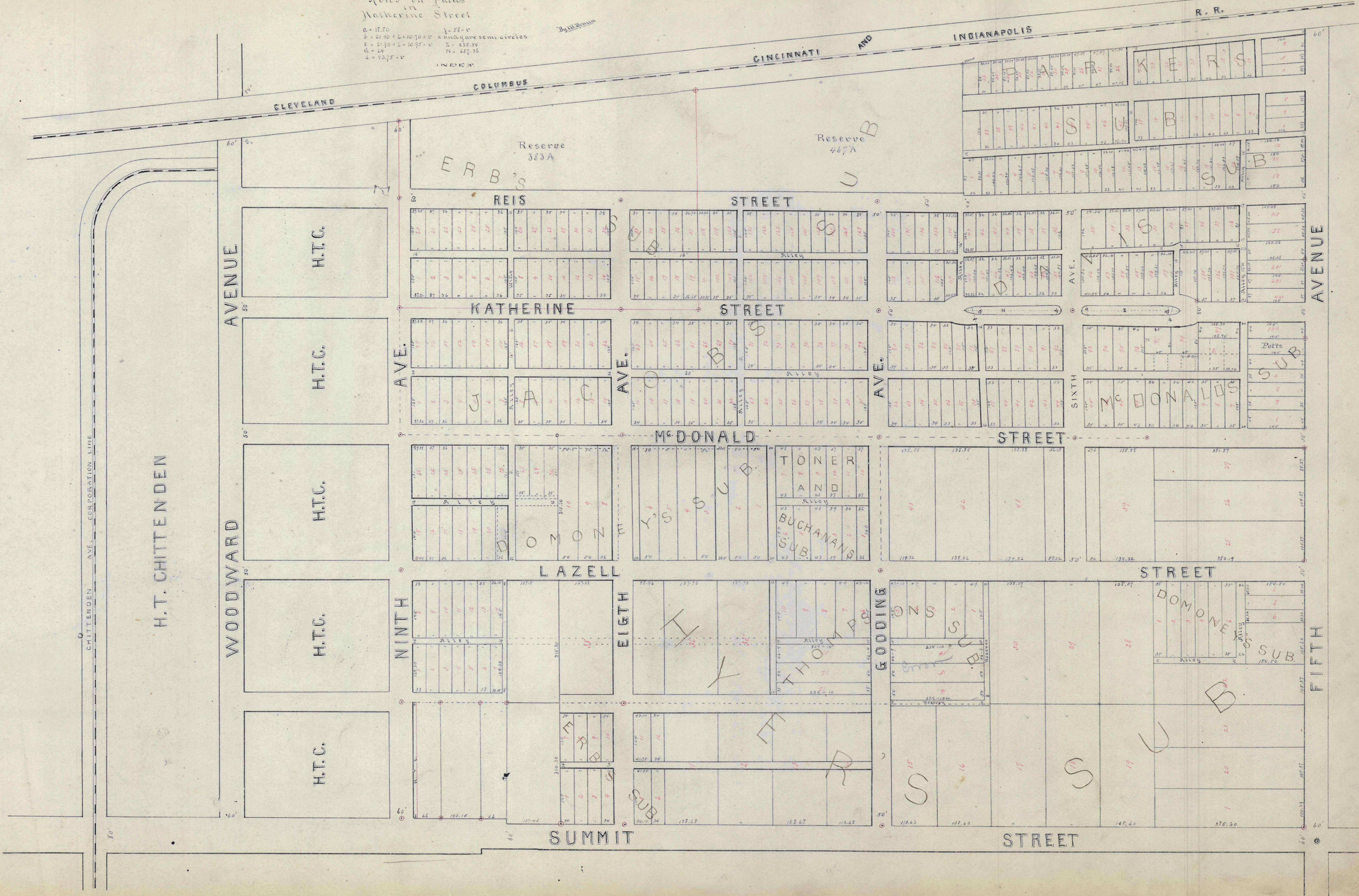

CHITTENDEN AVE. CORPORATION LINE

H.T. CHITTENDEN

WOODWARD AVE.

WOODWARD AVE.

H.T.C.

H.T.C.

H.T.C.

H.T.C.

H.T.C.

AVE.

NINTH AVE.

AVE.

EIGHTH AVE.

AVE.

GODDING AVE.

WOODWARD AVE.

FIFTH AVE.

Reserve 383A

Reserve 467A

ERB'S

REIS STREET

REIS STREET

KATHERINE STREET

KATHERINE STREET

MCDONALD STREET

MCDONALD STREET

LAZELL STREET

LAZELL STREET

SUMMIT STREET

SUMMIT STREET

TONER AND BUCHANAN'S SUB.

MCDONALD'S

DOMONE'S SUB.

POTTE'S SUB.

ERB'S

REIS STREET

REIS STREET

KATHERINE STREET

KATHERINE STREET

MCDONALD STREET

MCDONALD STREET

LAZELL STREET

LAZELL STREET

SUMMIT STREET

SUMMIT STREET

TONER AND BUCHANAN'S SUB.

MCDONALD'S

DOMONE'S SUB.

POTTE'S SUB.