

DEAN C. RINGLE, P.E., P.S.
FRANKLIN COUNTY ENGINEER

January 29, 2002

Honorable Board of County Commissioners
Franklin County Administration Building
373 South High Street, 26th Floor
Columbus, Ohio 43215

Honorable Board:

I hereby request that proceedings be initiated by your Honorable Board for the rehabilitation of the following bridges and structures in Franklin County, Ohio:

- Big Run Road retaining wall study 2000' east of Harrisburg Pike;
- Grove City Road 5.61 over Grove City Creek structure replacement;
- Harrisburg-Georgesville Road 0.70 over a tributary to the Big Darby Creek structure replacement;
- Harrisburg-Georgesville Road 0.83 over Smith County Ditch structure replacement;
- Canal Winchester South Road 1.91 over a tributary to the Little Walnut Creek structure replacement.

It is also requested that a consulting engineer be employed to assist me in preparing a report, consisting of full and accurate plans, specifications, estimates of cost and all other necessary documents relating to the above mentioned projects. We are of the opinion that said reports could be submitted on or before December 31, 2002.

Thank you for your consideration regarding this matter.

Respectfully submitted,

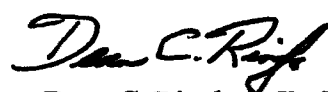
Dean C. Ringle, P.E., P.S.
Franklin County Engineer

DCR:TML:cmc

RESOLUTION NO. 168-02

February 5, 2002

**REHABILITATION OF VARIOUS BRIDGES
AND STRUCTURES IN FRANKLIN COUNTY,
DECLARED NECESSARY
(FRANKLIN COUNTY ENGINEER)**

WHEREAS, the Franklin County Engineer has requested that the rehabilitation of the following structures in Franklin County be completed:

- Big Run Road retaining wall study 2000' east of Harrisburg Pike;
- Grove City Road 5.61 over Grove City Creek structure replacement;
- Harrisburg-Georgesville Road 0.70 over a tributary to the Big Darby Creek structure replacement;
- Harrisburg-Georgesville Road 0.83 over Smith County Ditch structure replacement;
- Canal Winchester South Road 1.91 over a tributary to the Little Walnut Creek structure replacement.

WHEREAS, this work will include the replacement and rehabilitation of the existing structures; now, therefore, upon motion of Commissioner **Kilroy**, seconded by Commissioner **Shoemaker**,

BE IT RESOLVED, BY THE BOARD OF COUNTY COMMISSIONERS OF FRANKLIN COUNTY, OHIO:

Section 1) That the Franklin County Engineer is hereby directed to prepare a report, consisting of full and accurate plans, specifications, estimates of cost and all other necessary documents for the above mentioned improvements as prescribed by law, and he shall file said report at a joint meeting of the County Commissioners, County Auditor and County Engineer for their approval or recommendations, said report is to be ready for filing on or before December 31, 2002.

Section 2) That the Franklin County Engineer, by his request is hereby directed to investigate and recommend a consulting engineer to be hired to assist him in the preparation of said report.

RESOLUTION, Cont'd.
REHABILITATION OF VARIOUS BRIDGES
AND STRUCTURES IN FRANKLIN COUNTY,
DECLARED NECESSARY
(FRANKLIN COUNTY ENGINEER)

Page 2

Voting Aye thereon:

ARLENE SHOEMAKER, PRESIDENT

DEWEY R. STOKES

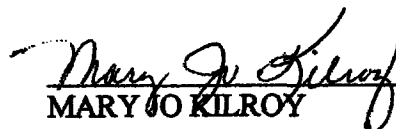
MARY JO KILROY
BOARD OF COUNTY COMMISSIONERS
FRANKLIN COUNTY, OHIO

Voting Nay thereon:

ARLENE SHOEMAKER, PRESIDENT

DEWEY R. STOKES

MARY JO KILROY
BOARD OF COUNTY COMMISSIONERS
FRANKLIN COUNTY, OHIO

DCR:TML:cmc

c: Journal
Engineer-Bridge Rehabilitations

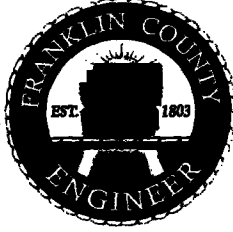

DEAN C. RINGLE, P.E., P.S.
FRANKLIN COUNTY ENGINEER

November 23, 2007

Honorable Board of County Commissioners
Franklin County Administration Building
373 South High Street, 26th Floor
Columbus, Ohio 43215

Honorable Board:

Pursuant to your resolution dated February 5, 2002, I have prepared right-of-way and construction plans, profiles, specifications, estimates of cost and all other information required by the County Engineer, for the improvement of Grove City Road 5.61 over Grove City Creek, Jackson Township, Franklin County, Ohio.

It is my recommendation that the Grove City Road improvement be approved as shown on the submitted plans.

Respectfully submitted,

A handwritten signature in cursive script that reads "Dean C. Ringle".

Dean C. Ringle, P.E., P.S.
Franklin County Engineer

DCR:TML:cmc

RESOLUTION NO. 1027-07

December 4, 2007

**RIGHT OF WAY AND CONSTRUCTION PLANS
APPROVED FOR THE REPLACEMENT OF
THE BRIDGE ON GROVE CITY ROAD OVER
GROVE CITY CREEK, (JAC-135-5.61), JACKSON
TOWNSHIP, FRANKLIN COUNTY, OHIO
(FRANKLIN COUNTY ENGINEER)**

WHEREAS, on February 5, 2002, the Board of County Commissioners by resolution, directed the County Engineer to prepare plans, specifications, estimates of cost and all other necessary documents relative to the construction and purchase of additional right of way for the replacement of the bridge on Grove City Road over Grove City Creek, (JAC-135-5.61), Jackson Township, Franklin County, Ohio, and the approaches thereto, and he shall file said report at a joint meeting of the County Commissioners, County Auditor and the County Engineer for their approval or recommendations, said report is to be submitted on or before December 4, 2007; and

WHEREAS, on December 4, 2007, the Franklin County Engineer submitted his report to a joint meeting of the County Commissioners, County Auditor and County Engineer; and

WHEREAS, the plans, specifications and other documents relative to the construction and purchase of additional right of way for the replacement of the bridge on Grove City Road over Grove City Creek, (JAC-135-5.61), Jackson Township, Franklin County, Ohio, were approved at said meeting; now, therefore upon motion of Commissioner Brown, seconded by Commissioner Brooks,

BE IT RESOLVED, BY THE BOARD OF COUNTY COMMISSIONERS OF FRANKLIN COUNTY, OHIO:

Section 1) That it is the opinion of said Board that the public convenience and welfare, require that said improvement be made, and that a copy of the plans and specifications shall be kept on file in the office of the County Auditor and a copy of the plans, specifications and estimates relating to the construction of said project are to be kept in the office of the County Engineer and kept for inspection for parties interested.

Section 2) That the Franklin County Engineer is hereby directed to proceed with the purchase of additional right of way and also is authorized to investigate and recommend the employment of a real estate appraiser to assist him in determining the value of land to be acquired.

RESOLUTION, Cont'd.
RIGHT OF WAY AND CONSTRUCTION PLANS
APPROVED FOR THE REPLACEMENT OF
THE BRIDGE ON GROVE CITY ROAD OVER
GROVE CITY CREEK, (JAC-135-5.61), JACKSON
TOWNSHIP, FRANKLIN COUNTY, OHIO
(FRANKLIN COUNTY ENGINEER)

Page 4

Approved By:



JOSEPH W. TESTA
FRANKLIN COUNTY AUDITOR

DEAN C. RINGLE, P.E., P.S.
FRANKLIN COUNTY ENGINEER

Voting Aye thereon:

MARY JO KILROY, PRESIDENT

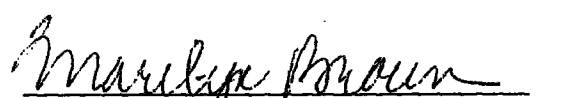
PAULA BROOKS, COMMISSIONER

MARILYN BROWN, COMMISSIONER
BOARD OF COUNTY COMMISSIONERS
FRANKLIN COUNTY, OHIO

Voting Nay thereon:

MARY JO KILROY, PRESIDENT

PAULA BROOKS, COMMISSIONER

MARILYN BROWN, COMMISSIONER
BOARD OF COUNTY COMMISSIONERS
FRANKLIN COUNTY, OHIO

DCR:TML:cmc

c: Engineer

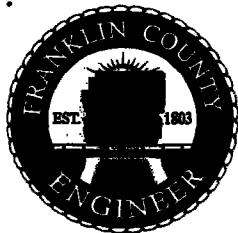

DEAN C. RINGLE, P.E., P.S.
FRANKLIN COUNTY ENGINEER

March 27, 2008

Honorable Board of County Commissioners
 Franklin County Administration Building
 373 South High Street, 26th Floor
 Columbus, Ohio 43215

Honorable Board:

After negotiating with a portion of the owners abutting Grove City Road over Grove City Creek, County Road No. 135, Jackson Township, Franklin County, Ohio, for the purchase of additional land needed for road purposes, I hereby submit for your consideration the following recommendation as to the amount of compensation and damages to be awarded to the owners of land sought to be appropriated.

<u>AUDITOR'S</u> <u>PAR. NO.</u>	<u>ENGR'S</u> <u>PAR. NO.</u>	<u>NAME</u>	<u>AMOUNT</u>
160-001084	1-WD, T	Max K. and Marilyn E. Gibboney	\$ 3,000.00
160-001086	2-WD, T	Marcella R. Hickman	6,600.00
160-001109	3-WD, T	Joseph P. and Robin B. Pickens	300.00
160-002536	4-T	Thomas E. and Cheryl A. Sefchick	300.00
160-001318	5-WD, T	Randy Sefchick	3,140.00
160-001072	6-SH, T	Kent S. and Karen R. Anslinger	4,510.00
		Total	\$ 17,850.00

I am of the opinion that the sums above recommended to be paid to this portion of the owners to be just and equitable for the land taken and damages sustained by reason of the improvement of Grove City Road over Grove City Creek, County Road No. 135, Jackson Township, Franklin County, Ohio.

Respectfully submitted,

Dean C. Ringle
 Dean C. Ringle, P.E., P.S.
 Franklin County Engineer

DCR:TML:cmc

RESOLUTION NO. 302-08

April 8, 2008

REPORT (FIRST) OF THE COUNTY ENGINEER
AND ESTABLISHING SUMS FOR COMPENSATION
AND DAMAGES FOR A PORTION OF THE OWNERS
IN THE MATTER OF THE IMPROVEMENT OF
GROVE CITY ROAD OVER GROVE CITY CREEK,
COUNTY ROAD NO. 135, JACKSON TOWNSHIP,
FRANKLIN COUNTY, OHIO
(FRANKLIN COUNTY ENGINEER - \$17,850.00)

WHEREAS, on February 5, 2002, the Board of County Commissioners did by resolution duly adopted find in favor of improving Grove City Road over Grove City Creek, County Road No. 135, Jackson Township, Franklin County, Ohio; and

WHEREAS, the Franklin County Engineer has negotiated with a portion of the property owners abutting Grove City Road over Grove City Creek, County Road No. 135, Jackson Township, Franklin County, Ohio; and

WHEREAS, the Franklin County Engineer has advised this Board by letter dated March 27, 2008, that it is his recommendation that the following amounts of compensation and damages to be awarded to the owners of land sought to be appropriated; and

WHEREAS, the attached purchase order encumbrances have been pre-certified as to the availability of funds by the Franklin County Auditor for payment; now, therefore, upon motion of Commissioner Kilroy, seconded by Commissioner Brooks.

AUDITOR'S <u>PAR. NO.</u>	ENGR'S <u>PAR. NO.</u>	<u>NAME</u>	<u>AMOUNT</u>
160-001084	1-WD, T	Max K. and Marilyn E. Gibboney	\$ 3,000.00
160-001086	2-WD, T	Marcella R. Hickman	6,600.00
160-001109	3-WD, T	Joseph P. and Robin B. Pickens	300.00
160-002536	4-T	Thomas E. and Cheryl A. Sefchick	300.00
160-001318	5-WD, T	Randy Sefchick	3,140.00
160-001072	6-SH, T	Kent S. and Karen R. Anslinger	<u>4,510.00</u>
		Total	\$ 17,850.00

BE IT RESOLVED, BY THE BOARD OF COUNTY COMMISSIONERS OF FRANKLIN COUNTY, OHIO:

Section 1) That after due consideration the amounts of compensation and damages as recommended by the Franklin County Engineer for the improvement of Grove City Road over Grove City Creek, County Road No. 135, Jackson Township, Franklin County, Ohio, are just and equitable for the lands taken and damages sustained by reason of said road improvement are hereby approved.

RESOLUTION, Cont'd.
REPORT (FIRST) OF THE COUNTY ENGINEER
AND ESTABLISHING SUMS FOR COMPENSATION
AND DAMAGES FOR A PORTION OF THE OWNERS
IN THE MATTER OF THE IMPROVEMENT OF
GROVE CITY ROAD OVER GROVE CITY CREEK,
COUNTY ROAD NO. 135, JACKSON TOWNSHIP,
FRANKLIN COUNTY, OHIO
(FRANKLIN COUNTY ENGINEER - \$17,850.00)

Page 2

Section 2) That the attached purchase orders that are individually described on the accompanying Purchase Order Proof List have been pre-certified by the Franklin County Auditor for payment.

Voting Aye thereon:

MARILYN BROWN, PRESIDENT



MARY JO KILROY, COMMISSIONER



PAULA BROOKS, COMMISSIONER
BOARD OF COUNTY COMMISSIONERS
FRANKLIN COUNTY, OHIO

Voting Nay thereon:

MARILYN BROWN, PRESIDENT

MARY JO KILROY, COMMISSIONER

PAULA BROOKS, COMMISSIONER
BOARD OF COUNTY COMMISSIONERS
FRANKLIN COUNTY, OHIO

DCR:TML:cmc

c: Engineer – Grove City Rd O/Grove City Creek, #4180
Road Record

FRANKLIN COUNTY, OHIO
 OFFICE OF COUNTY ENGINEER
GROVE CITY ROAD
JAC - 135 - 5.61
 OVER GROVE CITY CREEK
 COUNTY ROAD NO. 135
 JACKSON TOWNSHIP

ESTABLISHING, ALTERING AND WIDENING
RIGHT OF WAY
 ACQUIRING AGENCY: COUNTY OF FRANKLIN

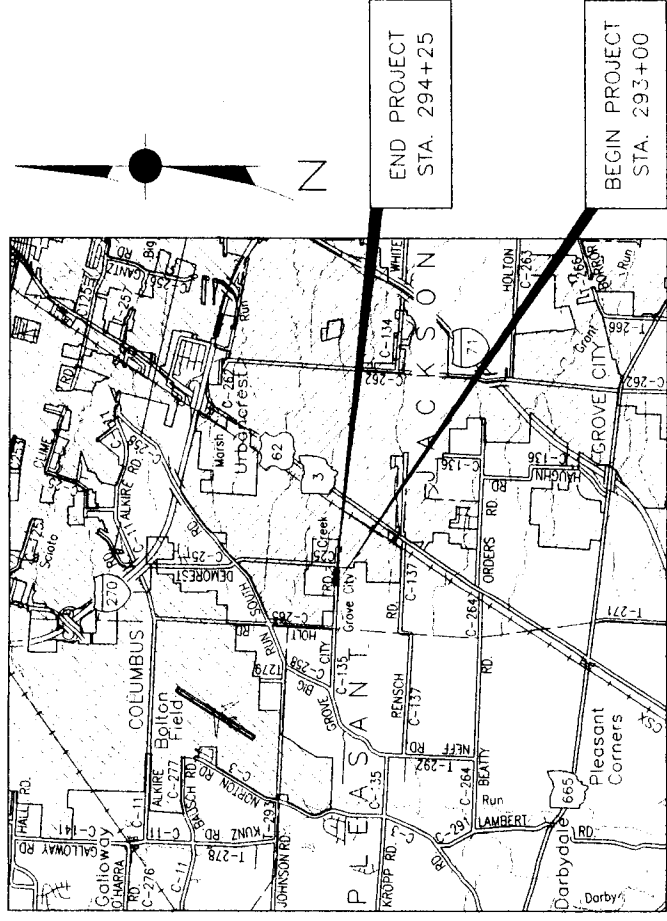

LOCATION MAP
 LATITUDE: N 39° 52' 56" LONGITUDE: W 83° 06' 37"
 SCALE IN MILES

INDEX OF SHEETS

TITLE SHEET	---	1
CENTERLINE SURVEY PLAT	---	1A
PROPERTY MAP	---	2
RIGHT OF WAY PLAN	---	3
RIGHT OF WAY SUMMARY	---	4

UNDERGROUND UTILITIES
 TWO WORKING DAYS
BEFORE YOU DIG
 CALL 1-800-362-2764
 OHIO UTILITIES PROTECTION SERVICE
 NON-MEMBERS MUST
 BE CALLED DIRECTLY

PLANS PREPARED BY:
COLUMBUS ENGINEERING CONSULTANTS INCORPORATED
 CONSULTING CIVIL ENGINEERS
 840 MICHIGAN AVENUE
 COLUMBUS, OHIO 43215
 PHONE: (614) 228-3500
 FAX: (614) 228-3519

COLUMBUS ENGINEERING CONSULTANTS, INC.

DATE	11/21/07	FRANKLIN COUNTY CHIEF DEPUTY ENGINEER
DATE	11/19/07	FRANKLIN COUNTY ENGINEER
DATE	12/14/07	FRANKLIN COUNTY AUDITOR
WE, THE COMMISSIONERS OF FRANKLIN COUNTY IN FORMAL SESSION HEREBY APPROVE THESE PLANS.		
DATE	12/14/07	FRANKLIN COUNTY COMMISSIONER
DATE	12/14/07	FRANKLIN COUNTY COMMISSIONER
DATE	12/14/07	FRANKLIN COUNTY COMMISSIONER

Printing: C:\p000871\56449.m-11

STATION	OFFSET	SIDE
291+64.27	35.00	RIGHT
291+64.77	34.00	LEFT
292+37.87	35.00	RIGHT
292+66.75	55.25	RIGHT
292+96.88	42.00	RIGHT
293+18.32	34.00	LEFT
293+18.49	44.00	LEFT
294+92.38	44.00	LEFT
294+92.18	30.00	LEFT
295+00.00	30.00	LEFT

JAC - 135 - 5.61
GROVE CITY ROAD
FRANKLIN COUNTY, OHIO
JACKSON TOWNSHIP
V.M.S. 1383 AND V.M.S. 1388

MONUMENT LEGEND
 [Symbol] MONUMENT BOX FOUND
 [Symbol] (ALUM. CAP W/ CONC. MON)
 [Symbol] RAILROAD SPIKE FOUND
 [Symbol] RR SPIKE FND.

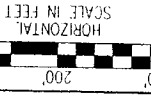

R/W DESIGNER
 VPH
 R/W REVIEWER
 SILL

CENTERLINE PLAT

JAC - 135 - 5.61
GROVE CITY ROAD

1A/4
 18A
 21

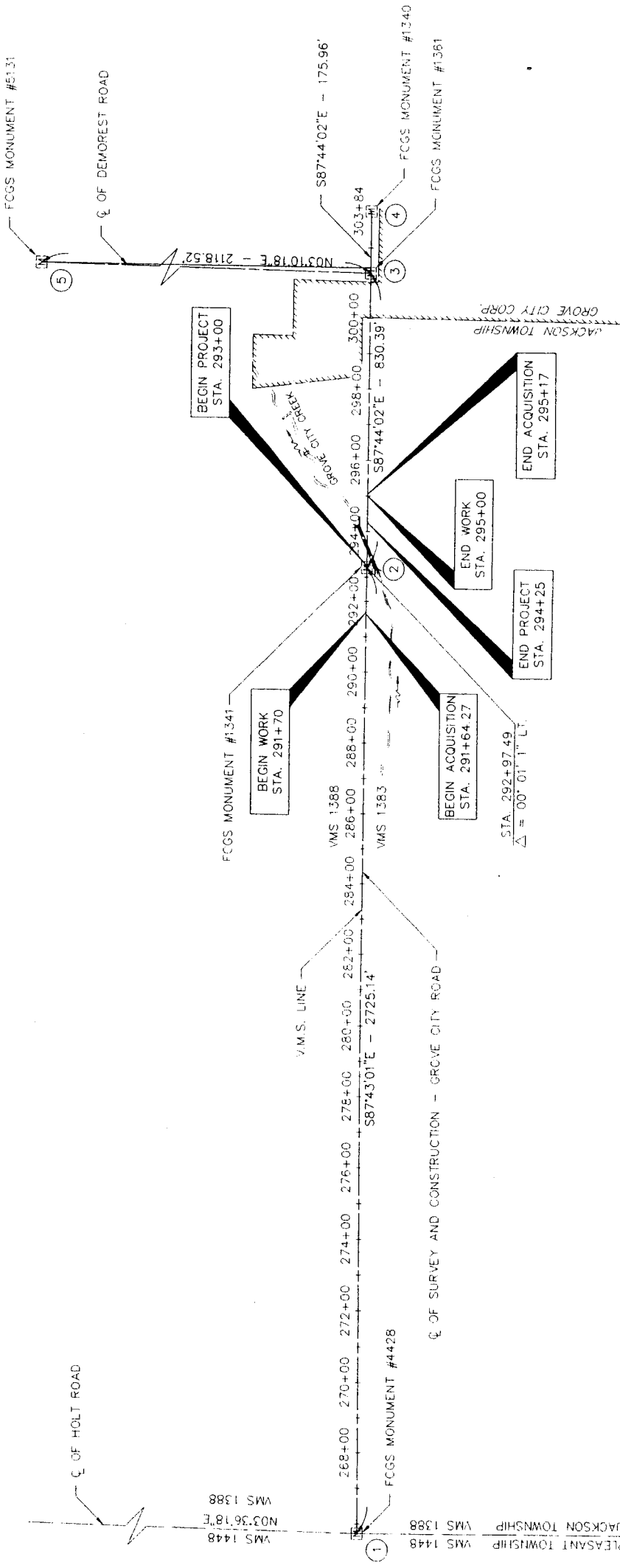

#	STATION	DESCRIPTION	OFFSET
1	265+72.35	FCGS 4428 INT. HOLT & GROVE CITY ROADS & AT V.M.S. CORNER	ON ϕ
2	292+97.49	FCGS 1341 ANGLE POINT ON ϕ GROVE CITY RD. & V.M.S. LINE	ON ϕ
3	301+27.88	FCGS 1361 INT. OF GROVE CITY & DEMOREST ROADS	ON ϕ
4	303+03.84	FCGS 1340 ANGLE POINT ON ϕ GROVE CITY RD. & V.M.S. LINE	ON ϕ
5		FCGS 5131 ANGLE POINT ON ϕ DEMOREST RD. & V.M.S. LINE	2118.26' LT OF ϕ OF STA. 301+61.36 SURVEY & CONSTR. OF GROVE CITY ROAD

STATION	DESCRIPTION	OFFSET
283+54.29	STONE	539.92' LEFT
285+27.09	STONE	1587.11' RT
291+44.07	IRON PIN	1584.27' RT
292+73.76	PIPE	1817.73' RT
292+93.80	IRON PIN	249.40' RT
292+99.82	IRON PIN	249.49' RT
293+84.18	IRON PIN	1818.56' RT
294+07.90	PIPE	25.90' RT
294+96.40	IRON PIN	338.78' LT
294+99.21	PIPE	532.67' LT
295+03.17	PIPE	1819.89' RT
295+23.88	IRON PIN	251.52' RT
295+26.85	PIPE	26.69' RT
297+96.30	IRON PIN	337.00' LT
299+30.00	IRON PIN	581.10' RT
299+35.30	IRON PIN	28.91' RT
299+35.46	IRON PIN	25.67' RT
299+48.88	IRON PIN	336.14' LT
300+02.17	RR SPIKE	0.30' RT
300+98.72	IRON PIPE	25.50' RT

BASIS OF BEARINGS:
 BEARINGS SHOWN HEREIN ARE BASED ON THE BEARING (S87°43'41"E) AS SHOWN ALONG THE CENTERLINE OF GROVE CITY ROAD, AND ARE BASED ON THE OHIO STATE PLANE COORDINATE SYSTEM AND NORTH AMERICAN DATUM OF 1983. (1986), AS ESTABLISHED FROM A GPS SURVEY PERFORMED BY THE FRANKLIN COUNTY ENGINEER'S SURVEY DEPARTMENT IN 2001. OCCUPYING MONUMENTS "FCGS 5131", "FCGS 7735".

I HEREBY CERTIFY THAT THIS PLAT WAS PREPARED IN THE OFFICE OF THE FRANKLIN COUNTY ENGINEER BY DAVID L. PEARSON, P.S., OHIO REGISTERED SURVEYOR NO. 7298 AND IS BASED ON RECORD INFORMATION STATED HEREIN AND A FIELD SURVEY PERFORMED FOR THE FRANKLIN COUNTY ENGINEER'S OFFICE BY COLUMBUS ENGINEERING CONSULTANTS, INC. UNDER THE DIRECTION AND SUPERVISION OF VINCENT PAUL HUGHES, REGISTERED SURVEYOR NO. 7608, IN JULY 2002.

NOTE:
 THE EXISTING RIGHT OF WAY LOCATION AND WIDTH WAS OBTAINED FROM THE OFFICE OF THE FRANKLIN COUNTY ENGINEER, AND IS BASED, IN PART, ON THE PHYSICAL LOCATION OF THE FOUND CENTERLINE MONUMENTS.



David L. Pearson
 DAVID L. PEARSON, P.S. No. 7298
 Date 01/19/2008

THE LOCATION OF UNDERGROUND UTILITIES SHOWN ON THE PLANS ARE AS OBTAINED FROM THE OWNERS OF THE UTILITY AS REQUIRED BY SECTION 153.64 O.R.C.

UTILITY	UTILITY OWNER
ELECTRIC	AMERICAN ELECTRIC POWER 850 TECH CENTER DRIVE COLUMBUS, OHIO 43230-6605 (614) 863-7833
TELEPHONE	AMERITECH 150 EAST GAY STREET, ROOM 7A COLUMBUS, OHIO 43215 (614) 223-4784
GAS	COLUMBIA GAS OF OHIO, INC. 1600 DUBLIN ROAD COLUMBUS, OHIO 43215 (614) 460-2172
CABLE	TIME WARNER CABLE 1266 DUBLIN ROAD COLUMBUS, OHIO 43215 (614) 481-5420
WATER	CITY OF COLUMBUS, DIVISION OF WATER 310 DUBLIN ROAD COLUMBUS, OHIO 43215 (614) 645-7788

UNDERGROUND UTILITIES
WORKING DAYS
BEFORE YOU DIG
 CALL TOLL FREE 800-362-2764
 OHIO UTILITIES PROTECTION SERVICE

JAC - 135 - 5.61
GROVE CITY ROAD
FRANKLIN COUNTY, OHIO
JACKSON TOWNSHIP
V.M.S. 1383 AND V.M.S. 1388

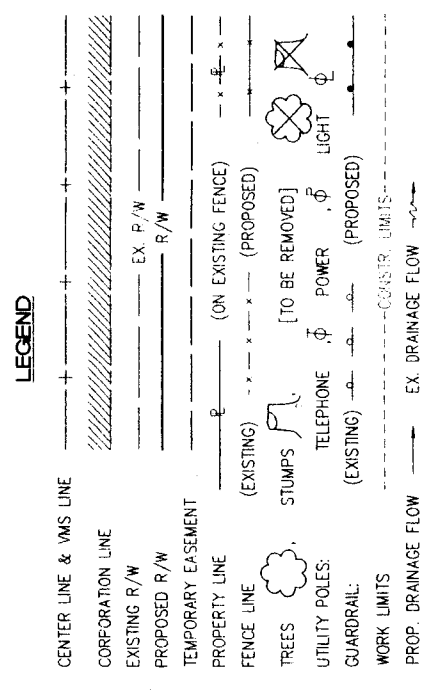
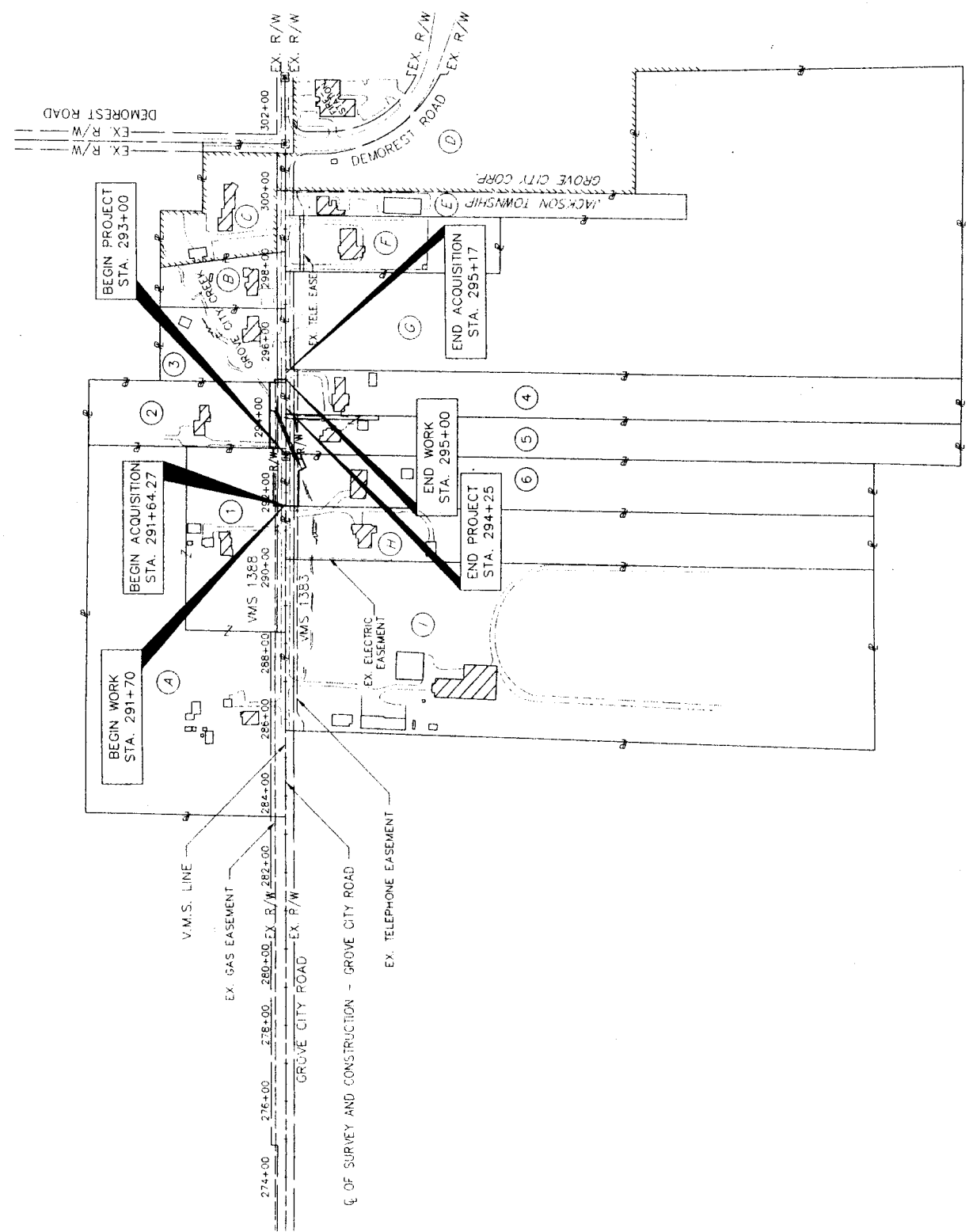

NOTE:
 THE ACREAGES SHOWN ARE ASSESSED ACREAGES, OBTAINED FROM THE FRANKLIN COUNTY AUDITOR'S OFFICE

- UTILITY EASEMENTS**
 (PROPERTY OWNERS SHOWN IN PARENTHESES)
- OHIO BELL TELEPHONE: O.R.V. 14599, PG. A01 (6); O.R.V. 14599, PG. A04 (5); O.R.V. 14599, PG. A08 (4); O.R.V. 14599, PG. A10 (F); O.R.V. 14599, PG. A12 (E); O.R.V. 14599, PG. A13 (H); O.R.V. 14702, PG. D10 (I)
 - COLUMBUS SOUTHERN POWER: O.R.V. 14544, PG. C09 (I); O.R.V. 14594, PG. I08 (H)
 - COLUMBIA GAS OF OHIO: VOL. 2668, PG. 291 (1, 2, A)

- STRUCTURE KEY:**
- RESIDENCE OR (HOUSE TRAILER)
 - BARN, GARAGE, MILL OR OUT BUILDING

- PROPERTY OWNERS**
- MAX K. GIBBONEY AND MARILYN E. GIBBONEY
PARCEL# 160-001084
3 ACRES
 - MARCELLA R. HICKMAN, TR.
PARCEL# 160-001086
2.133 ACRES
 - JOSEPH PAUL PICKENS AND ROBIN BILTZ PICKENS
PARCEL# 160-001109
1.502 ACRES
 - THOMAS E. SEFCHICK AND CHERYL A. SEFCHICK
PARCEL# 160-002536
4.9665 ACRES
 - RANDY SEFCHICK
PARCEL# 160-001318
3.6227 ACRES
 - KENT S. ANSLINGER AND KAREN R. ANSLINGER
PARCEL# 160-001072
5.006 ACRES
- ADJACENT PROPERTY OWNERS**
- MARILYN I. GIBBONEY AND MAX KENNETH GIBBONEY
PARCEL# 160-000116
8.555 ACRES
 - JAMES LOUIS BURDETTE AND CAROL L. BURDETTE
PARCEL# 160-000474
0.988 ACRE
 - MARTHA J. ADAMS
PARCEL# 040-008769
1.932 ACRES
 - JACKSON TOWNSHIP, FRANKLIN COUNTY, OHIO
PARCEL# 040-008213
5.560 ACRES
 - CLOYCE CARTER AND ELLEN CARTER
PARCEL# 160-001321
1.435 ACRES
 - GROVE CITY OHIO CONGREGATION OF JEHOVAH'S WITNESSES
PARCEL# 160-000896
2.0 ACRES
 - GROVE CITY CEMETERY ASSOCIATION
PARCEL# 160-002680
23.288 ACRES
 - HARRY E. LEONARD, TRUSTEE
PARCEL# 160-002830
5.1818 ACRES
 - WILLIAM C. McDONALD AND BETTY J. McDONALD REVOCABLE LIVING TRUST
PARCEL# 160-001075
16.829 ACRES

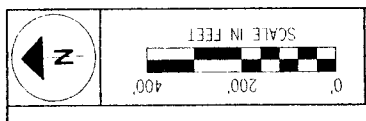

R/W DESIGNER	SIL
VPH	
R/W REVIEWER	

PROPERTY MAP

JAC - 135 - 5.61
 GROVE CITY ROAD

2	4
19	21

JAC - 135 - 5.61
 GROVE CITY ROAD
 FRANKLIN COUNTY, OHIO
 JACKSON TOWNSHIP
 V.M.S. 1383 AND V.M.S. 1388

SUMMARY OF ADDITIONAL RIGHT OF WAY

NET RESIDUE = RECORD AREA - TOTAL P.R.O. - NET TAKE

PARCEL	OWNER (S)	SHEET NUMBER	AUDITOR'S PARCEL #	OWNERS RECORD BOOK	OWNERS RECORD PAGE	RECORD AREA *	TOTAL P.R.O.	GROSS TAKE	P.R.O. IN TAKE	TO BE ACQUIRED		TYPE FUND	REMARKS AND PERSONALTY	AS ACQUIRED	
										NET TAKE	STRUCTURE			NET RESIDUE LEFT	RIGHT
1-WD	MAX K. GIBBONEY AND MARILYN E. GIBBONEY	4	160-001084	D.B. 1803	179	3.000	0.252	0.120	0.079	0.041			FOR DITCH, STORM PIPE MAINTENANCE AND STUMP REMOVAL FOR SLOPE GRADING		
1-T	MAX K. GIBBONEY AND MARILYN E. GIBBONEY							0.011		0.011					
2-WD	MARCELLA R. HICKMAN, TR	4	160-001086	IN. 2004032606086		2.133	0.090	0.176	0.090	0.086			FOR DITCH, STRUCTURE MAINTENANCE AND TREE STUMP REMOVAL FOR RECONSTRUCTING DRIVEWAY, CULVERT REPLACEMENT, AND FOR SLOPE GRADING		
2-T	MARCELLA R. HICKMAN, TR							0.012		0.012					
3-WD	JOSEPH PAUL PICKENS AND ROBIN BILTZ PICKENS	4	160-001109	O.R. 25827	A04	1.502	0.101	0.036	0.004	0.002			FOR GUARDRAIL MAINTENANCE FOR SLOPE GRADING		
3-T	JOSEPH PAUL PICKENS AND ROBIN BILTZ PICKENS							0.005		0.005					
4-T	THOMAS E. SEFCHICK AND CHERYL A. SEFCHICK	4	160-002536	O.R. 28464	D03	4.9665		0.054		0.004			FOR SLOPE GRADING		
5-WD	PANDY SEFCHICK	4	160-001318	IN. 200212160322114		3.6227	0.057	0.082	0.057	0.025			FOR DITCH, CATCH BASIN MAINTENANCE AND TREE REMOVAL FOR DRIVEWAY WORK, CULVERT REPLACEMENT, AND FOR SLOPE GRADING		
5-T	PANDY SEFCHICK							0.012		0.012					
6-WD	KENT S. ANSLINGER AND KAREN R. ANSLINGER	4	160-001072	O.R. 24721	D16	5.006	0.069	0.118	0.069	0.050			FOR DITCH, STRUCTURE MAINTENANCE AND TREE REMOVAL FOR CULVERT REPLACEMENT AND SLOPE GRADING		
5-T	KENT S. ANSLINGER AND KAREN R. ANSLINGER							0.011		0.011					
6	GROVE CITY CEMETERY ASSOCIATION	4	160-002680	O.R. 08727	J14	23.288							ADJACENT PROPERTY OWNER - NO ADDITIONAL RIGHT-OF-WAY NEEDED		
H	HARRY E. LEONARD, TRUSTEE	4	160-002830	IN. 200205170124260		5.1818							ADJACENT PROPERTY OWNER - NO ADDITIONAL RIGHT-OF-WAY NEEDED		

COUNTY

NOTES:

- UNLESS SPECIFIED OTHERWISE, AREAS ARE STATED IN ACRES.
- ALL TEMPORARY PARCELS TO BE OF 18 MONTHS DURATION.
- * DENOTES ASSESSED ACREAGE (FRANKLIN COUNTY AUDITOR'S OFFICE)
- O.R. = OFFICIAL RECORD BOOK AND INSTR. = INSTRUMENT NUMBER

NOTE:

UNDER NO CIRCUMSTANCES ARE TEMPORARY EASEMENTS TO BE USED FOR STORAGE OF MATERIAL OR EQUIPMENT BY THE CONTRACTOR UNLESS NOTED OTHERWISE.

JAC - 135 - 5.61
 GROVE CITY ROAD

3 / 4

20
 21

REVISION 10-10-08
 FIELD REVIEW BY: DATE: R/JN
 OWNERSHIP VERIFIED BY: DATE:
 DATE OF COMPLETION:

SUMMARY OF ADDITIONAL RIGHT OF WAY

GRANTEE: ALL RIGHT-OF-WAY ACQUIRED IN THE NAME OF THE
 FRANKLIN COUNTY COMMISSIONERS UNLESS OTHERWISE SHOWN

P.L.D. NO. 22433

R/W DESIGNER
 VPH
 R/W REVIEWER
 SLL

JAC - 135 - 5.01
GROVE CITY ROAD
FRANKLIN COUNTY, OHIO
JACKSON TOWNSHIP
V.M.S. 1383 AND V.M.S. 1388

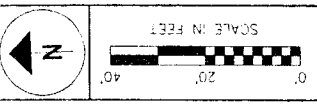

R/W DESIGNER
 VPH
 R/W REVIEWER
 SLL

RIGHT OF WAY PLAN
STA. 290+80 TO STA. 296+40

JAC - 135 - 5.61
GROVE CITY ROAD

4	4
21	21

- MONUMENT LEGEND**
- IRON PIN SET
 - IPS (3/4" I.D. HOLLOW STEEL PIPE, 30" LONG WITH A PLASTIC CAP STAMPED "CEC, INC.")
 - MONUMENT BOX FOUND
 - PIPE FOUND

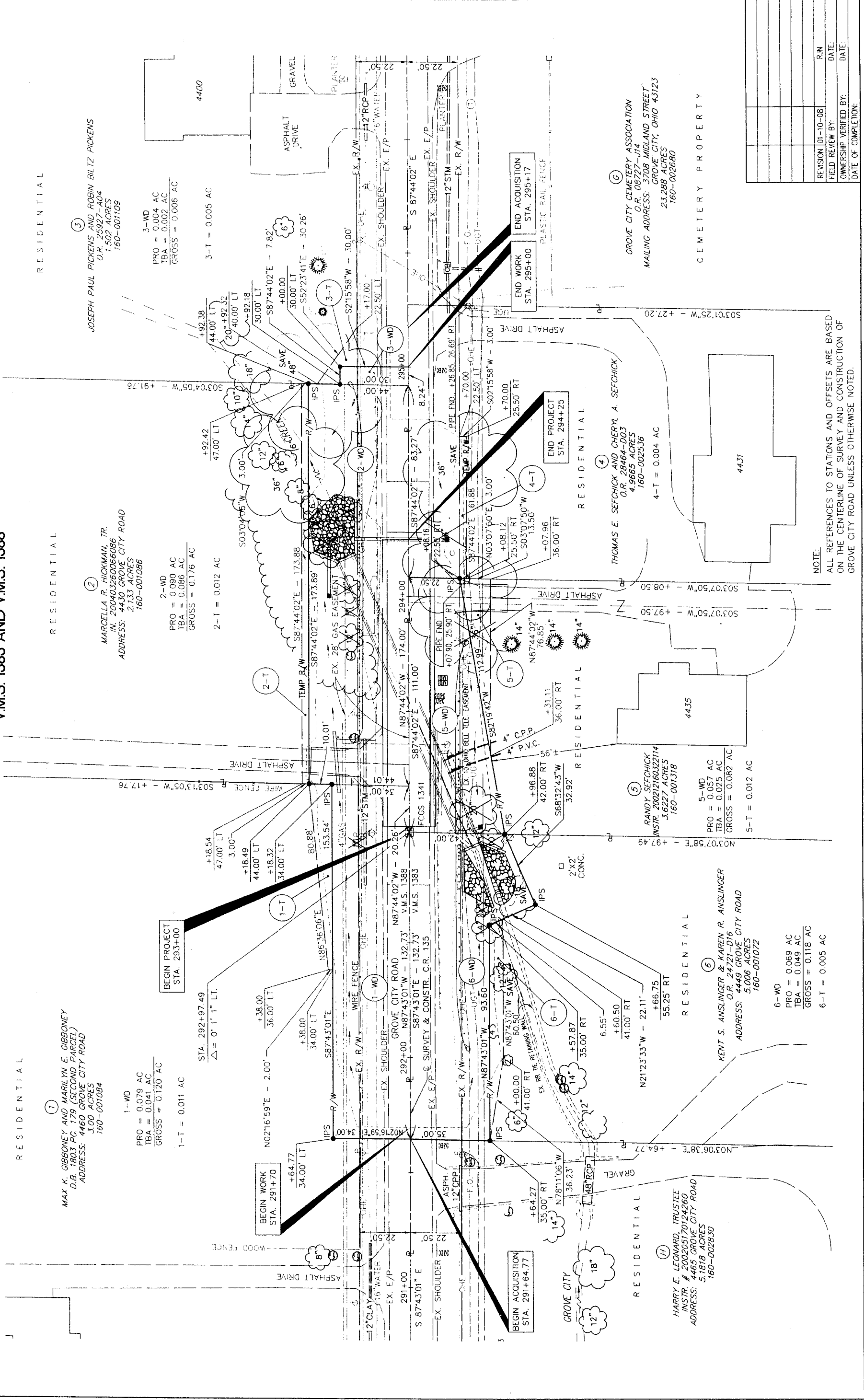

RESIDENTIAL

(1) MAX K. GIBBONEY AND MARILYN E. GIBBONEY
 D.B. 1803 PG. 179 (SECOND PARCEL)
 ADDRESS: 4460 GROVE CITY ROAD
 3.00 ACRES
 160-001084

1-WD
 PRO = 0.079 AC
 TBA = 0.041 AC
 GROSS = 0.120 AC
 1-T = 0.011 AC

(2) MARCELLE R. HICKMAN, JR.
 IN. 20040326066086
 ADDRESS: 4430 GROVE CITY ROAD
 2.133 ACRES
 160-001086

2-WD
 PRO = 0.090 AC
 TBA = 0.086 AC
 GROSS = 0.176 AC
 2-T = 0.012 AC

(3) JOSEPH PAUL PICKENS AND ROBIN BULTZ PICKENS
 O.R. 25927-404
 1.502 ACRES
 160-001109

3-WD
 PRO = 0.004 AC
 TBA = 0.002 AC
 GROSS = 0.006 AC
 3-T = 0.005 AC

(4) THOMAS E. SEFTCHICK AND CHERYL A. SEFTCHICK
 O.R. 28464-5003
 4.9665 ACRES
 160-002536

4-T = 0.004 AC

(5) RANDY SEFTCHICK
 INSTR. 20021260322114
 3.6227 ACRES
 160-001318

5-WD
 PRO = 0.057 AC
 TBA = 0.025 AC
 GROSS = 0.082 AC
 5-T = 0.012 AC

(6) HARRY E. LEONARD, TRUSTEE
 INSTR. # 200205170124260
 ADDRESS: 4465 GROVE CITY ROAD
 5.1818 ACRES
 160-002830

6-WD
 PRO = 0.069 AC
 TBA = 0.049 AC
 GROSS = 0.118 AC
 6-T = 0.005 AC

(7) KENT S. ANSLINGER & KAREN R. ANSLINGER
 O.R. 24221-D16
 ADDRESS: 4449 GROVE CITY ROAD
 5.006 ACRES
 160-001072

6-WD
 PRO = 0.069 AC
 TBA = 0.049 AC
 GROSS = 0.118 AC
 6-T = 0.005 AC

NOTE:
 ALL REFERENCES TO STATIONS AND OFFSETS ARE BASED
 ON THE CENTERLINE OF SURVEY AND CONSTRUCTION OF
 GROVE CITY ROAD UNLESS OTHERWISE NOTED.