March 15, 1995

Honorable Board of County Commissioners
Franklin County Administration Building
373 South High Street
Columbus, Ohio 43215

Honorable Board:

I have reviewed the petition from the Columbus and Franklin County Metropolitan Park Board, for the vacation of a portion of Bowen Road, Madison Township, Franklin County, Ohio, and find that the petition is valid.

Respectfully submitted,

John Circle, P.E., P.S.
Franklin County Engineer

JC:JG:cmc

RESOLUTION NO. 277-95

March 21, 1995

PETITION FILED FOR VACATION OF A
PORTION OF BOWEN ROAD, MADISON
TOWNSHIP, FRANKLIN COUNTY OHIO -
VIEW - APRIL 11, 1995 AT 10:00 A.M.,
HEARING APRIL 18, 1995
(FRANKLIN COUNTY ENGINEER)

WHEREAS, the Columbus and Franklin County Metropolitan Park Board filed a petition with the Board of County Commissioners, Franklin County, Ohio, requesting said Board to vacate a portion of Bowen Road, Madison Township, Franklin County, Ohio, the general route and termini thereof, to be as follows:

AREA ONE

Beginning at a point 40 feet left of centerline of survey Station 29+28.37 of Relocated Bowen Road (plans on file with Franklin County Engineer, Columbus, Ohio), said point being a point of intersection of Relocated Bowen Road right of way and existing Bowen Road right of way;

Thence leaving relocated Bowen Road right of way and along existing Bowen Road right of way with a curve to the left of radius 793.51 feet, which chord bears N 83°52'57"W a distance of 182.53 feet, an arc length of 182.93 feet, with a central angle of 13°12'31" to a point;

Thence continuing with existing Bowen Road right of way S 89°30'47"W a distance of 119.29 feet to a point;

Thence continuing with existing Bowen Road right of way with a curve to the right of radius 125.00 feet, which chord bears N 72°05'41"W a distance of 78.88 feet, an arc length of 80.25 feet, with a central angle of 36°47'04" to a point;

Thence leaving existing Bowen Road right of way N 89°51'53"E a distance of 5.14 feet to a point;

Thence N 49°56'30"E a distance of 50.08 feet to a point on existing Bowen Road right of way;

Thence continuing with existing Bowen Road right of way with a curve to the left of radius 75.00 feet, which chord bears S 78°14'00"E a distance of 31.84 feet, an arc length of 32.08 feet, with a central angle of 24°30'25" to a point;

Thence continuing with existing Bowen Road right of way N 89°30'47"E a distance of 119.29 feet to a point;

Thence continuing with existing Bowen Road right of way with a curve to the right of radius 843.51 feet, which chord bears S 89°27'56"E a distance of 30.07 feet, an arc length of 30.07 feet, with a central angle of 2°2'34" to a point of intersection of existing Bowen Road right of way and relocated Bowen Road right of way;

Thence leaving existing Bowen Road right of way and along relocated Bowen Road right of way with a curve to the left of radius 421.97 feet, which chord bears S 63°29'19"E a distance of 38.75 feet, an arc length of 38.76 feet, with a central angle of 5°15'48" to a point;

Thence continuing with relocated Bowen Road right of way S 66°07'13"E a distance of 128.14 feet to the true point of beginning and containing 0.139 acres, more or less, from Auditor's Parcel No. 540-126860, 0.013 acres, more or less, from Auditor's parcel No. 540-191237, 0.010 acres, more or less, from Auditor's parcel No. 540-192142, and 0.148 acres, more or less, from Auditor's Parcel No. 540-203801, being in all 0.310 acres, more or less.

This description is based on centerline of surveying bearing as established relative to the grid bearing of Franklin County Geologic Survey Monuments 9932 and 9968 as placed in Bowen Road, said grid bearing being N 4°14'32"E.

AREA TWO

Beginning at a point 40 feet left of centerline of survey Station 35+56.19 of relocated Bowen Road (plans on file with Franklin County Engineer, Columbus, Ohio), said point being a point of intersection of relocated Bowen Road right of way and existing Bowen Road right of way;

Thence leaving relocated Bowen Road right of way and along existing Bowen Road right of way S 4°35'26"E a distance of 333.57 feet to a point;

Thence continuing along existing Bowen Road right of way with a curve to the left of radius 75.00 feet, which chord bears S 23°23'19"E a distance of 48.34 feet, an arc length of 49.21 feet, with a central angle of 37°35'37" to a point;

Thence leaving existing Bowen Road right of way S 49°56'30"W a distance of 49.82 feet to a point;

Thence S 4°35'26"E a distance of 0.34 feet to a point on existing Bowen Road right of way;

Thence along existing Bowen Road right of way with a curve to the right of radius 125.00 feet, which chord bears N 23°01'31"W a distance of 79.06 feet, an arc length of 80.44 feet, with a central angle of 36°52'12" to a point;

Thence continuing along existing Bowen Road right of way N 4°35'26"W a distance of 416.15 feet to a point of intersection of existing Bowen Road right of way and relocated Bowen Road right of way;

Thence along relocated Bowen Road right of way with a curve to the right of radius 341.97 feet, which chord bears S 35°47'10"E a distance of 96.53 feet, an arc length of 96.86 feet, with a central angle of 16°13'40" to the true point of beginning and containing 0.001 acres, more or less, from Auditor's parcel No. 183-9, 0.258 acres, more or less, from Auditor's parcel No. 183-13, and 0.251 acres, more or less, from Auditor's Parcel No. 540-126860, being in all 0.510 acres, more or less.

This description is based on centerline of survey bearing as established relative to the grid bearing of Franklin County Geologic Survey Monuments 9932 and 9968 as placed in Bowen Road, said grid bearing being N4°14'32"E.

AREA THREE

Beginning at a point 40 feet right of centerline of survey Station 37+47.11 of relocated Bowen Road (plans on file with Franklin County Engineer, Columbus, Ohio), said point being a point of intersection of relocated Bowen Road right of way and existing Bowen Road right of way;

Thence leaving relocated Bowen Road right of way and along existing Bowen Road right of way with a curve to the left of radius 75.00 feet, which chord bears N 53°32'24"W a distance of 79.98 feet, an arc length of 84.36 feet, with a central angle of 64°26'49" to a point;

Thence continuing along existing Bowen Road right of way N 85°45'49"W a distance of 15.32 feet to a point of intersection of existing Bowen Road right of way and relocated Bowen Road right of way;

Thence along relocated Bowen Road right of way N 58°48'41"W a distance of 110.32 feet to a point;

Thence leaving relocated Bowen Road right of way and along existing Bowen Road right of way S 85°45'49"E a distance of 113.66 feet to a point;

Thence continuing along existing Bowen Road right of way with a curve to the right of radius 125.00 feet, which chord bears S 62°25'37"E a distance of 99.03 feet, an arc length of 101.83 feet, with a central angle of 46°40'24", to a point of intersection of existing Bowen Road right of way and relocated Bowen Road drainage easement (plans on file with Franklin County Engineer, Columbus, Ohio);

Thence leaving existing Bowen Road right of way and along said drainage easement S 4°26'05"E a distance of 76.22 feet to a point of intersection of relocated Bowen Road right of way and said drainage easement;

VACATION OF A PORTION OF BOWEN ROAD, MADISON TOWNSHIP, FRANKLIN COUNTY, OHIO

Thence along Relocated Bowen Road right of way with a curve to the left of radius 421.97 feet, which chord bears N 53°31'04"W a distance of 41.10 feet, an arc length of 41.11 feet, with a central angle of 5°34'57", to the true point of beginning and containing 0.080 acres, more or less, from Auditor's parcel No. 183-7, 0.122 acres, more or less, from Auditor's Parcel No. 183-9, and 0.005 acres, more or less, from Auditor's Parcel No. 540-126860, being in all 0.207 acres, more or less.

This description is based on centerline of survey bearing as established relative to the grid bearing of Franklin County Geologic Survey Monuments 9932 and 9968 as placed in Bowen Road, said grid bearing being N 4°14'32"E.

AREA FOUR

Beginning at a point 40.00 feet right of centerline of survey Station 40+58.34 of relocated Bowen Road (plans on file with Franklin County Engineer, Columbus, Ohio) said point being a point of intersection of relocated Bowen Road right of way and existing Bowen Road right of way;

Thence along relocated Bowen Road right of way N 58°48'41"W a distance of 61.21 feet to a point;

Thence leaving relocated Bowen Road right of way and along existing Bowen Road right of way N 2°38'25" E a distance of 1466.72 feet to a point of intersection of existing Bowen Road right of way and existing Wright Road right of way;

Thence along existing Wright Road right of way S 86°24'19" E a distance of 50.01 feet to a point;

Thence leaving existing Wright Road right of way and along existing Bowen Road right of way S 2°38'25" W a distance of 1471.68 feet to a point;

Thence continuing along existing Bowen Road right of way with a curve to the left of radius 75.00 feet, which chord bears S 6°28'27" E a distance of 23.76 feet, an arc length of 23.86 feet, with a central angle of 18°13'44" to the true point of beginning and containing 0.854 acres, more or less, from Auditor's Parcel No. 183-7, 0.274 acres, more or less, from Auditor's Parcel No. 540-126702, and 0.571 acres, more or less, from Auditor's Parcel No. 540-192143, being in all 1.699 acres, more or less.

This description is based on centerline of survey bearing as established relative to the grid bearing of Franklin County Geologic Survey Monuments 9932 and 9968 as placed in Bowen Road, said grid bearing being N 4°14'32"E.

AREA FIVE

Beginning at a point 40.00 feet right of centerline of survey Station 36+80.95 of relocated Bowen Road (plans on file with Franklin County Engineer, Columbus, Ohio), said point being a point of intersection of relocated Bowen Road right of way and existing Bowen Road right of way;

Thence leaving existing Bowen Road right of way and along relocated Bowen Road right of way with a curve to the left of radius 421.97 feet, which chord bears N 46°36'47"W a distance of 3.36 feet, an arc length of 3.36 feet, with a central angle of 0°27'21" to a point of intersection of relocated Bowen Road right of way and relocated Bowen Road right of way and relocated Bowen Road drainage easement (plans on file with Franklin County Engineer, Columbus, Ohio);

Thence along said drainage easement N 4°26'05" W a distance of 48.82 feet to a point of intersection of said drainage easement and existing Bowen Road right of way;

Thence leaving said drainage easement and along existing Bowen Road right of way with a curve to the right of radius 125.00 feet, which chord bears S 9°52'01" E a distance of 22.99 feet, an arc length of 23.02 feet, with a central angle of 10°33'10" to a point;

Thence continuing along existing Bowen Road right of way S 4°35'26" E a distance of 28.42 feet to the true point of beginning and continuing 0.002 acres, more or less, from Auditor's Parcel No. 540-126860.

This description is based on centerline of survey bearing as established relative to the grid bearing of Franklin County Geologic Survey 9932 and 9968 as placed in Bowen Road, said grid bearing being N 4°14'32"E; now, therefore, upon motion of Commissioner Stokes, seconded by Commissioner Teater,

BE IT RESOLVED, BY THE BOARD OF COUNTY COMMISSIONERS OF FRANKLIN COUNTY, OHIO:

Section 1) That April 11, 1995 at 10:00 a.m., is hereby fixed as the date and hour when the Board of County Commissioners will view the proposed vacation along the general route thereof and April 18, 1995 is hereby fixed as the time and date for the final hearing of said petition and proposed vacation in the office of the Board of County Commissioners, at the Franklin County Administration Building, 373 South High Street, Columbus, Ohio 43215.

Section 2) That notice of the time and place for both such view and hearing will be given by publication once a week for two consecutive weeks in a newspaper published in and having a general circulation in Franklin County, Ohio, where the proposed vacation is located, and that said notice in addition to the date and place of such view and place and time of the final hearing, shall state briefly the character of the proposed vacation.

Voting Aye thereon: Dorothy S. Teater and Dewey R. Stokes.

**NOTICE OF INTENTION TO VACATE
A PORTION OF BOWEN ROAD,
MADISON TOWNSHIP, FRANKLIN COUNTY, OHIO**

NOTICE is hereby given that it is the intention of the Board of County Commissioners of Franklin County, Ohio, to vacate a portion of Bowen Road, Madison Township, Franklin County, Ohio the said roadway being more particularly described as follows:

AREA ONE

Beginning at a point 40 feet left of centerline of survey Station 29+28.37 of Relocated Bowen Road (plans on file with Franklin County Engineer, Columbus, Ohio), said point being a point of intersection of Relocated Bowen Road right of way and existing Bowen Road right of way;

Thence leaving relocated Bowen Road right of way and along existing Bowen Road right of way with a curve to the left of radius 793.51 feet, which chord bears N 83°52'57"W a distance of 182.53 feet, an arc length of 182.93 feet, with a central angle of 13°12'31" to a point;

Thence continuing with existing Bowen Road right of way S 89°30'47"W a distance of 119.29 feet to a point;

Thence continuing with existing Bowen Road right of way with a curve to the right of radius 125.00 feet, which chord bears N 72°05'41"W a distance of 78.88 feet, an arc length of 80.25 feet, with a central angle of 36°47'04" to a point;

Thence leaving existing Bowen Road right of way N 89°51'53"E a distance of 5.14 feet to a point;

Thence N 49°56'30"E a distance of 50.08 feet to a point on existing Bowen Road right of way;

Thence continuing with existing Bowen Road right of way with a curve to the left of radius 75.00 feet, which chord bears S 78°14'00"E a distance of 31.84 feet, an arc length of 32.08 feet, with a central angle of 24°30'25" to a point;

Thence continuing with existing Bowen Road right of way N 89°30'47"E a distance of 119.29 feet to a point;

Thence continuing with existing Bowen Road right of way with a curve to the right of radius 843.51 feet, which chord bears S 89°27'56"E a distance of 30.07 feet, an arc length of 30.07 feet, with a central angle of 2°2'34" to a point of intersection of existing Bowen Road right of way and relocated Bowen Road right of way;

Thence leaving existing Bowen Road right of way and along relocated Bowen Road right of way with a curve to the left of radius 421.97 feet, which chord bears S 63°29'19"E a distance of 38.75 feet, an arc length of 38.76 feet, with a central angle of 5°15'48" to a point;

Thence continuing with relocated Bowen Road right of way S 66°07'13"E a distance of 128.14 feet to the true point of beginning and containing 0.139 acres, more or less, from Auditor's Parcel No. 540-126860, 0.013 acres, more or less, from Auditor's parcel No. 540-191237, 0.010 acres, more or less, from Auditor's parcel No. 540-192142, and 0.148 acres, more or less, from Auditor's Parcel No. 540-203801, being in all 0.310 acres, more or less.

This description is based on centerline of surveying bearing as established relative to the grid bearing of Franklin County Geologic Survey Monuments 9932 and 9968 as placed in Bowen Road, said grid bearing being N 4°14'32"E.

AREA TWO

Beginning at a point 40 feet left of centerline of survey Station 35+56.19 of relocated Bowen Road (plans on file with Franklin County Engineer, Columbus, Ohio), said point being a point of intersection of relocated Bowen Road right of way and existing Bowen Road right of way;

Thence leaving relocated Bowen Road right of way and along existing Bowen Road right of way S 4°35'26"E a distance of 333.57 feet to a point;

Thence continuing along existing Bowen Road right of way with a curve to the left of radius 75.00 feet, which chord bears S 23°23'19"E a distance of 48.34 feet, an arc length of 49.21 feet, with a central angle of 37°35'37" to a point;

Thence leaving existing Bowen Road right of way S 49°56'30"W a distance of 49.82 feet to a point;

Thence S 4°35'26"E a distance of 0.34 feet to a point on existing Bowen Road right of way;

Thence along existing Bowen Road right of way with a curve to the right of radius 125.00 feet, which chord bears N 23°01'31"W a distance of 79.06 feet, an arc length of 80.44 feet, with a central angle of 36°52'12" to a point;

VACATION OF A PORTION OF BOWEN ROAD, MADISON TOWNSHIP, FRANKLIN COUNTY, OHIO

Thence continuing along existing Bowen Road right of way N 4°35'26"W a distance of 416.15 feet to a point of intersection of existing Bowen Road right of way and relocated Bowen Road right of way;

Thence along relocated Bowen Road right of way with a curve to the right of radius 341.97 feet, which chord bears S 35°47'10"E a distance of 96.53 feet, an arc length of 96.86 feet, with a central angle of 16°13'40" to the true point of beginning and containing 0.001 acres, more or less, from Auditor's parcel No. 183-9, 0.258 acres, more or less, from Auditor's parcel No. 183-13, and 0.251 acres, more or less, from Auditor's Parcel No. 540-126860, being in all 0.510 acres, more or less.

This description is based on centerline of survey bearing as established relative to the grid bearing of Franklin County Geologic Survey Monuments 9932 and 9968 as placed in Bowen Road, said grid bearing being N4°14'32"E.

AREA THREE

Beginning at a point 40 feet right of centerline of survey Station 37+47.11 of relocated Bowen Road (plans on file with Franklin County Engineer, Columbus, Ohio), said point being a point of intersection of relocated Bowen Road right of way and existing Bowen Road right of way;

Thence leaving relocated Bowen Road right of way and along existing Bowen Road right of way with a curve to the left of radius 75.00 feet, which chord bears N 53°32'24"W a distance of 79.98 feet, an arc length of 84.36 feet, with a central angle of 64°26'49" to a point;

Thence continuing along existing Bowen Road right of way N 85°45'49"W a distance of 15.32 feet to a point of intersection of existing Bowen Road right of way and relocated Bowen Road right of way;

Thence along relocated Bowen Road right of way N 58°48'41"W a distance of 110.32 feet to a point;

Thence leaving relocated Bowen Road right of way and along existing Bowen Road right of way S 85°45'49"E a distance of 113.66 feet to a point;

Thence continuing along existing Bowen Road right of way with a curve to the right of radius 125.00 feet, which chord bears S 62°25'37"E a distance of 99.03 feet, an arc length of 101.83 feet, with a central angle of 46°40'24", to a point of intersection of existing Bowen Road right of way and relocated Bowen Road drainage easement (plans on file with Franklin County Engineer, Columbus, Ohio);

Thence leaving existing Bowen Road right of way and along said drainage easement S 4°26'05"E a distance of 76.22 feet to a point of intersection of relocated Bowen Road right of way and said drainage easement;

Thence along Relocated Bowen Road right of way with a curve to the left of radius 421.97 feet, which chord bears N 53°31'04"W a distance of 41.10 feet, an arc length of 41.11 feet, with a central angle of 5°34'57", to the true point of beginning and containing 0.080 acres, more or less, from Auditor's parcel No. 183-7, 0.122 acres, more or less, from Auditor's Parcel No. 183-9, and 0.005 acres, more or less, from Auditor's Parcel No. 540-126860, being in all 0.207 acres, more or less.

This description is based on centerline of survey bearing as established relative to the grid bearing of Franklin County Geologic Survey Monuments 9932 and 9968 as placed in Bowen Road, said grid bearing being N 4°14'32"E.

AREA FOUR

Beginning at a point 40.00 feet right of centerline of survey Station 40+58.34 of relocated Bowen Road (plans on file with Franklin County Engineer, Columbus, Ohio) said point being a point of intersection of relocated Bowen Road right of way and existing Bowen Road right of way;

Thence along relocated Bowen Road right of way N 58°48'41"W a distance of 61.21 feet to a point;

Thence leaving relocated Bowen Road right of way and along existing Bowen Road right of way N 2°38'25" E a distance of 1466.72 feet to a point of intersection of existing Bowen Road right of way and existing Wright Road right of way;

Thence along existing Wright Road right of way S 86°24'19" E a distance of 50.01 feet to a point;

Thence leaving existing Wright Road right of way and along existing Bowen Road right of way S 2°38'25" W a distance of 1471.68 feet to a point;

Thence continuing along existing Bowen Road right of way with a curve to the left of radius 75.00 feet, which chord bears S 6°28'27" E a distance of 23.76 feet, an arc length of 23.86 feet, with a central angle of 18°13'44" to the true point of beginning and containing 0.854 acres, more or less, from Auditor's Parcel No. 183-7, 0.274 acres, more or less, from Auditor's Parcel No. 540-126702, and 0.571 acres, more or less, from Auditor's Parcel No. 540-192143, being in all 1.699 acres, more or less.

This description is based on centerline of survey bearing as established relative to the grid bearing of Franklin County Geologic Survey Monuments 9932 and 9968 as placed in Bowen Road, said grid bearing being N 4°14'32"E.

AREA FIVE

Beginning at a point 40.00 feet right of centerline of survey Station 36+80.95 of relocated Bowen Road (plans on file with Franklin County Engineer, Columbus, Ohio), said point being a point of intersection of relocated Bowen Road right of way and existing Bowen Road right of way;

Thence leaving existing Bowen Road right of way and along relocated Bowen Road right of way with a curve to the left of radius 421.97 feet, which chord bears N 46°36'47"W a distance of 3.36 feet, an arc length of 3.36 feet, with a central angle of 0°27'21" to a point of intersection of relocated Bowen Road right of way and relocated Bowen Road right of way and relocated Bowen Road drainage easement (plans on file with Franklin County Engineer, Columbus, Ohio);

Thence along said drainage easement N 4°26'05" W a distance of 48.82 feet to a point of intersection of said drainage easement and existing Bowen Road right of way;

Thence leaving said drainage easement and along existing Bowen Road right of way with a curve to the right of radius 125.00 feet, which chord bears S 9°52'01" E a distance of 22.99 feet, an arc length of 23.02 feet, with a central angle of 10°33'10" to a point;

Thence continuing along existing Bowen Road right of way S 4°35'26" E a distance of 28.42 feet to the true point of beginning and continuing 0.002 acres, more or less, from Auditor's Parcel No. 540-126860.

This description is based on centerline of survey bearing as established relative to the grid bearing of Franklin County Geologic Survey 9932 and 9968 as placed in Bowen Road, said grid bearing being N 4°14'32"E;

NOTICE is hereby given that April 11, 1995 at 10:00 a.m. at the place of said proposed vacation was fixed as the time and place for viewing thereof and April 18, 1995 at 9:15 a.m. at the Office of the Board of County Commissioners was fixed as the time and place for final hearing thereon.

By order of the Board of County Commissioners of Franklin County, Ohio.

Sharon Y. Bice, Clerk
Board of County Commissioners

PUBLISHED - Tuesday, March 28, 1995 and April 4, 1995.

RESOLUTION NO. 354-95

April 11, 1995

VACATION OF A PORTION OF BOWEN ROAD,
MADISON TOWNSHIP, FRANKLIN COUNTY, OHIO
VIEWED - ENGINEER TO FILE REPORT BY
APRIL 18, 1995
(FRANKLIN COUNTY ENGINEER)

WHEREAS, a petition was filed with this Board by the Columbus and Franklin County Metropolitan Park Board, praying for the vacation of a portion of Bowen Road, Madison Township, Franklin County, Ohio; and

WHEREAS, on the 21st day of March, 1995, said Board of County Commissioners did fix the 11th day of April at 10:00 a.m. on the line of said proposed vacation, as the time and place for viewing thereof and did further fix the 18th day of April, 1995 at 9:15 a.m. at the Office of the Board of County Commissioners of Franklin County, Ohio, as the time and place for the final hearing on said vacation; and

WHEREAS, legal notice of the viewing and final hearing was published in a newspaper of general circulation in said County; and

WHEREAS, the Board of County Commissioners of Franklin County, Ohio, did on the 11th day of April, 1995, meet on the line of said proposed vacation, as described in resolution of the 21st of March, 1995, and heard all of the proof offered by parties interested in the affected thereby, does find that the vacation of a portion of Bowen Road, Madison Township, Franklin County, Ohio, is of sufficient importance to require that the Engineer of Franklin County, Ohio, be instructed and directed to make a survey and plat thereof; now, therefore, upon motion of Commissioner Teater, seconded by Commissioner Stokes,

BE IT RESOLVED, BY THE BOARD OF COUNTY COMMISSIONERS OF FRANKLIN COUNTY, OHIO:

Section 1) That the Engineer of Franklin County, Ohio be and hereby is instructed and directed to make a plat and survey of the proposed vacation, an accurate and detailed description of each tract of land which will be necessary to be taken together with the names of each owner, shall set stakes at the termini of each right of way line at all angles between such termini and at such sufficient other points of the right of way lines so that the bounds of the proposed vacation may be discernible to the property owners and on or before the 18th of April, 1995 at 9:15 a.m., said report shall set forth an opinion of the County Engineer either for or against the granting of said vacation, which report together with the plat and survey of the proposed vacation, shall be deposited with the Commissioners.

Voting Aye thereon: Arlene Shoemaker, Dorothy S. Teater and Dewey R. Stokes.

April 12, 1995

Honorable Board of County Commissioners
Franklin County Administration Building
373 South High Street
Columbus, Ohio 43215

Honorable Board:

Pursuant to your order of April 11, 1995, I have made a survey and plat, which I hereby submit for the vacation of a portion of Bowen Road, Madison Township, Franklin County, Ohio, showing the proposed vacation of the following:

AREA ONE

Beginning at a point 40 feet left of centerline of survey Station 29+28.37 of Relocated Bowen Road (plans on file with Franklin County Engineer, Columbus, Ohio), said point being a point of intersection of Relocated Bowen Road right of way and existing Bowen Road right of way;

Thence leaving relocated Bowen Road right of way and along existing Bowen Road right of way with a curve to the left of radius 793.51 feet, which chord bears N 83°52'57"W a distance of 182.53 feet, an arc length of 182.93 feet, with a central angle of 13°12'31" to a point;

Thence continuing with existing Bowen Road right of way S 89°30'47"W a distance of 119.29 feet to a point;

Thence continuing with existing Bowen Road right of way with a curve to the right of radius 125.00 feet, which chord bears N 72°05'41"W a distance of 78.88 feet, an arc length of 80.25 feet, with a central angle of 36°47'04" to a point;

Thence leaving existing Bowen Road right of way N 89°51'53"E a distance of 5.14 feet to a point;

Thence N 49°56'30"E a distance of 50.08 feet to a point on existing Bowen Road right of way;

Thence continuing with existing Bowen Road right of way with a curve to the left of radius 75.00 feet, which chord bears S 78°14'00"E a distance of 31.84 feet, an arc length of 32.08 feet, with a central angle of 24°30'25" to a point;

Thence continuing with existing Bowen Road right of way N 89°30'47"E a distance of 119.29 feet to a point;

Thence continuing with existing Bowen Road right of way with a curve to the right of radius 843.51 feet, which chord bears S 89°27'56"E a distance of 30.07 feet, an arc length of 30.07 feet, with a central angle of 2°2'34" to a point of intersection of existing Bowen Road right of way and relocated Bowen Road right of way;

Thence leaving existing Bowen Road right of way and along relocated Bowen Road right of way with a curve to the left of radius 421.97 feet, which chord bears S 63°29'19"E a distance of 38.75 feet, an arc length of 38.76 feet, with a central angle of 5°15'48" to a point;

Thence continuing with relocated Bowen Road right of way S 66°07'13"E a distance of 128.14 feet to the true point of beginning and containing 0.139 acres, more or less, from Auditor's Parcel No. 540-126860, 0.013 acres, more or less, from Auditor's parcel No. 540-191237, 0.010 acres, more or less, from Auditor's parcel No. 540-192142, and 0.148 acres, more or less, from Auditor's Parcel No. 540-203801, being in all 0.310 acres, more or less.

This description is based on centerline of surveying bearing as established relative to the grid bearing of Franklin County Geologic Survey Monuments 9932 and 9968 as placed in Bowen Road, said grid bearing being N 4°14'32"E.

AREA TWO

Beginning at a point 40 feet left of centerline of survey Station 35+56.19 of relocated Bowen Road (plans on file with Franklin County Engineer, Columbus, Ohio), said point being a point of intersection of relocated Bowen Road right of way and existing Bowen Road right of way;

Thence leaving relocated Bowen Road right of way and along existing Bowen Road right of way S 4°35'26"E a distance of 333.57 feet to a point;

Thence continuing along existing Bowen Road right of way with a curve to the left of radius 75.00 feet, which chord bears S 23°23'19"E a distance of 48.34 feet, an arc length of 49.21 feet, with a central angle of 37°35'37" to a point;

Thence leaving existing Bowen Road right of way S 49°56'30"W a distance of 49.82 feet to a point;

Thence S 4°35'26"E a distance of 0.34 feet to a point on existing Bowen Road right of way;

Thence along existing Bowen Road right of way with a curve to the right of radius 125.00 feet, which chord bears N 23°01'31"W a distance of 79.06 feet, an arc length of 80.44 feet, with a central angle of 36°52'12" to a point;

Thence continuing along existing Bowen Road right of way N 4°35'26"W a distance of 416.15 feet to a point of intersection of existing Bowen Road right of way and relocated Bowen Road right of way;

Thence along relocated Bowen Road right of way with a curve to the right of radius 341.97 feet, which chord bears S 35°47'10"E a distance of 96.53 feet, an arc length of 96.86 feet, with a central angle of 16°13'40" to the true point of beginning and containing 0.001 acres, more or less, from Auditor's parcel No. 183-9, 0.258 acres, more or less, from Auditor's parcel No. 183-13, and 0.251 acres, more or less, from Auditor's Parcel No. 540-126860, being in all 0.510 acres, more or less.

This description is based on centerline of survey bearing as established relative to the grid bearing of Franklin County Geologic Survey Monuments 9932 and 9968 as placed in Bowen Road, said grid bearing being N4°14'32"E.

AREA THREE

Beginning at a point 40 feet right of centerline of survey Station 37+47.11 of relocated Bowen Road (plans on file with Franklin County Engineer, Columbus, Ohio), said point being a point of intersection of relocated Bowen Road right of way and existing Bowen Road right of way;

Thence leaving relocated Bowen Road right of way and along existing Bowen Road right of way with a curve to the left of radius 75.00 feet, which chord bears N 53°32'24"W a distance of 79.98 feet, an arc length of 84.36 feet, with a central angle of 64°26'49" to a point;

Thence continuing along existing Bowen Road right of way N 85°45'49"W a distance of 15.32 feet to a point of intersection of existing Bowen Road right of way and relocated Bowen Road right of way;

Thence along relocated Bowen Road right of way N 58°48'41"W a distance of 110.32 feet to a point;

Thence leaving relocated Bowen Road right of way and along existing Bowen Road right of way S 85°45'49"E a distance of 113.66 feet to a point;

Thence continuing along existing Bowen Road right of way with a curve to the right of radius 125.00 feet, which chord bears S 62°25'37"E a distance of 99.03 feet, an arc length of 101.83 feet, with a central angle of 46°40'24", to a point of intersection of existing Bowen Road right of way and relocated Bowen Road drainage easement (plans on file with Franklin County Engineer, Columbus, Ohio);

Thence leaving existing Bowen Road right of way and along said drainage easement S 4°26'05"E a distance of 76.22 feet to a point of intersection of relocated Bowen Road right of way and said drainage easement;

Thence along Relocated Bowen Road right of way with a curve to the left of radius 421.97 feet, which chord bears N 53°31'04"W a distance of 41.10 feet, an arc length of 41.11 feet, with a central angle of 5°34'57", to the true point of beginning and containing 0.080 acres, more or less, from Auditor's parcel No. 183-7, 0.122 acres, more or less, from Auditor's Parcel No. 183-9, and 0.005 acres, more or less, from Auditor's Parcel No. 540-126860, being in all 0.207 acres, more or less.

This description is based on centerline of survey bearing as established relative to the grid bearing of Franklin County Geologic Survey Monuments 9932 and 9968 as placed in Bowen Road, said grid bearing being N 4°14'32"E.

VACATION OF A PORTION OF BOWEN ROAD, MADISON TOWNSHIP, FRANKLIN COUNTY, OHIO

AREA FOUR

Beginning at a point 40.00 feet right of centerline of survey Station 40+58.34 of relocated Bowen Road (plans on file with Franklin County Engineer, Columbus, Ohio) said point being a point of intersection of relocated Bowen Road right of way and existing Bowen Road right of way;

Thence along relocated Bowen Road right of way N 58°48'41"W a distance of 61.21 feet to a point;

Thence leaving relocated Bowen Road right of way and along existing Bowen Road right of way N 2°38'25" E a distance of 1466.72 feet to a point of intersection of existing Bowen Road right of way and existing Wright Road right of way;

Thence along existing Wright Road right of way S 86°24'19" E a distance of 50.01 feet to a point;

Thence leaving existing Wright Road right of way and along existing Bowen Road right of way S 2°38'25" W a distance of 1471.68 feet to a point;

Thence continuing along existing Bowen Road right of way with a curve to the left of radius 75.00 feet, which chord bears S 6°28'27" E a distance of 23.76 feet, an arc length of 23.86 feet, with a central angle of 18°13'44" to the true point of beginning and containing 0.854 acres, more or less, from Auditor's Parcel No. 183-7, 0.274 acres, more or less, from Auditor's Parcel No. 540-126702, and 0.571 acres, more or less, from Auditor's Parcel No. 540-192143, being in all 1.699 acres, more or less.

This description is based on centerline of survey bearing as established relative to the grid bearing of Franklin County Geologic Survey Monuments 9932 and 9968 as placed in Bowen Road, said grid bearing being N 4°14'32"E.

AREA FIVE

Beginning at a point 40.00 feet right of centerline of survey Station 36+80.95 of relocated Bowen Road (plans on file with Franklin County Engineer, Columbus, Ohio), said point being a point of intersection of relocated Bowen Road right of way and existing Bowen Road right of way;

Thence leaving existing Bowen Road right of way and along relocated Bowen Road right of way with a curve to the left of radius 421.97 feet, which chord bears N 46°36'47"W a distance of 3.36 feet, an arc length of 3.36 feet, with a central angle of 0°27'21" to a point of intersection of relocated Bowen Road right of way and relocated Bowen Road right of way and relocated Bowen Road drainage easement (plans on file with Franklin County Engineer, Columbus, Ohio);

Thence along said drainage easement N 4°26'05" W a distance of 48.82 feet to a point of intersection of said drainage easement and existing Bowen Road right of way;

Thence leaving said drainage easement and along existing Bowen Road right of way with a curve to the right of radius 125.00 feet, which chord bears S 9°52'01" E a distance of 22.99 feet, an arc length of 23.02 feet, with a central angle of 10°33'10" to a point;

Thence continuing along existing Bowen Road right of way S 4°35'26" E a distance of 28.42 feet to the true point of beginning and continuing 0.002 acres, more or less, from Auditor's Parcel No. 540-126860.

This description is based on centerline of survey bearing as established relative to the grid bearing of Franklin County Geologic Survey 9932 and 9968 as placed in Bowen Road, said grid bearing being N 4°14'32"E;

The petition praying for the vacation of a portion of Bowen Road, Madison Township, Franklin County, Ohio, is on file in your office.

Utilities that are now within this part of the vacation and easements granted by the subdividers for utilities are not to be vacated.

It is my recommendation that a portion of Bowen Road, Madison Township, Franklin County, Ohio, be vacated.

Respectfully submitted,

John Circle, P.E., P.S.
Franklin County Engineer

JC:JJG:cmc

RESOLUTION NO. 395-95

April 18, 1995

PRAYER OF PETITION TO VACATE A
PORTION OF BOWEN ROAD, MADISON
TOWNSHIP, FRANKLIN COUNTY, OHIO
- GRANTED
(FRANKLIN COUNTY ENGINEER)

WHEREAS, the Columbus and Franklin County Metropolitan Park Board has petitioned for the vacation of a portion of Bowen Road, Madison Township, Franklin County, Ohio; and

WHEREAS, on April 11, 1995, the Board of County Commissioners of Franklin County, Ohio, by resolution duly adopted direct the Engineer of Franklin County, Ohio, to make a report in writing to this Board on or before the 18th day of April, 1995, relative to the petition for the vacation of a portion of Bowen Road, Madison Township, Franklin County, Ohio, said report to be made in manner and form set forth and required by Section 5553.04 of the Ohio Revised Code; and

WHEREAS, John Circle, County Engineer did on April 18, 1995, report thereon in writing which report contained the following recommendation, to-wit:

AREA ONE

Beginning at a point 40 feet left of centerline of survey Station 29+28.37 of Relocated Bowen Road (plans on file with Franklin County Engineer, Columbus, Ohio), said point being a point of intersection of Relocated Bowen Road right of way and existing Bowen Road right of way;

Thence leaving relocated Bowen Road right of way and along existing Bowen Road right of way with a curve to the left of radius 793.51 feet, which chord bears N 83°52'57"W a distance of 182.53 feet, an arc length of 182.93 feet, with a central angle of 13°12'31" to a point;

Thence continuing with existing Bowen Road right of way S 89°30'47"W a distance of 119.29 feet to a point;

Thence continuing with existing Bowen Road right of way with a curve to the right of radius 125.00 feet, which chord bears N 72°05'41"W a distance of 78.88 feet, an arc length of 80.25 feet, with a central angle of 36°47'04" to a point;

Thence leaving existing Bowen Road right of way N 89°51'53"E a distance of 5.14 feet to a point;

Thence N 49°56'30"E a distance of 50.08 feet to a point on existing Bowen Road right of way;

Thence continuing with existing Bowen Road right of way with a curve to the left of radius 75.00 feet, which chord bears S 78°14'00"E a distance of 31.84 feet, an arc length of 32.08 feet, with a central angle of 24°30'25" to a point;

Thence continuing with existing Bowen Road right of way N 89°30'47"E a distance of 119.29 feet to a point;

Thence continuing with existing Bowen Road right of way with a curve to the right of radius 843.51 feet, which chord bears S 89°27'56"E a distance of 30.07 feet, an arc length of 30.07 feet, with a central angle of 2°2'34" to a point of intersection of existing Bowen Road right of way and relocated Bowen Road right of way;

Thence leaving existing Bowen Road right of way and along relocated Bowen Road right of way with a curve to the left of radius 421.97 feet, which chord bears S 63°29'19"E a distance of 38.75 feet, an arc length of 38.76 feet, with a central angle of 5°15'48" to a point;

Thence continuing with relocated Bowen Road right of way S 66°07'13"E a distance of 128.14 feet to the true point of beginning and containing 0.139 acres, more or less, from Auditor's Parcel No. 540-126860, 0.013 acres, more or less, from Auditor's parcel No. 540-191237, 0.010 acres, more or less, from Auditor's parcel No. 540-192142, and 0.148 acres, more or less, from Auditor's Parcel No. 540-203801, being in all 0.310 acres, more or less.

This description is based on centerline of surveying bearing as established relative to the grid bearing of Franklin County Geologic Survey Monuments 9932 and 9968 as placed in Bowen Road, said grid bearing being N 4°14'32"E.

AREA TWO

Beginning at a point 40 feet left of centerline of survey Station 35+56.19 of relocated Bowen Road (plans on file with Franklin County Engineer, Columbus, Ohio), said point being a point of intersection of relocated Bowen Road right of way and existing Bowen Road right of way;

Thence leaving relocated Bowen Road right of way and along existing Bowen Road right of way S 4°35'26"E a distance of 333.57 feet to a point;

Thence continuing along existing Bowen Road right of way with a curve to the left of radius 75.00 feet, which chord bears S 23°23'19"E a distance of 48.34 feet, an arc length of 49.21 feet, with a central angle of 37°35'37" to a point;

Thence leaving existing Bowen Road right of way S 49°56'30"W a distance of 49.82 feet to a point;

Thence S 4°35'26"E a distance of 0.34 feet to a point on existing Bowen Road right of way;

Thence along existing Bowen Road right of way with a curve to the right of radius 125.00 feet, which chord bears N 23°01'31"W a distance of 79.06 feet, an arc length of 80.44 feet, with a central angle of 36°52'12" to a point;

Thence continuing along existing Bowen Road right of way N 4°35'26"W a distance of 416.15 feet to a point of intersection of existing Bowen Road right of way and relocated Bowen Road right of way;

Thence along relocated Bowen Road right of way with a curve to the right of radius 341.97 feet, which chord bears S 35°47'10"E a distance of 96.53 feet, an arc length of 96.86 feet, with a central angle of 16°13'40" to the true point of beginning and containing 0.001 acres, more or less, from Auditor's parcel No. 183-9, 0.258 acres, more or less, from Auditor's parcel No. 183-13, and 0.251 acres, more or less, from Auditor's Parcel No. 540-126860, being in all 0.510 acres, more or less.

This description is based on centerline of survey bearing as established relative to the grid bearing of Franklin County Geologic Survey Monuments 9932 and 9968 as placed in Bowen Road, said grid bearing being N4°14'32"E.

AREA THREE

Beginning at a point 40 feet right of centerline of survey Station 37+47.11 of relocated Bowen Road (plans on file with Franklin County Engineer, Columbus, Ohio), said point being a point of intersection of relocated Bowen Road right of way and existing Bowen Road right of way;

Thence leaving relocated Bowen Road right of way and along existing Bowen Road right of way with a curve to the left of radius 75.00 feet, which chord bears N 53°32'24"W a distance of 79.98 feet, an arc length of 84.36 feet, with a central angle of 64°26'49" to a point;

Thence continuing along existing Bowen Road right of way N 85°45'49"W a distance of 15.32 feet to a point of intersection of existing Bowen Road right of way and relocated Bowen Road right of way;

Thence along relocated Bowen Road right of way N 58°48'41"W a distance of 110.32 feet to a point;

Thence leaving relocated Bowen Road right of way and along existing Bowen Road right of way S 85°45'49"E a distance of 113.66 feet to a point;

Thence continuing along existing Bowen Road right of way with a curve to the right of radius 125.00 feet, which chord bears S 62°25'37"E a distance of 99.03 feet, an arc length of 101.83 feet, with a central angle of 46°40'24", to a point of intersection of existing Bowen Road right of way and relocated Bowen Road drainage easement (plans on file with Franklin County Engineer, Columbus, Ohio);

Thence leaving existing Bowen Road right of way and along said drainage easement S 4°26'05"E a distance of 76.22 feet to a point of intersection of relocated Bowen Road right of way and said drainage easement;

Thence along Relocated Bowen Road right of way with a curve to the left of radius 421.97 feet, which chord bears N 53°31'04"W a distance of 41.10 feet, an arc length of 41.11 feet, with a central angle of 5°34'57", to the true point of beginning and containing 0.080 acres, more or less, from Auditor's parcel No. 183-7, 0.122 acres, more or less, from Auditor's Parcel No. 183-9, and 0.005 acres, more or less, from Auditor's Parcel No. 540-126860, being in all 0.207 acres, more or less.

This description is based on centerline of survey bearing as established relative to the grid bearing of Franklin County Geologic Survey Monuments 9932 and 9968 as placed in Bowen Road, said grid bearing being N 4°14'32"E.

AREA FOUR

Beginning at a point 40.00 feet right of centerline of survey Station 40+58.34 of relocated Bowen Road (plans on file with Franklin County Engineer, Columbus, Ohio) said point being a point of intersection of relocated Bowen Road right of way and existing Bowen Road right of way;

Thence along relocated Bowen Road right of way N 58°48'41"W a distance of 61.21 feet to a point;

Thence leaving relocated Bowen Road right of way and along existing Bowen Road right of way N 2°38'25" E a distance of 1466.72 feet to a point of intersection of existing Bowen Road right of way and existing Wright Road right of way;

Thence along existing Wright Road right of way S 86°24'19" E a distance of 50.01 feet to a point;

Thence leaving existing Wright Road right of way and along existing Bowen Road right of way S 2°38'25" W a distance of 1471.68 feet to a point;

Thence continuing along existing Bowen Road right of way with a curve to the left of radius 75.00 feet, which chord bears S 6°28'27" E a distance of 23.76 feet, an arc length of 23.86 feet, with a central angle of 18°13'44" to the true point of beginning and containing 0.854 acres, more or less, from Auditor's Parcel No. 183-7, 0.274 acres, more or less, from Auditor's Parcel No. 540-126702, and 0.571 acres, more or less, from Auditor's Parcel No. 540-192143, being in all 1.699 acres, more or less.

This description is based on centerline of survey bearing as established relative to the grid bearing of Franklin County Geologic Survey Monuments 9932 and 9968 as placed in Bowen Road, said grid bearing being N 4°14'32"E.

AREA FIVE

Beginning at a point 40.00 feet right of centerline of survey Station 36+80.95 of relocated Bowen Road (plans on file with Franklin County Engineer, Columbus, Ohio), said point being a point of intersection of relocated Bowen Road right of way and existing Bowen Road right of way;

Thence leaving existing Bowen Road right of way and along relocated Bowen Road right of way with a curve to the left of radius 421.97 feet, which chord bears N 46°36'47"W a distance of 3.36 feet, an arc length of 3.36 feet, with a central angle of 0°27'21" to a point of intersection of relocated Bowen Road right of way and relocated Bowen Road right of way and relocated Bowen Road drainage easement (plans on file with Franklin County Engineer, Columbus, Ohio);

Thence along said drainage easement N 4°26'05" W a distance of 48.82 feet to a point of intersection of said drainage easement and existing Bowen Road right of way;

Thence leaving said drainage easement and along existing Bowen Road right of way with a curve to the right of radius 125.00 feet, which chord bears S 9°52'01" E a distance of 22.99 feet, an arc length of 23.02 feet, with a central angle of 10°33'10" to a point;

Thence continuing along existing Bowen Road right of way S 4°35'26" E a distance of 28.42 feet to the true point of beginning and continuing 0.002 acres, more or less, from Auditor's Parcel No. 540-126860.

This description is based on centerline of survey bearing as established relative to the grid bearing of Franklin County Geologic Survey 9932 and 9968 as placed in Bowen Road, said grid bearing being N 4°14'32"E; Respectfully submitted, John Circle, P.E., P.S., Franklin County Engineer; and

WHEREAS, no objection to the vacation of a portion of Bowen Road, Madison Township, Franklin County, Ohio, was filed, no claims for compensation or damages on account thereof were filed; and

WHEREAS, the Board of County Commissioners of Franklin County, Ohio, finds that the utilities are now within the said vacation, and the easement granted by the subdividers for utilities are not to be vacated through the area sought to be vacated; now, therefore upon motion of Commissioner Teater, seconded by Commissioner Stokes;

BE IT RESOLVED, BY THE BOARD OF COUNTY COMMISSIONERS OF FRANKLIN COUNTY, OHIO:

Section 1) That the vacation of a portion of Bowen Road, Madison Township, Franklin County, Ohio, as recommended by the County Engineer to be vacated and as described in his report and shown on the submitted plat, be and the same is hereby declared vacated, excepting however, the utilities that are now within the said portion of the above mentioned vacation and the easement granted by the owners, present or past for utilities.

Voting Aye thereon: Arlene Shoemaker, Dorothy S. Teater and Dewey R. Stokes.

VACATION PLAT

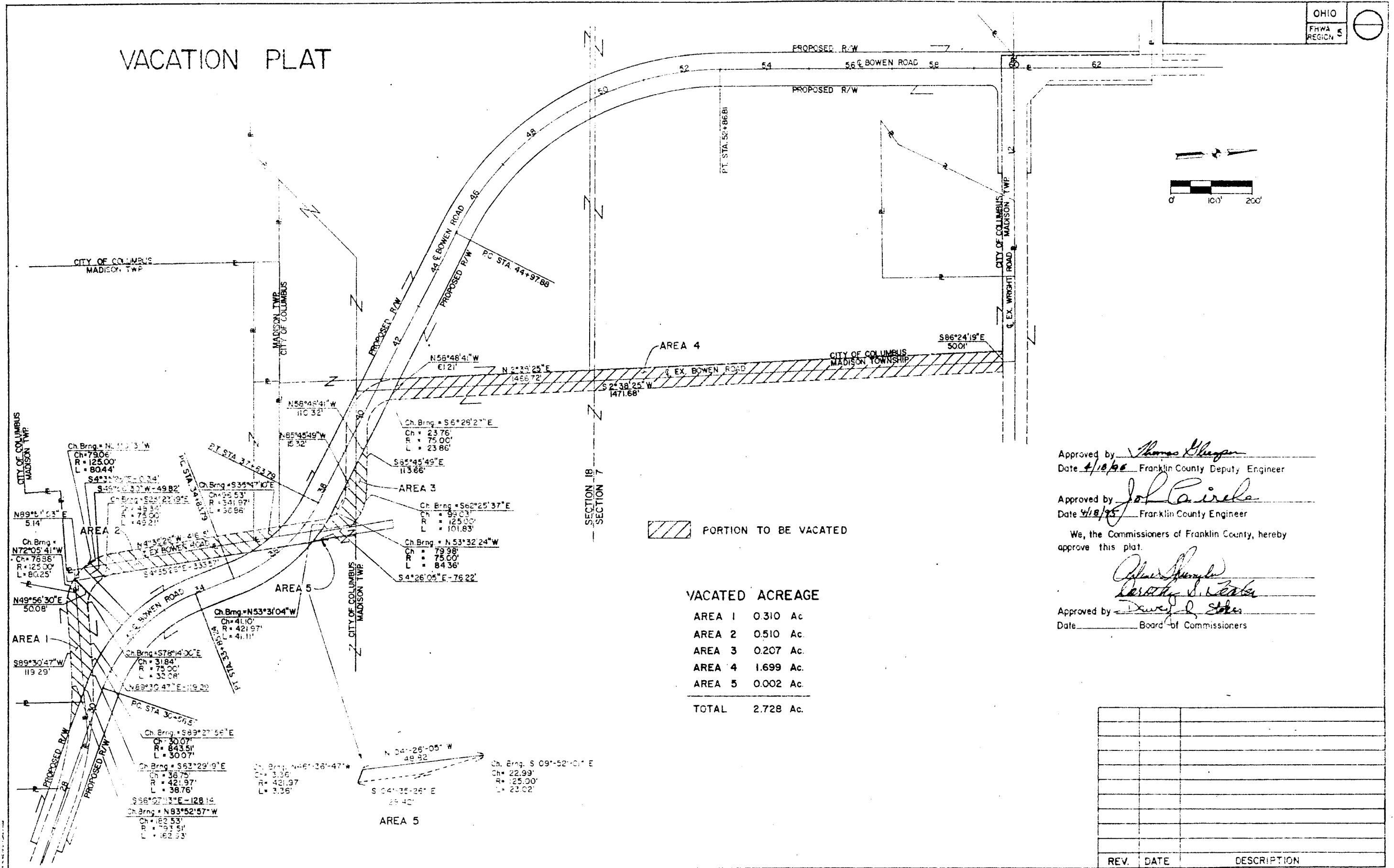

PORTION TO BE VACATED

VACATED ACREAGE	
AREA 1	0.310 Ac
AREA 2	0.510 Ac
AREA 3	0.207 Ac
AREA 4	1.699 Ac
AREA 5	0.002 Ac
TOTAL	2.728 Ac

Approved by Thomas Blaugher
Date 4/10/95 Franklin County Deputy Engineer

Approved by John Cairns
Date 4/18/95 Franklin County Engineer

We, the Commissioners of Franklin County, hereby approve this plat.

Robert Blaugher
Barbara S. Blaugher
Approved by Dwight L. Stokes
Date _____ Board of Commissioners

REV.	DATE	DESCRIPTION