

Frederick Cole's Road.

To the Commissioners of Franklin County

The Undersigned Freeholders and residents of Franklin County respectfully represent, that the Public interest requires the Establishment of a County Road, as follows, viz; To Commence at the National Road on the line between the heirs of Thomas Graham and D. S. Elliott; Thence North with Said line to Graham's N. W. Corner in the South line of Frederick Coles land thence Northwardly through Said Coles land to the Northside of the Columbus and Xenia Rail Road, thence With the rail Road to the east line of William Clover's land; thence North on Clovers line to Solomon Clover's land, thence north With Solomon Clover's line to intersect the Old County Road, thence With Said road to Thomas Cains Southeast Corner, thence With Cains line to Brown's County Road.

March 3rd 1851, Fredrick Cole, William Clover, G. W. Butler, John Brown, Daniel Fleming, N. Harrington, Thomas Graham, R. Holliday, D. S. Elliott, G. M. Clover, Wm Lisle, Solomon Clover, Joshua Cole, William Brown, Wm A. Clover,

Auditor's Office, Franklin Co. O.

April 29, 1851.

Cole Road - from US 40 to Feder Road

ROW = 40'

ROAD RECORD NO. 8

ROAD RECORD NO. 8

PAGE NO. 29

Arnold Clapp)
Henry Mc Cracken) Viewers
David Smiley
Frederick Cole Surveyor
Gent.

You have been Appointed by the Commissioners of Franklin Co. to View and Survey a route for a New Co. Road in Prairie Township; Beginning at the National Road on the line between the heirs of Thomas Graham and D. S. Elliott; thence North With Said line to Graham's N. W. Corner in the South line of Frederick Cole's land; thence Northwardly through Said Cole's land to the North side of the Columbus and Xenia Rail Road; thence With the Rail Road to the east line of Wm Clover's land, thence North on Clover's land to Solomon Clover's land, thence North With Solomon Clover's line to Intersect the Old County Road, thence with Said road to Thomas Cains South East Corner; thence With Said Cains line to Brown County Road

You Will therefore Meet a Alton on the 8 Day of May 1851 and proceed according to law, a Copy of Which is hereinto annexed- By Order of the Board.

H. Crary
Clerk of Board.

To the Commissioners of Franklin County Pursuant to an Order to us directed from your Honorable body, in answer to a petition of Wm Clover & Others for a New County Road, We Met on the 8 Day of May 1851 With Frederick Cole Surveyor and Caused a Survey and location of Said Road to be Made, (after first being quillified according to law). And We are of the opinion that Said road if established Would be a public, benefit and is Much Needed as an Outlet for the inhabitants along and in the Vicinity of the of Said proposed road, as they have no Means to reach a Public Road but by passing through farms the ground is also favorable for a road and passes principlaly on the line of Farms; We ar also of the opinion that no damage Would result to any individual in Consequence of the location of Said road and that in our opinion it Ought to be forty feet wide and no More, For a More full description of Said road reference is Made to the Surveyor's plat and report.

May 8th 1851

David Smiley)
H. McCracken) Viewers
Arnold Clapp)

Pursant to an Order from the Commissioners of Franklin County and petition of William Clover and Others for a New County Road; proceeded on the 8th Day May 1851, (after being qualified according to Law) under the direction of Arnold Clapp Henry McCracken and David Smiley Viewers; to Make a Survey and location of Said road as flllows.

Beginning at a Stake in the National road on the line between the heirs of Thomas Graham and D. S. Elliott; thence With said line North 135³/₄ poles to the Northwest Corner of Said heirs land, thence N 10° W through F. Coles land 98¹/₂ poles to a stake on the North side of the Columbus and Xeina Rail Road, in William Clover's east line, thence With Said line North 85³/₄ poles to a Hickory, thence 1 Mile Continued same course 82 poles to a post in Solomon Clovers east line; thence N. 64³/₄° W 42 poles to a Hickory, thence West 24 poles to a dogwood at Thomas Caines Southeast Corner, thence With Caines east line N. 10° W 95¹/₂ poles to Browns road; Making the total distance one Mile and two hundred and forty three and one half poles.

I Certify the fore goine plat and field Notes to be Correct

F. Cole Surveyor

(MAP & DRAWING OF ROAD)

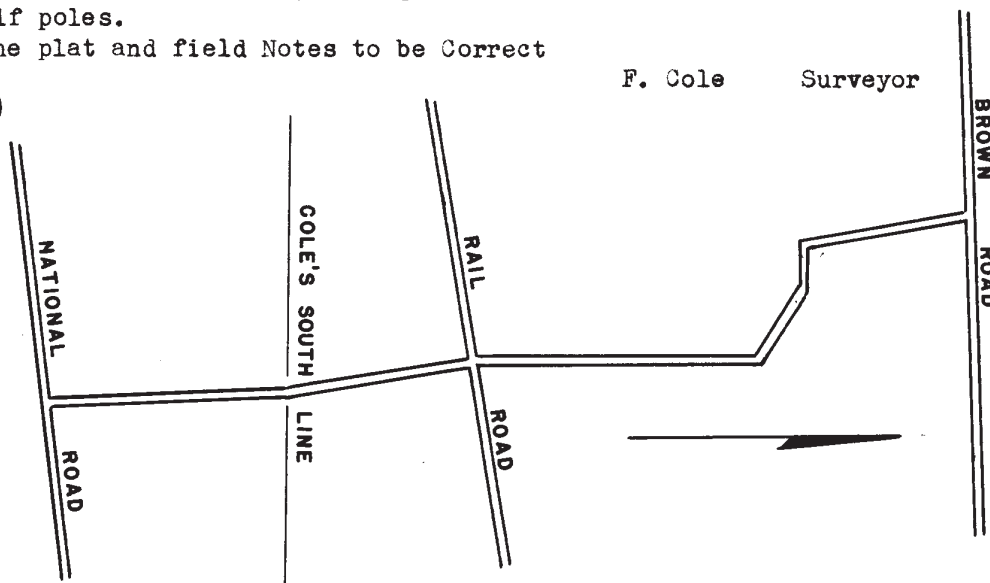

0740
300/Road Record
8
Page 29-30
1851
0010
010