

Continued from preceding page.

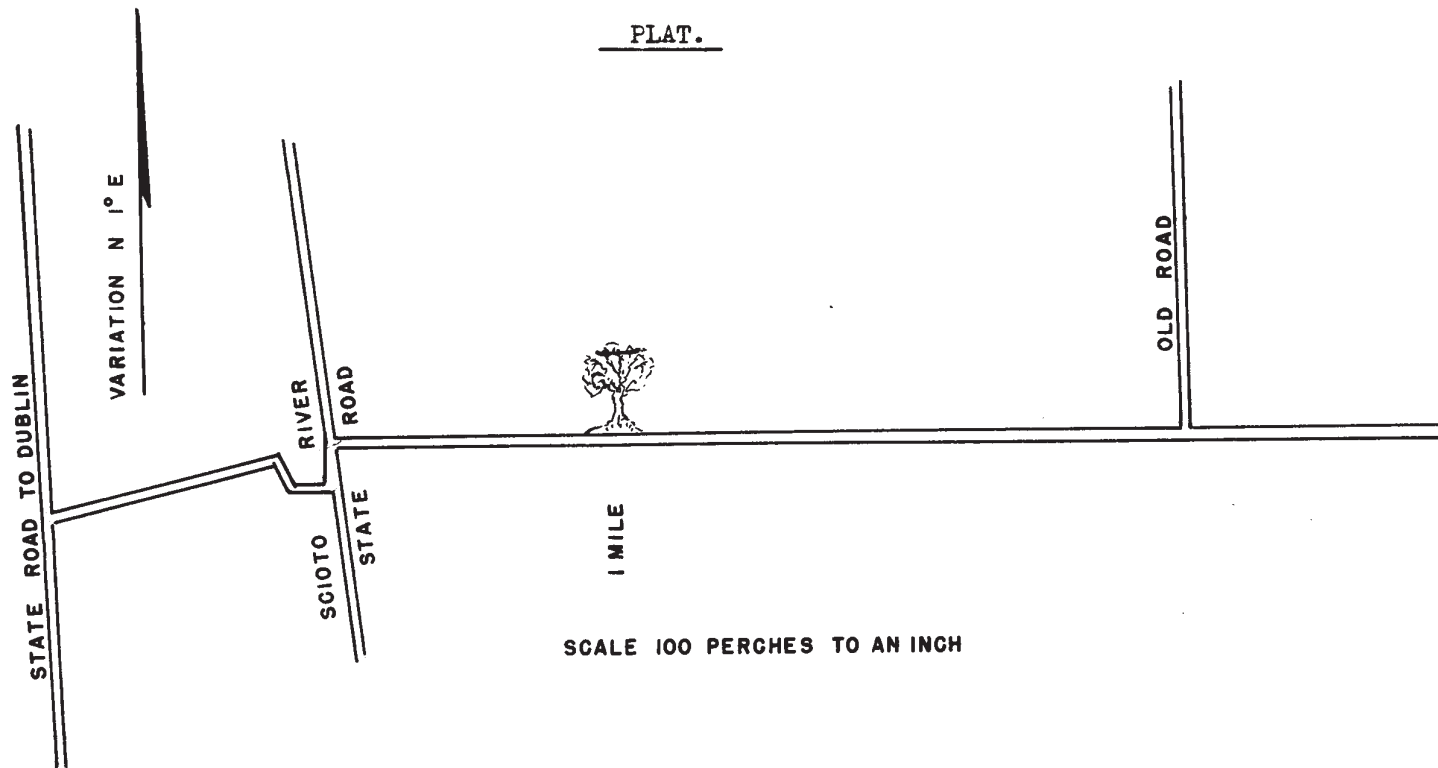

14000

003

Road Record

7

Page 400

Record

003

0220

Pursuant to the annexed order I proceeded on the fifteenth day of April 1848. under the direction of Miskell Saunders, James Walcutt and Wm. Armsted, viewers, to make a survey and location of a new County road petitioned for by W. T. Delashmutt and others as follows, viz; Beginning at a post in the quarter Township line in Perry Township between the lands of Robert Ferguson and Thomas Legg and between quarter Township one and four Tp. 1 in Range 19 where a County road intersects said line; from thence on said line West 320 poles to a stake and a sugar tree marked 1 mile; same course 156 poles to a stake in the State Road on the east side of the Scioto river; thence S 9 W 22½ poles to a stake on the bank of said river; thence crossing said river S. 68 W. 18½ poles to a stake on the west side of said river; thence N 22 W 18 poles to a post, passing Howard's mill at 12 poles; thence S 75½ W 105 poles to a post and a beech stump marked 2 miles; same course 25 poles to a stake in the State Road leading from Columbus to Dublin on the west side of the Scioto River in Norwich Township, whole distance 2 miles and 25 poles.

I certify that the above field notes are correct as taken by me on the ground, and that the plat is a true protraction of the same.

Wm. Johnston, Surveyor.

Fees			
Miskell Saunders	Viewer	3 days	\$3.00
James Walcutt	"	"	3.00
Wm. Armsted	"	"	3.00
Wm Johnston	Surveyor	2 days	\$3.00
John Legg	C. Carrier	"	1.50
Thomas Legg	"	1 day	.75
W. T. Delashmutt	Marker	"	.75

December Session 1848. it is ordered by the Board of---Commissioners that said papers be recorded and road established as a public highway, and that an order be issued, for opening the same forty feet wide, that being the width recommended by the viewers.