

RECEIVED

OCT 31 2023

Franklin County Engineer
Connell R. Robertson, P.E., P.S.

DEED REFERENCE
DONNA JEAN SPILLMAN
(1/2 INTEREST)
OR 26381 C04
DONNA JEAN SPILLMAN
AKA DONNA J SPILLMAN (1/2 INTEREST)
INSTR No. 202204290066531

PARCEL No. 230-001501-00
91.393 ACRES (AUDITOR)
(A) 48.783 ACRES (DEED)
PARCEL 5: PARCEL 1: TRACT A
50 ORG ACRES

LEGEND

- ALL MONUMENTS FOUND OR SET ARE IN GOOD CONDITION UNLESS OTHERWISE NOTED.
- MONUMENT BOX (FOUND)
- MAG NAIL (SET)
- 5/8" Ø REBAR & YELLOW PLASTIC CAP STAMPED "COTTRILL SURVEYING" (SET)

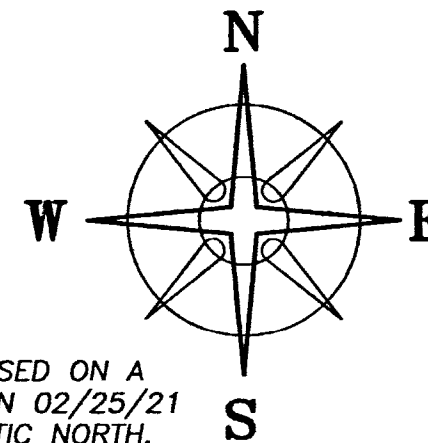

BEARINGS ARE BASED ON A GPS OBSERVATION ON 02/25/21 WGS 1984 GEODETIC NORTH. BEARING OF THE CENTERLINE OF BEATTY ROAD BETWEEN FCGS 5225 & FCGS 5217 IS N 89°30'47" W

LINE	BEARING	DISTANCE
L1	S 87°14'17" W	60.87'
L2	N 01°35'23" E	199.14'
L3	S 01°35'23" W	20.00'
L4	S 88°24'37" E	50.00'
L5	S 17°11'06" W	185.98'
L6	N 88°24'37" W	77.23'
L7	N 01°35'23" E	179.14'

BEATTY ROAD (C-264, 40' R/W)

5.1454± ACRES
0.5287± ACRES IN PRO

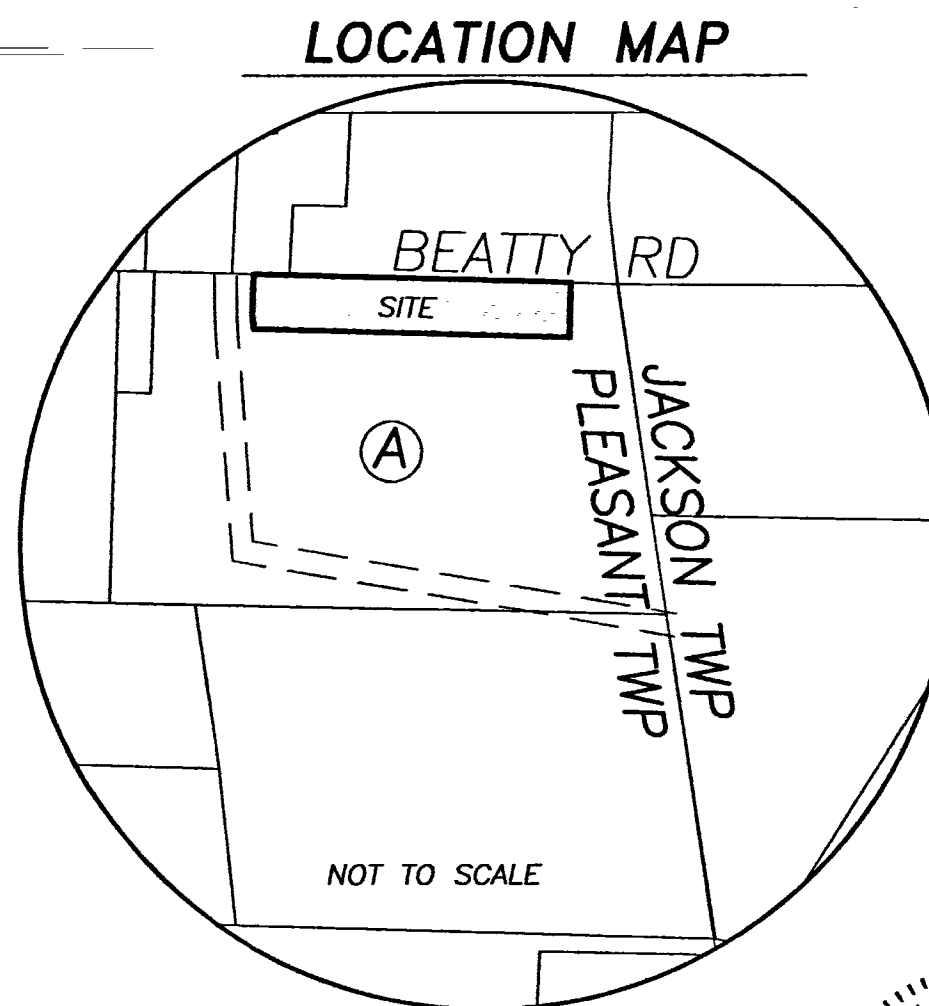

DONNA JEAN SPILLMAN (1/2)
OR 26381 C04
DONNA JEAN SPILLMAN (1/2)
AKA DONNA J SPILLMAN
INSTR No. 202204290066531
PARCEL 5: PARCEL 1: TRACT B
30.996 ACRES

REVISED 10/10/2023

COTTRILL SURVEYING, INC

James R Cottrill, PS Nathan Cottrill, PE PS
15882 US Route 62 NE, Mt. Sterling, Ohio 43143
Office: (740) 869-3811 www.cottrillsurveying.com

5.1454± ACRES
VMS 3027, PLEASANT TOWNSHIP,
FRANKLIN COUNTY, STATE OF OHIO.
SURVEYED FOR SPILLMAN

SCALE : 1" = 100'
100' 50' 0 100'

JOB No. S230619 CREW: MW
SURVEYED 07/24/23 DWN BY: NC
DRAWN 07/25/23 CHECK: RC

I HEREBY CERTIFY THAT THIS PLAT DEPICTS AN ACTUAL FIELD SURVEY PERFORMED BY NATHAN L. COTTRILL, P.S. #8821
DATE: 10/13/23

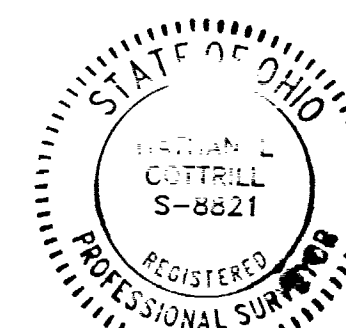

DRAWING PROVIDED BY FRANKLIN CO. DRAINAGE ENGINEER'S OFFICE
CENTERLINE OF PETITION DITCH, AS SCALED FROM
S 00°03'04" W 924.83'

40.0'±
80.0'±

S 81°12'46" E
1361.29'

S 67°13'26" E 242.87'
TO EAST LINE OF 48.783 ACRES,
TWP LINE AND VMS LINE

FCGS 6028

S 88°24'37" E 348.54'

L6

L4

L2

L1

L5

L3

L7

L4

L2

L1

L5

L3

L7

L4

L2

L1

L5

L3

L7

L4

L2

L1

L5

L3

L7

L4

L2

L1

L5

L3

L7

L4

L2

L1

L5

L3

L7

L4

L2

L1

L5

L3

L7

L4

L2

L1

L5

L3

L7

L4

L2

L1

L5

L3

L7

L4

L2

L1

L5

L3

L7

L4

L2

L1

L5

L3

L7

L4

L2

L1

L5

L3

L7

L4

L2

L1

L5

L3

L7

L4

L2

L1

L5

L3

L7

L4

L2

L1

L5

L3

L7

L4

L2

L1

L5

L3

L7

L4

L2

L1

L5

L3

L7

L4

L2

L1

L5

L3

L7

L4

L2

L1

L5

L3

L7

L4

L2

L1

L5

L3

L7

L4

L2

L1

L5

L3

L7

L4

L2

L1

L5

L3

L7

L4

L2

L1

L5

L3

L7

L4

L2

L1

L5

L3

L7

L4

L2

L1

L5

L3

L7

L4

L2

L1

L5

L3

L7

L4

L2

L1

L5

L3

L7

L4

L2

L1

L5

L3

L7

L4

L2

L1

L5

L3

L7

L4

L2

L1

L5

L3

L7

L4

L2

L1

L5

L3

L7

L4

L2

L1

L5

L3

L7

L4

L2

L1

L5

L3

L7

L4

L2

L1

L5

L3

L7

L4

L2

L1

L5

L3

L7

L4

L2

L1

L5

L3

L7

L4

L2

L1

L5

L3

L7

L4

L2

L1

L5

L3

L7

L4

L2

L1

L5

L3

L7

L4

L2

L1

L5

L3

L7

L4

L2

L1

L5

L3

L7

L4

L2

L1

L5

L3

L7

L4

L2

L1

L5

L3

L7

L4

L2

L1

L5

L3

L7

L4

L2

L1

L5

L3

L7

L4

L2