

**VACATION OF 0.051, 0.080, & 0.042 ACRE EASEMENT**  
 State of Ohio, County of Franklin, City of Columbus  
 Half Section 52, Section 29, Township 12 North, Range 21 West  
 Refugee Lands

LEXINGTON SECTION NO. 2  
 P.B. 42 PG. 84  
 RESERVE "B"

FIRST CHURCH OF GOD, INC.  
 PID: 010-109331-00  
 I.N. 199802230039216  
 124.349 Ac. (D)  
 PARCEL ONE

HELEN DEVELOPMENT  
 SUBDIVISION NO. 1  
 P.B. 45 PG. 118  
 LOT 2

Yal Investments LLC  
 PID: 010-308900-00  
 I.N. 202212190169374  
 1.055 Ac. (D)

Havens Edge Apartments, LLC  
 PID: 010-027889-00  
 I.N. 202503100022893  
 6.478 Ac. (D)

Vol. 3346 Pg. 535  
 10' Sanitary Easement

P.B. 45 Pg. 118  
 10' Easement

- LEGEND**
- Property Line
  - Centerline of Roadway
  - Right-of-Way
  - Point of Commencement
  - Point of Beginning
  - Proposed Vacation of Existing Easement

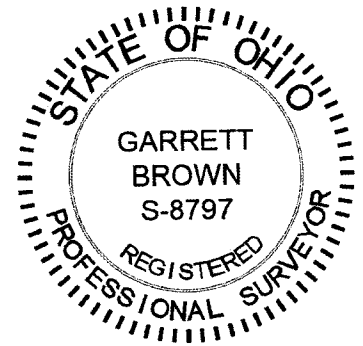
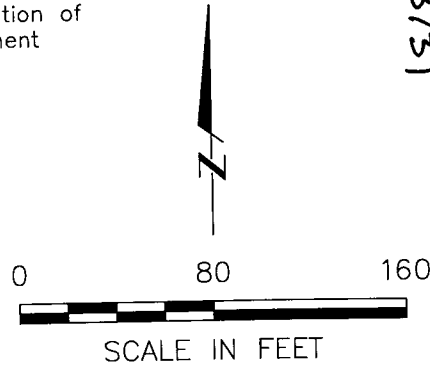

BY: Garrett Brown 4/9/2025  
 Garrett G. Brown, P.S., E.I.  
 Registered Surveyor No. 8797

DRWN BY BPB CHK BY GGB DATE 2025-04-09

1272.001

RECEIVED

MAY 18 2026

FRANKLIN COUNTY ENGINEER  
 ADAM W. FOWLER, P.E., P.S.

**E. P. FERRIS**  
 AND ASSOCIATES  
 INC.

Consulting Civil Engineers and Surveyors

2130 QUARRY TRAILS DR, 2ND FLOOR  
 COLUMBUS, OHIO 43228  
 (614) 299-2999  
 (614) 299-2992 (Fax)  
 www.EPFERRIS.com

**BASIS OF BEARINGS**

Ohio State Plane Coordinate System, Ohio South Zone,  
 NAD83 (2011) as determined by ODOT RTN observations,  
 with the northerly line of LOT 2 of HELEN DEVELOPMENT  
 SUBDIVISION NO. 1, as delineated in Plat Book 45, Page  
 118, bearing South 85°22'25" East.

EXHIBIT-A (P. 3/3)