

SURVEY OF 0.349 ACRES

FOR

THE 315 PLAZA, AN OHIO GENERAL PARTNERSHIP.

N

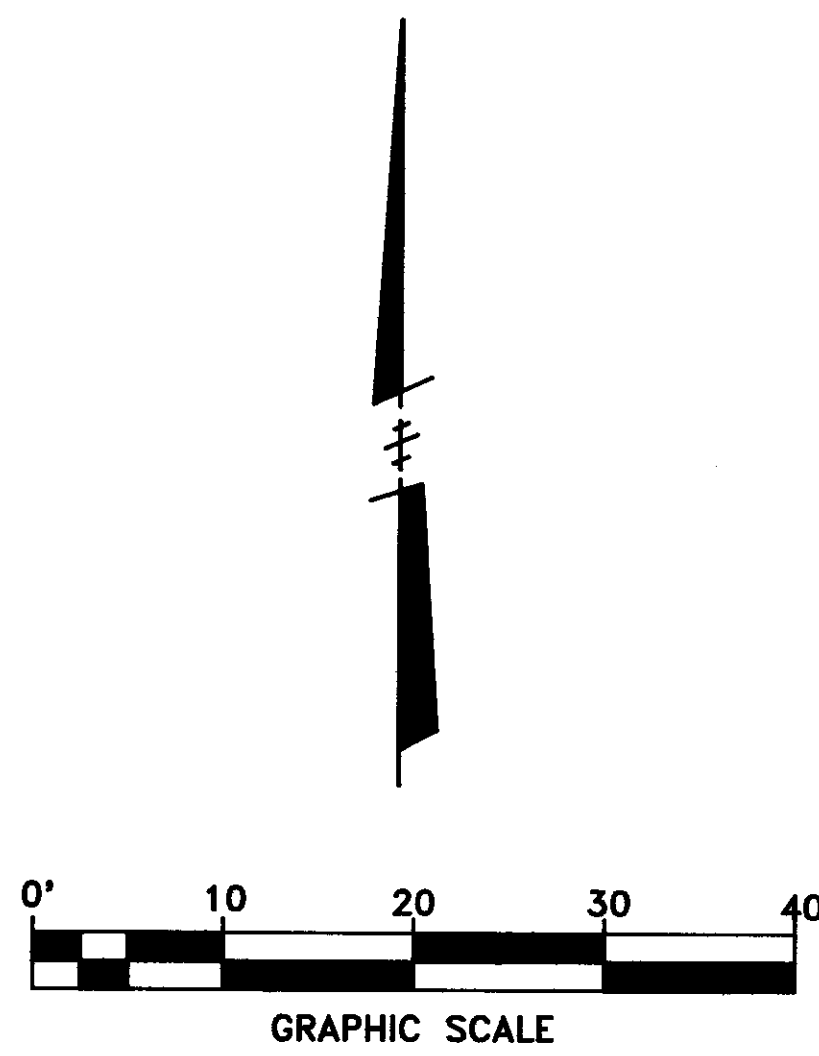

"COMMON AREA" DEED BOOK 3400 PAGE 695
FOR ACCESS AND UTILITIES.

LOT "G"

LOT "D"

OLENTANGY COMMERCIAL CENTER
PLAT BOOK 49 PAGE 5

SITE OF 315 PLAZA

SITE MAP
NO SCALE

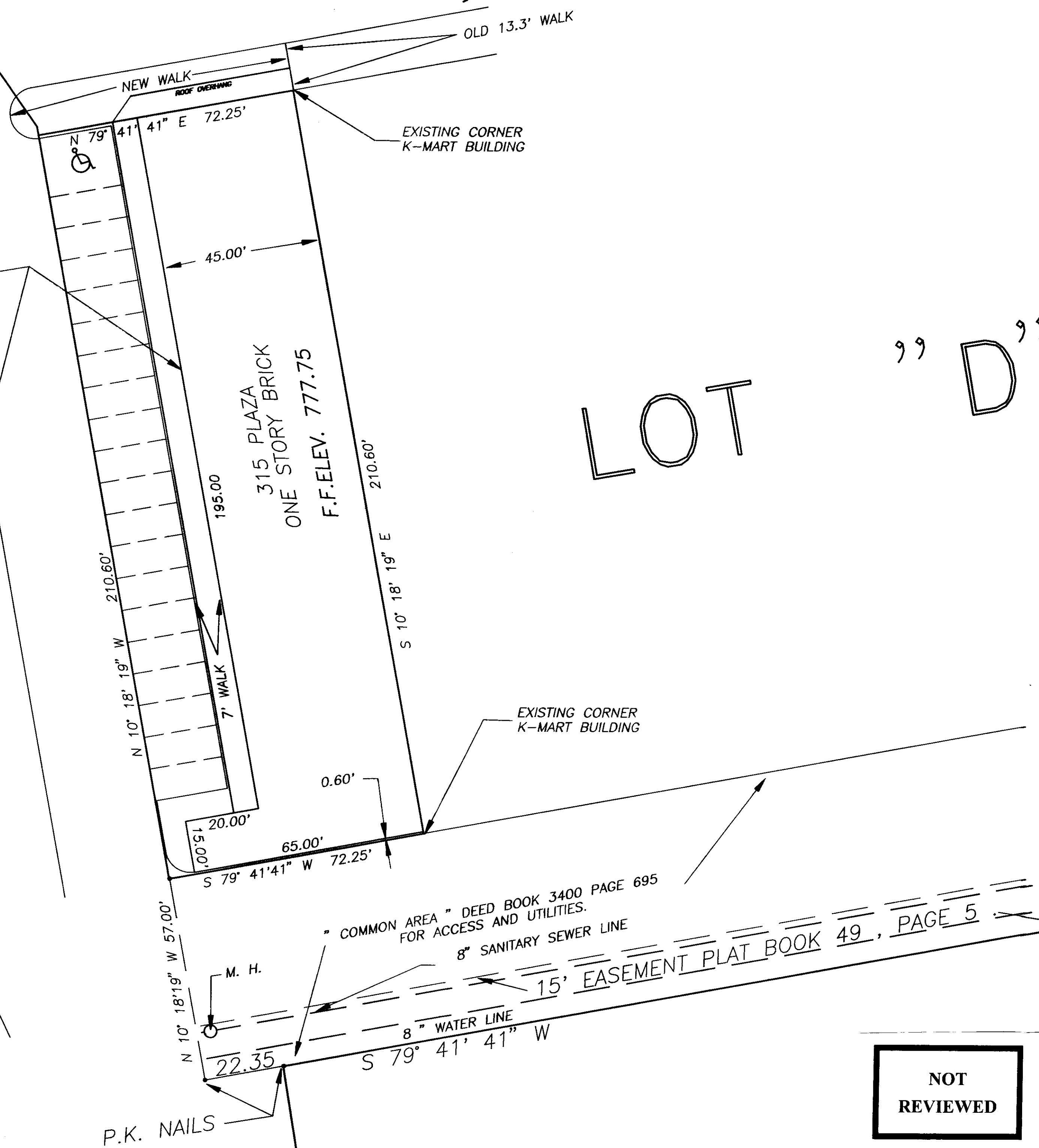

DESCRIPTION OF 0.349 ACRES OUT OF LOT "D" OF OLENTANGY COMMERCIAL CENTER, COLUMBUS, OHIO.

SITUATED IN THE STATE OF OHIO, COUNTY OF FRANKLIN, CITY OF COLUMBUS, BEING IN QUARTER TOWNSHIP 2, TOWNSHIP 1, RANGE 18, UNITED STATES MILITARY LANDS, BEING 0.349 ACRES OF LAND OUT OF LOT D OF OLENTANGY COMMERCIAL CENTER, THE PLAT OF WHICH IS OF RECORD IN DEED BOOK 3701, PAGE 866; ALL REFERENCES HEREIN BEING TO THE RECORDS LOCATED IN THE RECORDER'S OFFICE FRANKLIN COUNTY OHIO, SAID 0.349 ACRE TRACT BEING MORE PARTICULARLY DESCRIBED AS FOLLOWS:

BEGINNING FOR REFERENCE AT A P.K. NAIL IN THE SOUTHWEST CORNER OF SAID LOT D; THENCE NORTH 10 DEGREES 18' 19" WEST ALONG A WESTERLY LINE OF SAID LOT D, A DISTANCE OF 57.00 FEET TO AN IRON PIN SET, SAID PIN BEING THE TRUE PLACE OF BEGINNING;

THENCE NORTH 10 DEGREES 18' 19" WEST, CONTINUING ALONG SAID WESTERLY LINE, A DISTANCE OF 210.60 FEET TO AN IRON PIN SET;

THENCE NORTH 79 DEGREES 41' 41" EAST INTO SAID LOT D A DISTANCE OF 72.25 FEET TO A POINT AT THE NORTHWEST CORNER OF AN EXISTING K-MART BUILDING;

THENCE SOUTH 10 DEGREES 18' 19" EAST, PARALLEL TO THE WESTERLY LINE OF SAID LOT D AND ALONG THE FACE OF SAID K-MART BUILDING, A DISTANCE OF 210.60 FEET TO A POINT AT THE SOUTHWEST CORNER OF SAID K-MART BUILDING;

THENCE SOUTH 79 DEGREES 41' 41" WEST, A DISTANCE OF 72.25 FEET TO THE TRUE PLACE OF BEGINNING, AND CONTAINING 0.349 ACRES OF LAND.

BEARINGS USED IN THIS DESCRIPTION CONFORM TO THE BEARING SYSTEM OF THE PLAT OLENTANGY COMMERCIAL CENTER, OF RECORD IN PLAT BOOK 49, PAGE 5.

ABOVE DESCRIPTION TAKEN FROM MEMORANDUM OF LEASE AS FOUND RECORDED IN O.R. 3412-D-04, IN THE FRANKLIN COUNTY RECORDER'S OFFICE.

I CERTIFY TO THE UNITED COMPANIES LENDING CORPORATION, AND OR LAWYERS TITLE INSURANCE COMPANY AND/OR THEIR SUCCESSORS AND/ OR THEIR ASSIGNSORS AS THEIR INTREST MAY APPEAR THAT THIS IS A TRUE AND CORRECT SURVEY OF THE 315 PLAZA. THE SITE CONTAINS 15202.44 SQUARE FEET. THIS SURVEY WAS MADE BY THE UNDERSIGNED LICENSED SURVEYOR, WHICH SHOWS THE LOCATION OF THE BUILDINGS AND ALL OTHER IMPROVEMENTS LOCATED ON THE LAND AND EASEMENTS, RIGHT-OF-WAYS, SET BACK LINES AND SIMILAR RESTRICTIONS OF RECORD IN D.B. 3400, PG. 695. THE BUILDING AND OTHER IMPROVEMENTS DO NOT OVERHANG OR ENCRACH UPON ANY LAND, EASEMENT, OR RIGHT-OF-WAY OF OTHERS AND THERE ARE NO ENCRACHMENTS EITHER WAY ACROSS THE PROPERTY LINES, EXCEPT AS SHOWN HEREON. THE PROPERTY SURVEYED LIES IN ZONE C AREAS OF MINIMAL FLOODING AS SHOWN ON FIRM COMMUNITY-PANEL NUMBER 390170-0035-B, EFFECTIVE DATE JULY 5, 1983.

NOT
REVIEWED

Paul K Moore 6-4-1991
PAUL K. MOORE REG. SURVEYOR # 5883 DATE

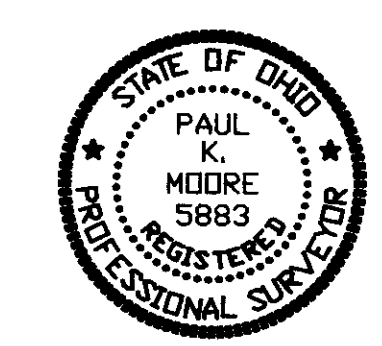

PAUL K. MOORE & ASSOCIATES
6515 EAST LIVINGSTON AVENUE
REYNOLDSBURG, OHIO 43068
614-866-9158

6-4-1991	
MORTGAGE LOCATION SURVEY OF 315 PLAZA	
	910102