

RECEIVED

FEB 04 2011

Franklin County Engineer
Dean C. Ringle, P.E., P.S.

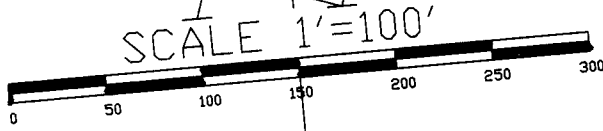

BASIS OF BEARINGS: THE WEST LINE OF THE SCIOTO VALLEY TRACTION COMPANY RIGHT-OF-WAY AS S 05°47'00" W FROM INST.#200902250025698.

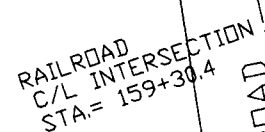
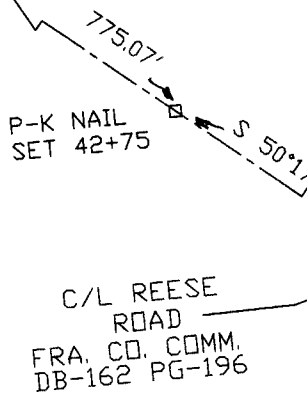
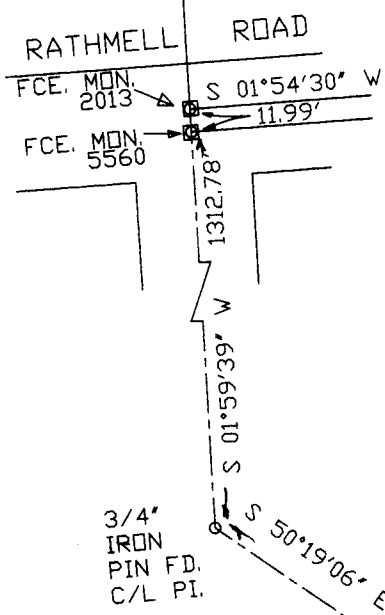

PRIOR DEED REFERENCE:
JODY E. SLOANE UNDIVIDED 3/18 INTEREST
MATHEW J. DILL UNDIVIDED 3/18 INTEREST
HEATHER J. DILL UNDIVIDED 3/18 INTEREST
ANDREW J. DILL UNDIVIDED 3/18 INTEREST
JONATHAN DILL UNDIVIDED 2/18 INTEREST
DAVID DILL UNDIVIDED 2/18 INTEREST
STEPHANIE DILL-FARRELL UNDIVIDED 2/18 INTEREST
INST.#200902250025698

TRACT TWO
56.1840 ACRES
(TAX DUP.= 60.34 ACRES)
A PORTION OF 150-000132

TRACT ONE
9.9575 ACRES

TRACT THREE
0.4900 ACRES
(TAX DUP.= 60.34 ACRES)
A PORTION OF 150-000132

BOUNDARY SURVEY
OF TRACT THREE 0.4900 ACRES IN
SEC-26, TWP-04, RGE-22,
HAMILTON TOWNSHIP, FRANKLIN COUNTY,
STATE OF OHIO:

FOR
JODY E. SLOANE et.al. (7)

AND OR
KENNETH E. ZWAYER

Louis Haines

354 Kessler Street
Groveport, Ohio 43125
Phone 637-2181

WE HEREBY CERTIFY THE PLAT SHOWN HEREON IS CORRECT AS SURVEYED BY US.
DATE: JAN 22 2011
SIGNED: *[Signature]*

ALL 3/4" IRON PIPE SET ARE 3/4" GALVANIZED IRON PIPE CUT TO 30" LENGTHS WITH AN ORANGE PLASTIC ID CAP INSCRIBED " HAINES SURV. "

ALL DEED, SURVEY, PLAN AND OTHER INFORMATION NOTED HEREON IS AVAILABLE FROM THE COUNTY AND STATE IN WHICH THIS SURVEY WAS PERFORMED.

COLUMBUS & SOUTHERN OHIO ELECTRIC COMPANY 6.936 ACRES
OLD SCIOTO VALLEY TRACTION CO. R/W
NORFOLK & WESTERN RAILROAD RIGHT-OF-WAY
C/L RAILROAD RIGHT-OF-WAY CENTER OF WEST BOUND RAILS

