

P.B. 27, P. 70
MANCHESTER PLACE
EXTENSION

MANCHESTER PLACE
R.B. 28, P. 1

MOUNTVIEW

ROAD

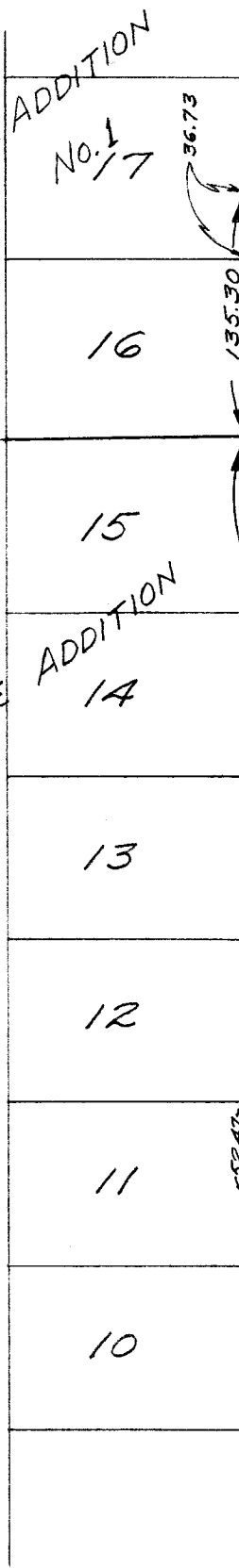

135.30
554.80
419.50
14°29'04"E
36.73

586°23'40"E 1218.77 ±

586°23'50"E 1258.43 ±

15.773 Ac.

555.55
30' 40'
76'
N00°23'30"E
ROAD
REED

Sheet 1 of 2

North Line TURKEY RUN ADDITION



Jan. 9, 1957
Scale 1" = 100'