

MILDEN

ROAD

50' Right-of-Way

26' Improvement

curb

66'

14'

10'

608.91 ft. to SOMERFORD ROAD.

40' Bldg. Line

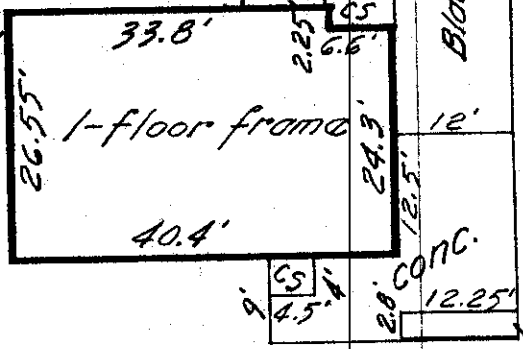

1-floor frame

wood tool shed

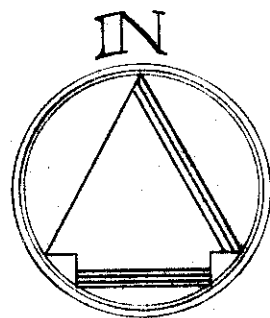

Aug. 30, 1966
Scale 1" = 20'

48'

18'

Lot 15
60'

Lot 16
60'

Block 276

5' Easement

66'

1981 MILDEN ROAD

City of Upper Arlington, Franklin County, Ohio.
Galbreath Mortgage Company.

Re: Eugene Green.

~ Blue Print Survey ~

I hereby certify that I have prepared the above plat from survey and inspection of herein described premises and existing conditions are as shown above. Being 48 ft. off the east side Lot 15 & 18 ft. off the west side Lot 16, NORTH MOUNTVIEW ADDITION, of record in P.B. 21, pg. 50, Recorder's Office, Franklin County, Ohio.

Harry L. Greene

30-08-66B

Harry L. Greene, Reg. Surveyor - No. 4058.