

S. TERRACE

ST.

50' Right-of-Way

26' Improvement

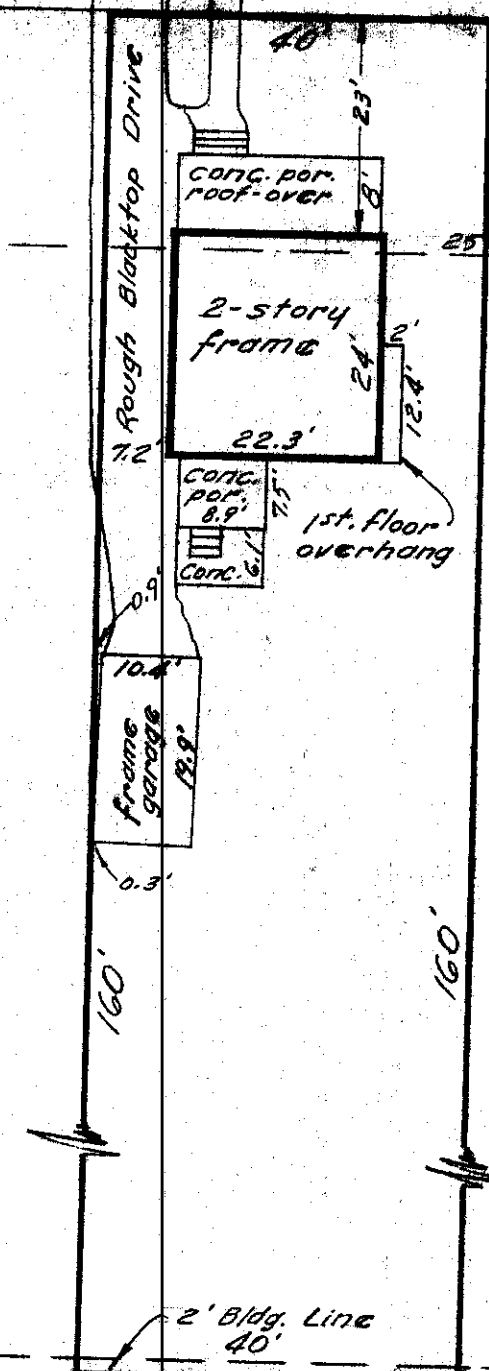
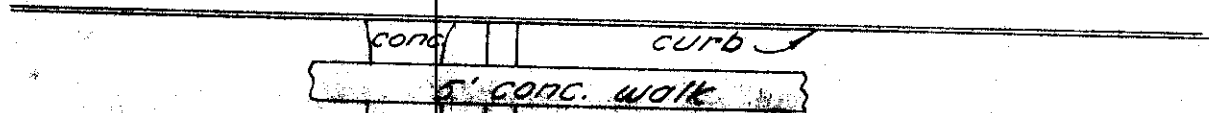

120.7 ft. to MOUND ST.

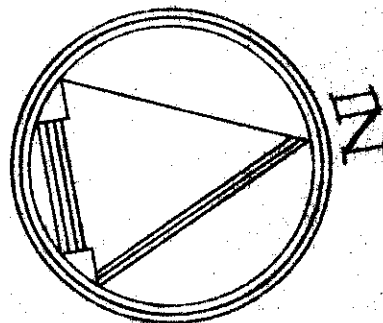

Jan. 31-1967
Scale, 1" = 20'

16' Alley

816 S. TERRACE ST.

City of Columbus, Franklin County, Ohio.

Salbreath Mortgage Company.

Re: James A. Matthews.

~ Blue Print Survey ~

I hereby certify that I have prepared the above plat from survey and inspection of herein described premises and existing conditions are as shown above.

Being Lot No. 322 of WESTLAND ADDITION EXTENSION, of record in Plat Book 18, Pg. 40, Recorder's Office, Franklin County, Ohio.

Harry L. Greene

Harry L. Greene, Reg. Surveyor - No. 4058.

31-01-67