

WEYDON

50' Right-of-Way

ROAD

27' Improvement

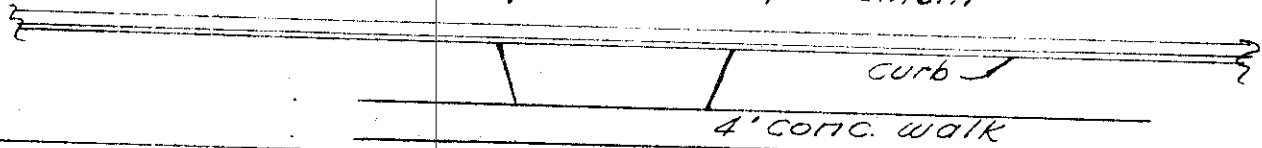

416.78' to HIGHGATE AVE.

80.0'

No Drive 34.5'

30' Bldg. Line

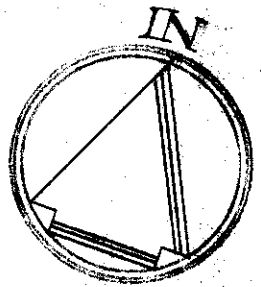
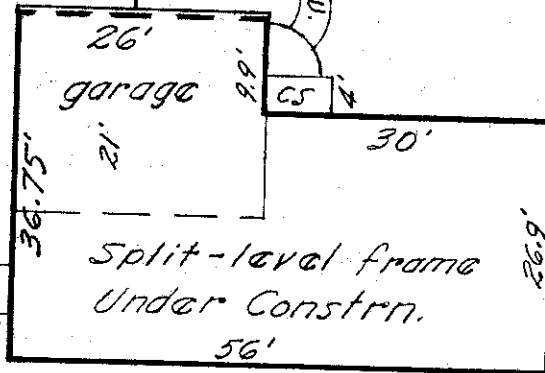

158.75'

179.05'

Oct. 25, 1965
Scale 1" = 20'

10' Easement

5' Easement

50.49'

20'

33.57'

293 WEYDON ROAD

City of Worthington, Franklin County, Ohio.
Galbreath Mortgage Company.
De: Rankin & Thoman.

Blue Print Survey

I hereby certify that I have prepared the above plat from survey and inspection of herein described premises and existing conditions are as shown above.

Being Lot No. 53 of WORTHINGWAY, of record in Plat Book 36, pgs. 92-93, Recorder's Office, Franklin County, Ohio.

Harry L. Greene

Harry L. Greene - Reg. Surveyor - No. 4058.

25-10-65 A