

May 18, 1959  
Scale - 1" = 20'

304.45' to  
south line  
Zollinger Rd.

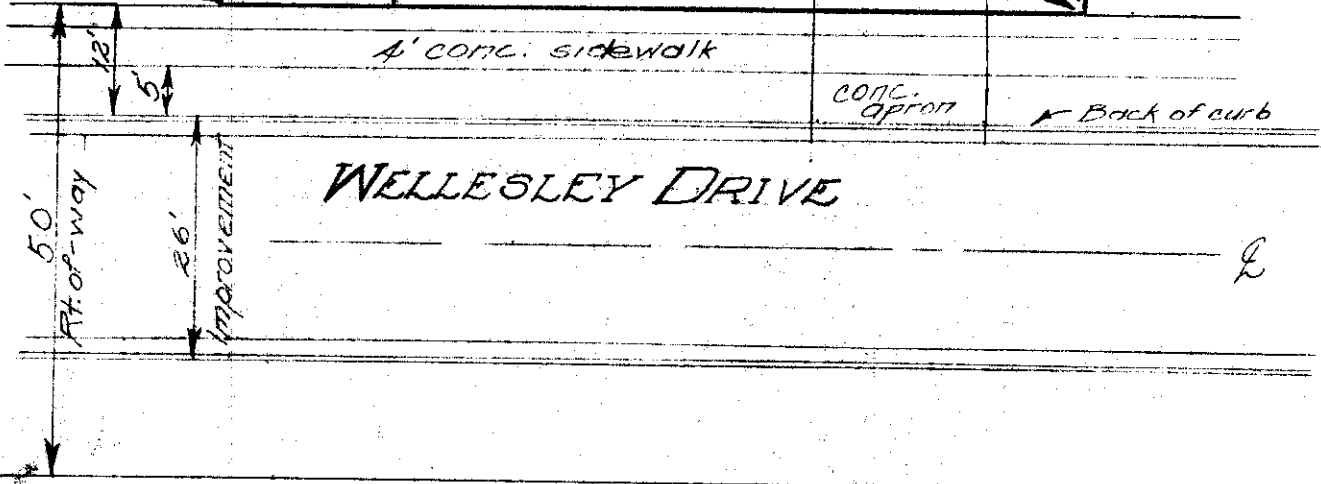

18-05-59A

2958 Wellesley Drive  
City of Upper Arlington, Franklin County, Ohio  
Galbreath Mortgage Company  
Re: Ross E. Kell.  
Blue Print Survey ~  
I hereby certify that I have prepared  
the above plat from survey and inspection  
of herein described premises and existing  
conditions are as shown above.  
Being Lot No. 24, of the WALLACE F.  
ACKLEY SUBDIVISION, of record in Plat Book  
25, page 19, Recorder's Office, Franklin  
County, Ohio.  
*Harry L. Greene*  
Harry L. Greene, Reg. Surveyor - No. 4058