

Houses both sides setback approx. 40 ft.

San. Sewer Tap -
 184'± N. of S. M.H.
 39.5'± S. of N. M.H.
 @ back of walk.

Water Tap -
 @ LOT, Curb Box
 between walk & curb.

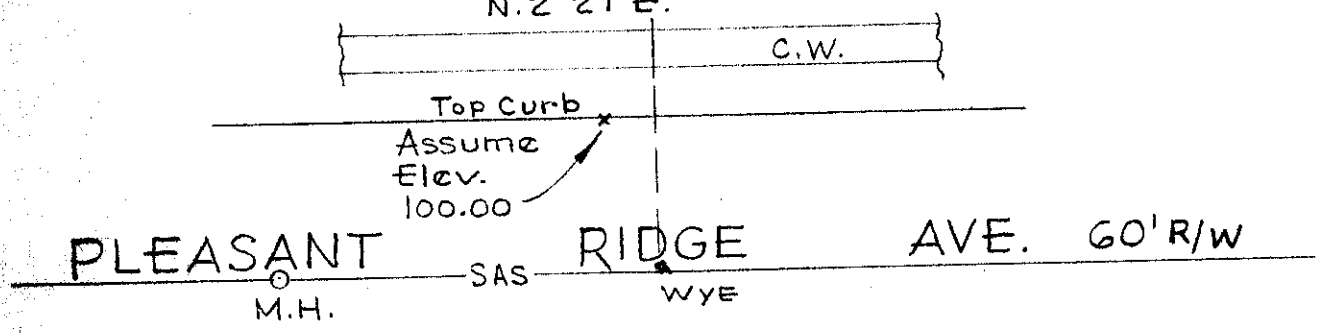

Aug. 11, 1976
 Scale 1" = 20'
 ○ = IRON PIN COR.

Survey showing 0.182 Ac., part of Lot 3, City of Bexley, Ohio, of Edward Livingston's Heirs' Subdivision, of record in Plat Book 2, Pg. 278, Recorder's Office, Franklin County, Ohio.

Harry L. Greene

Harry L. Greene, Reg. Surveyor - 4058.