

16' Alley

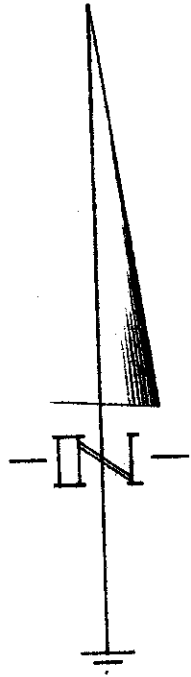
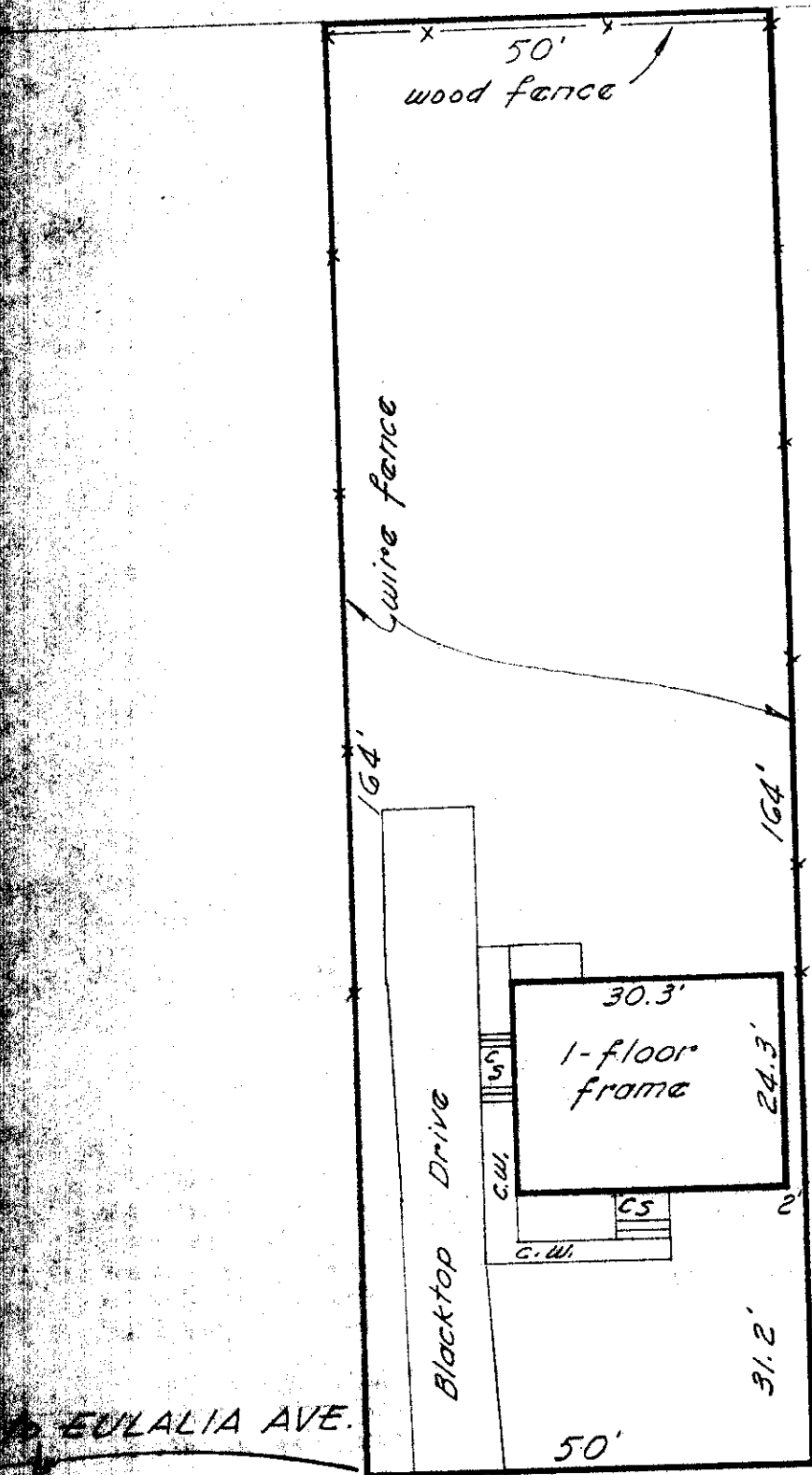

May 13 - 1968
Scale 1" = 20'

EULALIA AVE.

10'
5' conc. walk
curb

PAULINE AVE. 50'

1304 PAULINE AVE.
of Columbus, Franklin County, Ohio.
Death Mortgage Company.
Fred Houseberg.

Blue Print Survey
I hereby certify that I have prepared the above plat from
inspection of herein described premises and existing
conditions are as shown above.

Lot No. 316 of SCHONE-LAND SUBDIVISION, et
al, in Plat Book 18, pg. 21, Recorder's Office, Fran
lin County, Ohio.

Harry L. Greene
Harry L. Greene, Reg. Surveyor - No. 4058

