

Harry L. Greene, Surveyor

2160 Tremont Center, Columbus, Ohio 43221

PLAT SHOWING A 10' ft. TEMPORARY AND PERMANENT SANITARY SEWER EASEMENT OFF OF THE ENTIRE WESTERLY END OF LOT NO. 8 OF BELMONT PLACE AMENDED ADDITION, BLENDON TOWNSHIP, FRANKLIN COUNTY, CITY OF COLUMBUS, OHIO

PB. 18 Page 1 Recorders Office, Franklin County, Ohio.
Scale 1" = 50' Date February 12, 1988

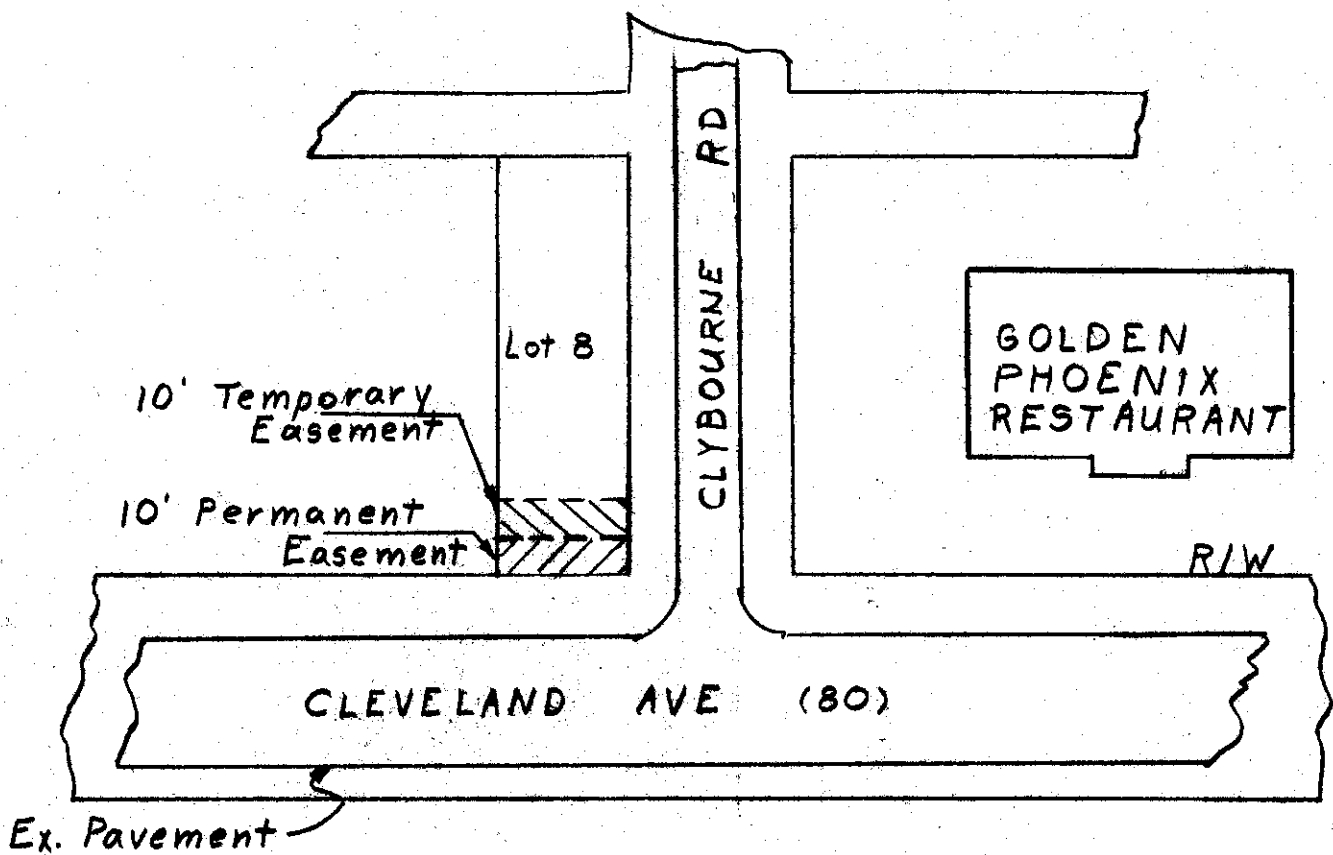
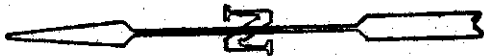

Harry L. Greene
Harry L. Greene, Registered Surveyor, No. 4058