

SURVEY PLAT

Plat showing survey of 17.625 Acre Tract,
located in Virginia Military Survey No. 1478,
Brown Township, Franklin County, Ohio

Scioto & Darby Creek Rd. (C.R. 29)

Franklin County Commissioners
0.902 ac. (Parcel 29-WD)
Inst. No. 200504070065056

Ref. P.O.B.

F.C.G.S.
#6664

RECEIVED

AUG 10 2021

Franklin County Engineer
Cornell R. Robertson, P.E., P.S.

Franklin County Commissioners
0.136 ac. (Parcel 78-WD)
Inst. No. 2004110030252955

1478.46' P.P.O.B. easement
N 52°45'54" E 1455.77'
S 52°45'54" W 1768.82'
Nasser H. Kashou &
Hussam H. Kashou, Trustees
10.000 Ac.
Inst. No. 201801050002709

15'
Ex. utility & drainage easement
Inst. No. 200306110175489

60.00'
PRINCIPAL PLACE
OF BEGINNING

Except as specifically stated or shown on
this plat, this survey does not purport to
reflect any of the following which may be
applicable to the subject real estate:
easements, other than possible easements
that were visible at the time of making
this survey; building setback lines;
restrictive covenants; subdivision res-
trictions; zoning or other land use
regulations, and any other facts that
an accurate and current title search
may disclose.

10.000 AC.

17.625 Ac.

J. and W. Chemlizer
77.71 Ac.
Inst. No. 200209050220551

Gary I. & Sophronia L.
Dever
158.221 Ac. Inst. No.
201411140152391

636.20'
20' drainage
easement
0.787 ACRES
0.985 ACRES (total)
N 52°45'54" E
1455.77'
N 37°54'18" W
387.76'
Edward L. & Amy L. Bryant
Inst. No. 200303280088907

20' drainage
easement
0.178 ACRES
0.985 ACRES (total)

S 52°45'54" W
20'

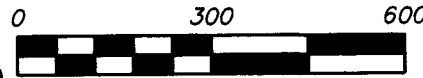
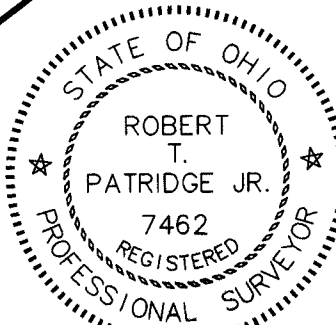

Scale 1" = 300'
August, 2020

Basis of bearings from O.R. 14468,
Pg. E08, based on the centerline
of Scioto & Darby Creek Rd. being
S 85° 00' 00" E.

LEGEND

- found iron pin
- ▼ found railroad spike
- ◆ found Franklin County Monument

I hereby certify that I have surveyed the property
described in the foregoing title caption, and that
said survey and plat are accurate and correct to
the best of my knowledge. Easements, restrictions,
and rights-of-way not located, unless noted.

Robert T. Patridge Jr.
Robert T. Patridge Jr.
Professional Surveyor No. 7462

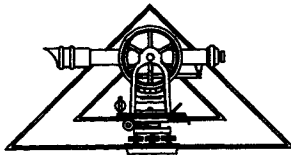

PATRIDGE
SURVEYING L.L.C.
9464 DUBLIN ROAD
POWELL, OHIO 43065
TEL. (614)-799-0031
FAX (614)-300-5076