

LEGEND

- | | | | |
|--------|--------------------------|-----|---------------------------|
| ● | 5/8" CAPPED IRON PIN SET | ⊙ | SANITARY MANHOLE |
| ○ | 5/8" IRON PIN FOUND | ⊖ | CLEAN OUT |
| ⊙ | 1" IRON PIPE FOUND | ⊕ | SANITARY SEWER |
| ▲ | NAIL SET | ⊖ | STORM MANHOLE |
| ▲ | NAIL FOUND | ⊕ | CATCH BASIN |
| ▲ | RR SPIKE SET | ⊖ | INLET |
| ▲ | BENCHMARK | ⊕ | YARD DRAIN |
| ▲ | UTILITY POLE | ⊖ | DOWN SPOUT |
| ▲ | GUY WIRE | ⊕ | TRAFFIC CONTROL CABINET |
| —UE— | UNDERGROUND ELECTRIC | ⊖ | TRAFFIC SIGNAL POLE |
| —E— | OVERHEAD ELECTRIC | ⊕ | SIGN |
| —HVAC— | HVAC UNIT | ⊖ | GUARD POST (PIPE BOLLARD) |
| —T— | TRANSFORMER | ⊕ | FLAG POLE |
| —GL— | GROUND LIGHT | ⊖ | FENCE |
| —EB— | ELECTRIC BOX | ⊕ | HARDWOOD TREE |
| —LP— | LIGHT POLE | ⊖ | CONTOUR LINES |
| —UT— | UNDERGROUND TELEPHONE | 801 | |
| —OT— | OVERHEAD TELEPHONE | 805 | |
| —TM— | TELEPHONE MANHOLE | | CONCRETE |
| —TP— | TELEPHONE PEDESTAL | | GRAVEL |
| —G— | GAS MAIN | | ASPHALT |
| —GV— | GAS VALVE | | LANDSCAPE AREA |
| —UC— | UNDERGROUND CABLE TV | | BRICK / PAVER |
| —WM— | WATER MAIN | | |
| —FH— | FIRE HYDRANT | | |
| —WV— | WATER VALVE | | |
| —WM— | WATER METER | | |
| —ICV— | IRRIGATION CONTROL VALVE | | |
| —WM— | WATER MANHOLE | | |

THE KLEINGERS GROUP

CIVIL ENGINEERING SURVEYING LANDSCAPE ARCHITECTURE

www.kleingers.com
350 Worthington Rd
Suite B
Westerville, OH 43082
614.882.4311

RECEIVED
JAN 20 2021
Franklin County Engineer
Curtis R. Roberson, P.E., P.S.

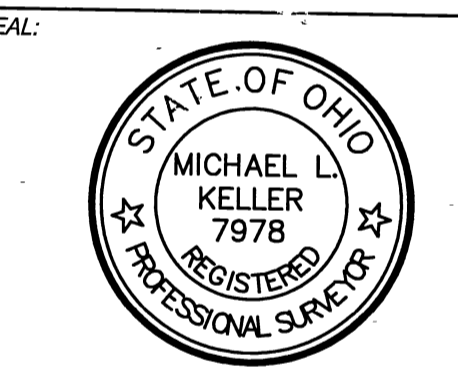

NO.	DATE	DESCRIPTION

NATIONAL CHURCH RESIDENCES STAFFORD WORTHINGTON OH

PART OF LOTS 3, 14 & 15
PLAT OF TOWN OF WORTHINGTON
PB 1 PG 456 (DESTROYED BY FIRE)
REPLATTED AS PB 3 PG 330
CITY OF WORTHINGTON,
FRANKLIN COUNTY, OHIO

PROJECT NO: 150491-008
DATE: 1/21/2021
SCALE: 1" = 20'

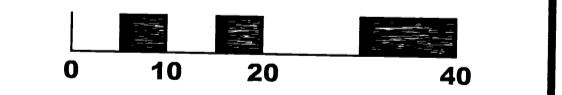

SHEET NAME:
BOUNDARY AND TOPOGRAPHIC SURVEY

SHEET NO.
1 OF 1

- NOTES**
- OCCUPATION IN GENERAL FITS SURVEY, WITH NO ENCROACHMENTS OVER THE PROPERTY LINES. THE DIMENSIONS FOR ADJOINING PROPERTY OWNED BY M.K. & K. REALTY, INC. DESCRIBED IN OR 8856 J-13, TRACT II AND IN 201612280178254, OVERLAPS THE SUBJECT PROPERTY AS SHOWN.
 - SOURCE DOCUMENTS AS NOTED.
 - ALL MONUMENTATION IS IN GOOD CONDITION UNLESS OTHERWISE NOTED.
 - BEARINGS ARE BASED ON THE STATE PLANE COORDINATE SYSTEM, OHIO SOUTH ZONE (NAD83-NSRS2007) WITH THE WESTERLY RIGHT-OF-WAY LINE OF HARTFORD STREET BEING S02°50'00"W AS DETERMINED BY A GPS SURVEY UTILIZING CORS STATION "COLB" AND MONUMENT "CIRCLE".
 - UTILITIES SHOWN ARE BASED ON PHYSICAL MARKINGS, PLAN INFORMATION PROVIDED BY UTILITY OWNERS, AND LOCATIONS OF ABOVE-GROUND APPURTENANCES. THE OHIO UTILITY PROTECTION SERVICE (OUPS) WAS CONTACTED ON AUGUST 26, 2015. OUPS TICKET NUMBER A523-801-478, A523-801-480, A523-801-219, A523-801-526, A523-801, 558 & A523-801-562.
 - THIS DRAWING IS BASED ON AN ACTUAL FIELD SURVEY PERFORMED BY THE KLEINGERS GROUP IN AUGUST, 2015 AND JANUARY, 2021.

I HEREBY CERTIFY THAT THIS PLAT IS BASED UPON A FIELD SURVEY MADE UNDER MY DIRECTION.

Michael L. Keller
MICHAEL L. KELLER
OHIO PROFESSIONAL SURVEYOR NO. 7978

1/21/2021
DATE



NOTE:
UNDERGROUND UTILITIES ARE PLOTTED FROM A COMPILATION OF AVAILABLE RECORD INFORMATION AND SURFACE INDICATIONS OF UNDERGROUND STRUCTURES AND MAY NOT BE INCLUSIVE. PRECISE LOCATIONS AND THE EXISTENCE OR NON EXISTENCE OF UNDERGROUND UTILITIES CANNOT BE VERIFIED. PLEASE NOTIFY THE OHIO UTILITY PROTECTION SERVICE AT 1-800-362-2764 BEFORE ANY PERIOD OF EXCAVATION OR CONSTRUCTION ACTIVITY.