

DEED REFERENCE
**BURTON LOUIS &
 CHRISTINE LEOLA SMITH**
 INSTR No. 2020

- (A) 2.1030 ACRES
 PARCEL No. 240-000176-00
- DB 3751 PG 152
- (B) 0.716 ACRE
 PARCEL No. 240-006433-00

BEARINGS ARE BASED ON A
 GPS OBSERVATION ON 11/13/20
 WGS 1984 GEODETIC NORTH.
 BEARING BETWEEN
 FCGS 0079 & FCGS 1224
 IS N 05°00'41" W

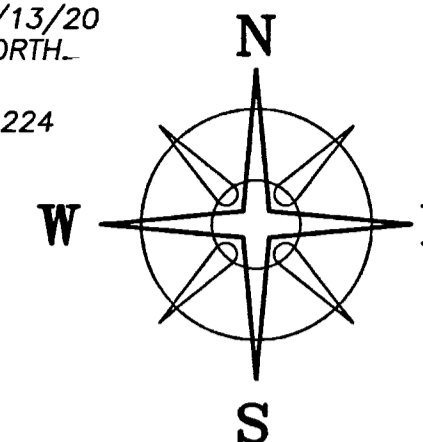

REBECCA K CASE, TRUSTEE
 INSTR No. 201801260010838
 THIRD & FOURTH PARCEL- SECOND TRACT
 INSTR No. 201801260010839
 SECOND & THIRD PARCEL- SECOND TRACT
 9.96 ACRES
 PARCEL No. 240-000176-00

REBECCA K CASE, TRUSTEE
 INSTR No. 201801260010838
 1/2 INTEREST-THIRD & FOURTH PARCEL- FIRST & THIRD TRACTS
 INSTR No. 201801260010839
 1/2 INTEREST-SECOND & THIRD PARCEL- FIRST & THIRD TRACTS
 24.004 ORG. ACRES
 PARCEL No. 240-000177-00

RECEIVED

NOV 18 2020

Franklin County Engineer
 Cornell R. Robertsour, P.E., P.S.

ALTON ROAD (CR-35, 50' R/W)

FCGS 1224
 N 05°00'41" W

VMS 12837/13245
 VMS 3243

S 89°47'28" E 460.15'

2.8192± ACRES
 0.2767± ACRES IN R/W

(A) 2.1030± ACRES

(B) 0.7162± ACRES

ROBERT A COLE, TRUSTEE
 OF THE DARBY TRUST
 INSTR No. 201609150124917
 1.00 ACRE
 240-000289-00

FCGS 0079
 S 87°12'35" E 471.90'

VMS 12837/13245

POB O'HARRA ROAD
 189.69'

N 87°12'35" W 451.69'

(CR-276, 50' R/W)

VMS 7068

VMS 3243

30' HIGHWAY EASEMENT
 COUNTY OF FRANKLIN
 D.B. 3750 PG 25

30' HIGHWAY EASEMENT
 COUNTY OF FRANKLIN
 D.B. 3622 PG 836

NOTES

VMS LINES SCALED FROM
 CENTERLINE SURVEY PLAT

LEGEND

- ALL MONUMENTS FOUND OR SET ARE IN
 GOOD CONDITION UNLESS OTHERWISE NOTED.
- ☒ MONUMENT BOX (FOUND)
 - ☐ IRON PIN (FOUND)
 - ⊙ 3/4" ⌀ IRON PIPE (FOUND)
 - ⊠ MAG NAIL SET OVER IRON PIN (FOUND)
 - MAG NAIL (SET)
 - ⊕ 5/8" ⌀ REBAR & YELLOW PLASTIC CAP
 STAMPED "COTTRILL SURVEYING" (SET)

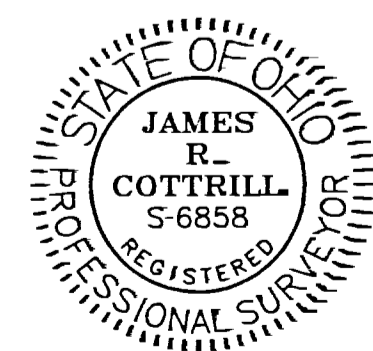

I HEREBY CERTIFY THAT THIS PLAT DEPICTS
 AN ACTUAL FIELD SURVEY PERFORMED BY
 JAMES R. COTTRILL, P.S. #6858
 DATE: 11/17/2020

COTTRILL SURVEYING, INC
 James R Cottrill, PS Nathan Cottrill, PE
 15882 US Route 62 NE, Mt. Sterling, Ohio 43143
 Office: (740) 869-3811 www.cottrillsurveying.com

**2.8192± ACRES,
 VMS 3243, PRAIRIE TOWNSHIP,
 FRANKLIN COUNTY, STATE OF OHIO.
 SURVEYED FOR SMITH.**

SCALE : 1" = 50'
 50' 25' 0 50'

JOB No. S201014 CREW: MW
 SURVEYED 11/13/20 DWN BY: NC
 DRAWN 11/13/20 CHECK: RC