

**ADJOINER DEED REFERENCE**

- 1 FRANKLIN COUNTY - OR 467B03 - 0.2901 ACRES (40-WD)
- 2 FRANKLIN COUNTY - OR 761D20 - 0.1002 ACRES (41-WD)
- 3 FRANKLIN COUNTY - OR 761D18 - 0.1379 ACRES (42-WD)

**DEED REFERENCE**  
**MICHAEL L SALAMONY**  
**INSTR No. 201410310144811**  
 PARCEL No. 120-000461-00  
**(A) 4.0488 ACRES**  
 4.149 ORG ACRES

BEARINGS ARE BASED ON A  
 GPS OBSERVATION ON 07/15/20  
 WGS 1984 GEODETIC NORTH.  
 CENTERLINE OF FEDER ROAD BETWEEN  
 FCGS 1774 AND FCGS 1776 IS  
 N 85°51'46" W

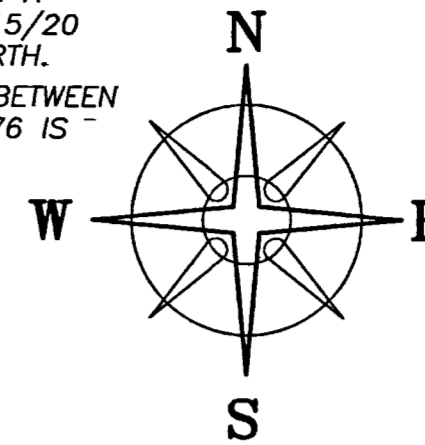

COLE ROAD

FCGS 1774

FEDER ROAD (80' WIDE)

N 85°50'19" W 304.68'

BEARS N 36°09'44" W 3.55'

S 85°51'46" E 108.99'

S 04°26'45" W 40.00'

N 85°51'46" W 1083.20'

FCGS 1776  
 POINT OF COMMENCEMENT

FCGS 1775

TPOB

THERESA E REINHARD  
 INSTR No 201101240011854  
 & DB 2731 P 232  
 3.7099 ACRES  
 4.000 ORG ACRES

**1.1152± ACRES**  
**(A)**

JACK W CUSTER  
 INSTR No 201408120104811  
 1.2391 ACRES  
 1.377 ORG ACRES

MICHAEL L SALAMONY  
 DB 2731 PG 230 &  
 IN 201410310144809  
 5.8735 ACRES  
 6.090 ORG ACRES

N 04°27'42" E 361.19'

S 04°26'45" W 299.88'

339.87'

BEARS N 37°44'22" W 3.51'

BEARS N 36°30'56" W 3.43'

S 85°52'02" E 150.00'

N 85°51'46" W 259.07'

61.32'

**(A)**

**LEGEND**

ALL MONUMENTS FOUND OR SET ARE IN GOOD CONDITION UNLESS OTHERWISE NOTED.

- IRON PIN (FOUND)
- 3/4" Ø IRON PIPE (FOUND)
- 7/8" Ø REBAR (FOUND)
- ⊙ RAILROAD SPIKE (FOUND) IN TREE STUMP
- ⊕ 7/8" Ø REBAR & ALUMINIUM CAP STAMPED "FRANKLIN COUNTY ENGINEERS" (FOUND)
- ⊕ 5/8" Ø REBAR & RED PLASTIC CAP STAMPED "LANDMARK SURVEYING" (FOUND)
- 5/8" Ø REBAR & YELLOW PLASTIC CAP STAMPED "COTTRILL SURVEYING" (SET)

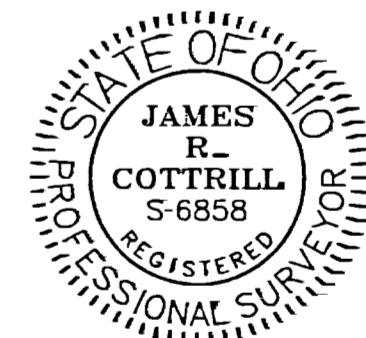

I HEREBY CERTIFY THAT THIS PLAT DEPICTS AN ACTUAL FIELD SURVEY PERFORMED BY JAMES R. COTTRILL, P.S. #6858  
 DATE: 7/17/2020

**COTTRILL SURVEYING, INC**

James R Cottrill, PS Nathan Cottrill, PE  
 15882 US Route 62 NE, Mt. Sterling, Ohio 43143  
 Office: (740) 869-3811 www.cottrillsurveying.com

**1.1152± ACRES,**  
**VMS 3445, BROWN TOWNSHIP,**  
**FRANKLIN COUNTY, STATE OF OHIO.**  
**SURVEYED FOR SALAMONY.**

SCALE = 1" = 60'	JOB No. S200622	CREW: NC
60' 30' 0' 60'	SURVEYED 07/15/20	DWN BY: NC
	DRAWN 07/16/20	CHECK: RC

**RECEIVED**

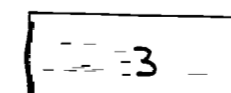

Franklin County Engineer  
 Cornel H. Robertson, P.E., P.S.