

GRAPHIC SCALE
 (IN FEET)
 1 Inch = 50 ft.



IBI GROUP
 8101 North High Street, Suite 100
 Columbus OH 43235 USA
 tel 614 818 4900 fax 614 818 4901
 ibigroup.com

SUBMISSION:

REVISION:

STAMP:

LOWERY ASSET MANAGEMENT
 G.L. LOWERY
 INDUSTRIAL PARK
 GROVEPORT, OHIO

FIELD	DRAFT	CHECK
EM	DC	DC

M-E NO.: 07-166

DATE: OCTOBER 2020

SCALE:
 HORIZONTAL: 1"=50'
 VERTICAL:

SHEET TITLE:

BOUNDARY SURVEY

SHEET NO.:

BEDROCK PROPERTY HOLDINGS LLC
 I.N. 201911270159632
 24.063 ACRES

I.N. 199912220313236
 EXHIBIT "B" PARCEL 1
 1.670 ACRES

G.L. LOWERY INDUSTRIAL PARK
 P.B. 48, PG. 48

I.N. 199912220313236
 REMAINDER LOT 5
 PID 185-001169
 PARCEL No. 1
 2.833 ACRES

LOWERY ASSET MANAGEMENT
 LIMITED PARTNERSHIP
 I.N. 199912220313236
 1.760 ACRES
 PARCEL No. 3
 PID 185-001416

MOTTS MILITARY MUSEUM, INC.
 I.N. 200708310154011
 3.169 ACRES

MOTTS MILITARY MUSEUM, INC.
 O.R.V. 19112, PG. 107
 3.965 ACRES

REFERENCE POINT
 2.833 ACRES

TRUE PLACE
 OF BEGINNING
 2.833 ACRES

STATE OF OHIO,
 COUNTY OF FRANKLIN,
 CITY OF GROVEPORT
 SECTION 21, TOWNSHIP 11
 RANGE 21, CONGRESS LANDS

BEARING REFERENCE
 BEARINGS ARE BASED ON SOUTH 03°00'00"
 WEST FOR HAMILTON ROAD AS REFERENCED ON
 THE G.L. LOWERY INDUSTRIAL PARK PLAT.

LEGEND

- IRON PIN SET
 1" O.D. PIPE 30" LONG
 "M-E COMPANIES/S-6872"
- ⊙ IRON PIN FOUND (CAPPED/SIZE AS NOTED)
- ⊗ REBAR FOUND
- MAG NAIL SET

David Chiesa 10/27/20
 REGISTERED SURVEYOR NO. 7740

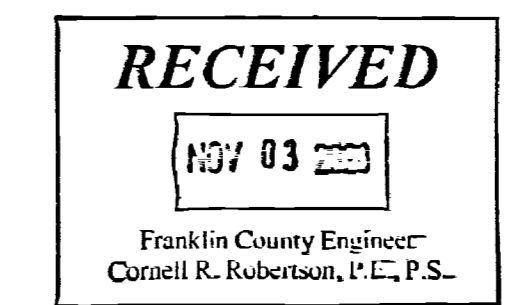
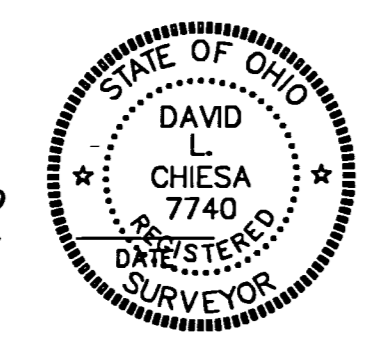

FCGS 226Z
 CORBETT ROAD

