

BASIS OF BEARINGS: Basis of bearings is the centerline of W. Waterloo Street, being S 85° 36' 35" E, derived from VRS observations referencing monument, PID designation of AJ7184 and CORS_ID of COLB. Ohio South Zone, NAD 83 (2011 Adj.), and all other bearings are based upon this meridian.

3/4" I.D. Iron Pipe Set, 30" in length, w/Cap Stamped "BIRD & BULL, INC." Unless Otherwise Shown.

**EXHIBIT OF A 0.463 ACRE TRACT
BEING THE RIGHT-OF-WAY OF W. WATERLOO STREET,
EAST OF GENDER ROAD,
CANAL WINCHESTER, FRANKLIN CO., OHIO
(S. 24, T. 11 N., R. 21 W., CONGRESS LANDS)**

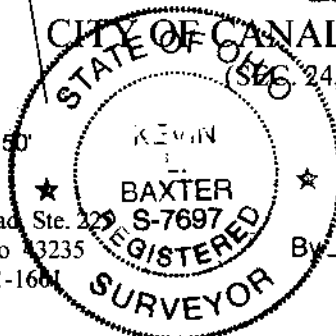

Kevin L. Baxter
Kevin L. Baxter ~ Ohio Surveyor No. 7697

OCTOBER 26, 2017

SCALE: 1" = 150'

3500 Snouffer Road, Ste. 229
Columbus, Ohio 43235
Ph: (614) 761-1600

RECEIVED

OCT 25 2017



Franklin County Engineer

SCALE: 1" = 120'



GRAPHIC SCALE