

RECEIVED

FEB 21 2020

T-8-2



Evans, Mechwart, Hambleton & Tilton, Inc.
Engineers • Surveyors • Planners • Scientists
5300 New Albany Road, Columbus, OH 43054
Phone: 614.775.4500 Toll Free: 888.775.3448
emht.com

SURVEY OF ACREAGE PARCEL
FARM LOT 8, QUARTER TOWNSHIP 3, TOWNSHIP 2, RANGE 16
UNITED STATES MILITARY DISTRICT
CITY OF NEW ALBANY, COUNTY OF FRANKLIN, STATE OF OHIO

Date: February 20, 2020

Job No: 2019-1324

Scale: 1" = 100'



GRAPHIC SCALE (in feet)

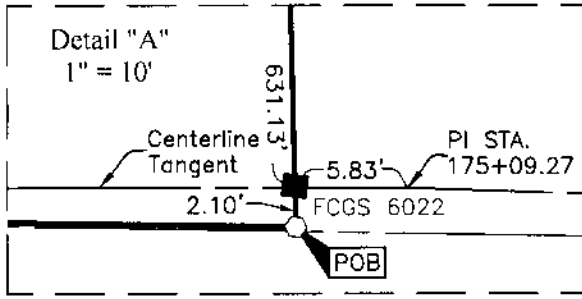

WILLIAM A. MORSE, TR
147 AC. PARCEL 1 (DEED)
I.N. 200901160006635
I.N. 201912040163337

- 0.907 AC. GROSS
- 0.138 AC. P.R.O.
- DUBLIN-GRANVILLE ROAD
- 0.370 AC. P.R.O. HARLEM ROAD
- 0.399 AC. NET

WILLIAM T. TAYLOR
D.B. 160, P. 239
P.N. 222-002059

Highway Easement
D.B. 1797, P. 419

Highway Easement
D.B. 735, P. 405

DUBLIN-GRANVILLE ROAD
(I.C.H. 546 SEC. C2 & NEW
ALBANY) (FRA-161-18.91)

$\Delta=0^{\circ}27'24"$
 $R=14191.83'$
 $Arc=113.09'$
 $ChB=N83^{\circ}19'00"E$
 $ChD=113.09'$

$\Delta=0^{\circ}30'15"$
 $R=14191.83'$
 $Arc=124.91'$
 $ChB=S83^{\circ}47'50"W$
 $ChD=124.90'$

JAMES R. PIERCE, II
0.743 AC. (DEED)
I.N. 200708220147963

JENNIFER L. YOUNG
0.923 AC. PARCEL I (DEED)
I.N. 201306070094812

FRANKLIN W. KNORE AND
BECKIE LEE KNORE
1.689 AC. (DEED)
D.B. 3378, P. 662
I.N. 200202190044929

CARRIE MCMILLIN
1.507 AC. (DEED)
I.N. 200912150180920

DONALD T. RANNEY
2.451 AC. (DEED)
O.R. 7328J17
O.R. 7328J19
O.R. 7329A01
O.R. 7329A03
O.R. 7329A05
O.R. 7329A07
O.R. 10889G10

J:\2019\1324\DWG\045HEETS\BOUNDARY\2019\1324-VS-BNDY-D3.DWG plotted by KING, HEATHER on 2/21/2020 9:41:17 AM last saved by KING on 2/21/2020 9:41:03 AM Xrefs:

BASIS OF BEARINGS:

The bearings shown hereon are based on the Ohio State Plane Coordinate System, South Zone, NAD83 (2007). Said bearings originated from a field traverse which was tied (referenced) to said coordinate system by GPS observations of Franklin County Engineering Department monuments FRANK 78, FCGS 8815, FCGS 8814, FCGS 8813, FCGS 6624 RESET and FCGS 6675. The portion of the centerline of Dublin-Granville Road, having a bearing of South 83° 05' 18" West and monumented as shown hereon, is designated as the "basis of bearings" for this survey.

SURVEY NOTE:

This survey was prepared using documents of record, prior plats of survey, and observed evidence located by an actual field survey.

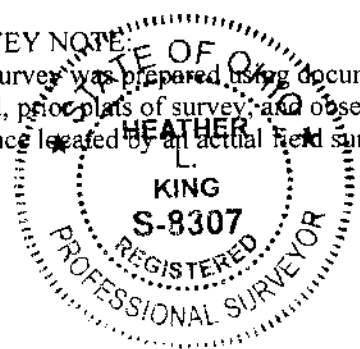

By Heather L. King 2/21/20
Heather L. King Date
Professional Surveyor No. 8307