

NORTH

GRAPHIC SCALE

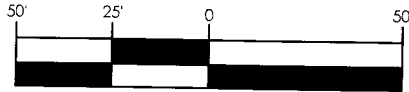

1" = 50'

SURVEYOR'S NOTES

- 1) BASED ON RECORDS ON FILE AT THE FRANKLIN COUNTY RECORDER'S OFFICE AND THE FRANKLIN COUNTY ENGINEER'S OFFICE.
- 2) REFERENCES: DOCUMENTS NOTED HEREON.
- 3) BEARINGS ARE BASED ON THE OHIO STATE PLANE COORDINATE SYSTEM - OHIO SOUTH ZONE (NAD83) BY GPS OBSERVATION, WITH THE BEARING FROM THE POINT OF BEGINNING TO FRANKLIN COUNTY MONUMENT NRMM 264 OF S87°08'15"W AS THE BASIS OF BEARINGS FOR THIS SURVEY.
- 4) ALL IRON PINS SET ARE 3/4" INSIDE DIAMETER IRON PIPES, 30" IN LENGTH WITH A 1" DIAMETER YELLOW CAP STAMPED "SANDS DECKER."

- IRON PIN FOUND
- IRON PIN SET
- ▲ MAG NAIL SET
- △ FRANKLIN COUNTY MONUMENT

CERTIFICATION

THIS DRAWING IS REPRESENTATIVE OF AN ACTUAL FIELD SURVEY PERFORMED UNDER MY DIRECT SUPERVISION IN APRIL, 2019. THIS DRAWING IS REPRESENTATIVE OF A BOUNDARY SURVEY IN CONFORMANCE WITH OAC 4733-37 STANDARDS FOR BOUNDARY SURVEYS.

SANDS DECKER OPS

STEVEN W. NEWELL  
OHIO PROFESSIONAL  
SURVEYOR 7212

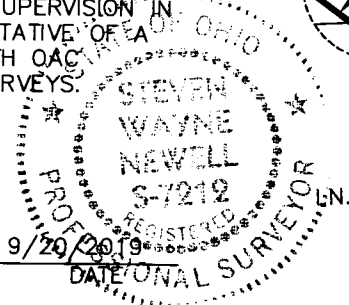

**SURVEY EXHIBIT OF PROPOSED  
1.039 ACRE TRACT**  
PART OF LAND OF ECHO/CONTINENTAL LINCOLN VILLAGE, LLC  
TOWNSHIP OF PRAIRIE, COUNTY OF FRANKLIN, STATE OF OHIO  
PART OF RESERVE L OF LINCOLN VILLAGE



OFFICES

128 East Main Street  
Logan, Ohio 43138  
740-385-2140

1495 Old Henderson Road  
Columbus, Ohio 43220  
614-459-6992

507 Main Street  
Zanesville, Ohio 43701  
740-450-1640

