

LEGEND:

- IRON PIN SET - 5/8" X 30" REBAR WITH A PLASTIC CAP INSCRIBED "JON ADCOCK S-8461."
- ⊙ IRON PIPE FOUND (AS NOTED)
- ⊗ IRON PIN FOUND (AS NOTED)
- ⊗ AXLE FOUND

PLAT OF SURVEY

0.061 ACRE TRACT
SITUATED IN A
0.703 ACRE TRACT

SHARON TOWNSHIP, FRANKLIN COUNTY, OHIO

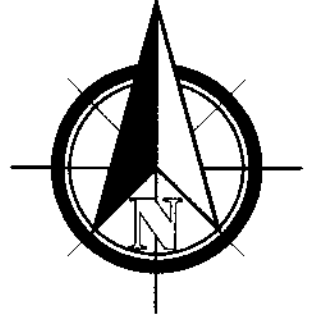
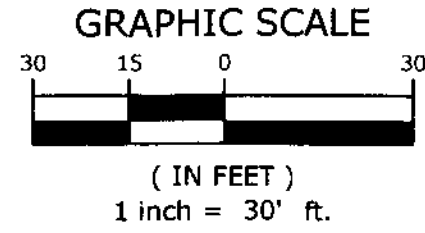

BASIS OF BEARINGS:

BEARINGS SHOWN HEREON ARE BASED ON A BEARING OF S 68° 59' 10" E FOR THE SOUTHERLY LINE OF EDGE CLIFF DRIVE AS DERIVED FROM GPS OBSERVATIONS, BEING THE OHIO STATE PLANE COORDINATE SYSTEM, SOUTH ZONE, NAD 1983.

NOTES:

1. ALL PERTINENT DOCUMENTS USED FOR THIS BOUNDARY SURVEY ARE AS SHOWN HEREON.
2. IN GENERAL, ALL EVIDENCE OF OCCUPATION FOUND ALONG BOUNDARY LINES AGREES WITH THE LINES CITED IN THE DEEDS.

CERTIFICATION:

I HEREBY CERTIFY THAT THIS PLAT OF SURVEY IS BASED ON AN ACTUAL FIELD SURVEY PERFORMED IN AUGUST OF 2019 AND MEETS ALL OF THE REQUIREMENTS FOR A BOUNDARY SURVEY AS SET FORTH IN THE OHIO ADMINISTRATIVE CODE CHAPTER 4733-37.

[Signature] 8461 8/21/19
JON B. ADCOCK OHIO REG. No. DATE

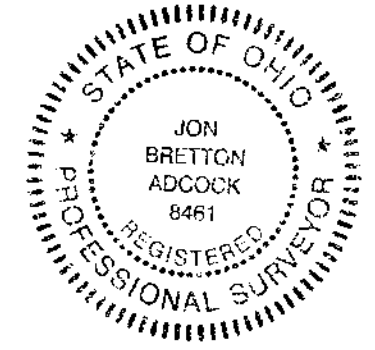

FIELD	DRAFT	CHECK
JBA	JBA	JBA
JOB NO.: 19-064-1		
DATE: AUGUST 17, 2019		
SCALE: 1"=30'		
SHEET NO.:		1/1

KAREN E. FASS
INST. No. 201210160155655
PARCEL 2
0.703 ACRE
AUD. PAR. 250-004825-00

(PARK)

AXLE FND.

EDGE CLIFF DRIVE (35')

N2° 19' 28"E
42.53'

0.061 ACRE

N87° 44' 45"W

132.26'

125.29'

PLACE OF BEGINNING
0.061 ACRE TRACT

BLUE SPRUCE DRIVE (35')

PLUM TREE DRIVE (35')

MOUNT AIR No.2 SUBDIVISION
PLAT BOOK 19, PAGE 21

LAURA A. KUNZE
INST. No. 201110170132258

1267

1268

1269

1270

1271

1272

1273

1/2"

1/2"

18.83'

RECEIVED

AUG 26 2019

Franklin County Engineer
Cernell R. Robertson, P.E., P.S.



Focused
on
Excellence

1346 Hemlock Court N.E., Lancaster, Ohio 43130
Contact: Brett Adcock
740-654-0600
Fax: 740-654-0604
www.americanlandsurveyors.com