

CRAWFORD, MURPHY & TILLY

FOR

PARCEL 1-WD

QUARTER TOWNSHIP 2, TOWNSHIP 1, RANGE 17
UNITED STATES MILITARY LANDS

CITY OF COLUMBUS
FRANKLIN COUNTY, OHIO



DATE: 06/28/19	JOB NO: 17-002
SCALE: 1"=30'	P.B. NO:
REVISED:	MAP NO:
DRAWN BY: RNS	
CKD BY: GJK	
CAD FILE: 17_002	



PROFESSIONAL SERVICES LTD
3354 E. BROAD STREET, STE C
COLUMBUS, OH 43213
PH: 614-238-9080 FAX: 614-238-9279
XYZ@XYZPROFESSIONALSERVICES.COM

EXHIBIT 1-WD

CASSADY AVENUE (80')

PLAT BOOK 38 PAGE 15

2460-2466 CASSADY AV

OWNER: KWK INVESTMENTS
PID #: 010-137509-00
INSTR# 200406150137496
0.327 AC

3140 AGLER RD

OWNER: KWK INVESTMENTS LLC
PID #: 010-110997-00
INSTR# 200406140136328
0.652 ACRES

3146 AGLER RD

OWNER: COLUMBUS CHRISTIAN CENTER
PID #: 010-137508-00
INSTR# 199901120008064
1.069 AC

OWNER: CITY OF COLUMBUS
INSTR# 200009010176510
0.231 AC

PERMANENT EASEMENT:
CITY OF COLUMBUS
INSTR# 200601200015223
0.005 AC

STA 26+81.61
41.00 LT

STA 25+32.23
46.20 LT

S 41°35'52"E 7.39'

STA 25+37.43
41.00 LT

S 86°18'10"E 144.19'

1-WD 0.141 ACRES TOTAL
(6133.88 S.F.)

PRO=0.091 ACRES
(3963.96 S.F.)

AGLER RD (50')

STA 26+81.85

N 86°18'10"W 149.20'

N 3°06'26"E 46.20'

P.O.B.

FCGS
MON 3351
S 86°18'10"E 1532.65'

BASIS OF BEARING:
BEARINGS SHOWN ARE BASED ON THE OHIO STATE PLANE COORDINATE SYSTEM, SOUTH ZONE, NAD 83 (CORS96). SAID BEARINGS ORIGINATED FROM A FIELD TRAVERSE WHICH WAS REFERENCED TO SAID COORDINATE SYSTEM BY GPS OBSERVATIONS AND OBSERVATIONS OF SELECTED STATIONS IN THE OHIO DEPARTMENT OF TRANSPORTATION VIRTUAL REFERENCE STATION NETWORK. THE PORTION OF THE CENTERLINE OF AGLER RD (WIDTH VARIES), HAVING A BEARING OF S 86°18'10" E AND MONUMENTED BY FCGS 3351 AND 4459, IS DESIGNATED THE "BASIS OF BEARING."
BASIS OF STATIONING SET AT 10+00.00 AT AN ALUMINUM CAP STAMPED "FCGS 3351" IN PVC ENCASED CONCRETE MONUMENT INSIDE A ROAD MONUMENT BOX AT THE INTERSECTION OF AGLER RD AND SUNBURY RD.

CERTIFICATION:
DISTANCES ARE SHOWN IN FEET AND DECIMAL PARTS THEREOF.
AND TO THE BEST OF MY KNOWLEDGE, AND PERSONAL BELIEF, ALL INFORMATION HEREON I STATE TO BE CORRECT.
IRON PINS SET ARE 5/8" DIAMETER IRON REBAR 30" LONG WITH PLASTIC CAP INSCRIBED BKJ 7343

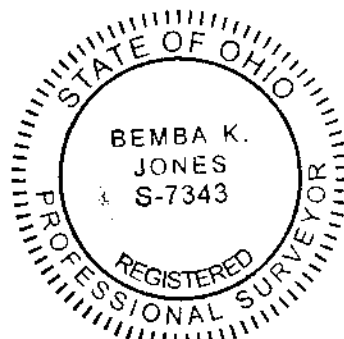

LEGEND

- LINE BREAK
- PK FOUND
- IRON PIN SET
- DRILL HOLE FOUND
- PK/MAG SET
- IRON PIN FOUND
- MONUMENT BOX FOUND

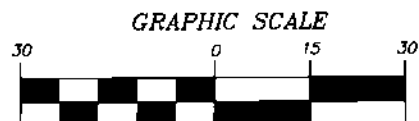

(IN FEET)
1 inch = 30 ft.

DATE: 06/28/19

BEMBA K. JONES
REGISTERED SURVEYOR NO. 7343