



Evans, Mechwart, Hambleton & Tilton, Inc.  
 Engineers • Surveyors • Planners • Scientists  
 5500 New Albany Road, Columbus, OH 43054  
 Phone: 614.775.4500 Toll Free: 888.775.3648

emht.com

# SURVEY OF ACREAGE PARCEL

## VIRGINIA MILITARY SURVEY NO. 6115

### CITY OF GROVE CITY, COUNTY OF FRANKLIN, STATE OF OHIO

Date: October 10, 2018

Scale: 1" = 60'

Job No: 2017-1174

Revised: April 1, 2019

CURVE TABLE					
CURVE	DELTA	RADIUS	ARC	CH. BEARING	CH. DIST.
C1	35°22'30"	48.00'	29.64'	N53°08'14"W	29.17'

**SURVEY NOTE:**

This survey was prepared using documents of record, prior plats of survey, and observed evidence located by an actual field survey.

**BASIS OF BEARINGS:**

The bearings shown hereon are based on the Ohio State Plane Coordinate System, South Zone, NAD83 (2011). Said bearings originated from a field traverse which was tied (referenced) to said coordinate system by GPS observations and observations of selected CORS base stations in the National Spatial Reference System. The portion of the centerline of Borror Road, also being the common line of Virginia Military Survey Numbers 6115 and 6840, having a bearing of North 74° 40' 36" East, is designated as the "basis of bearings" for this plat.

Ⓐ CITY OF GROVE CITY,  
 FRANKLIN COUNTY, OHIO  
 I.N. 200208190203832  
 P.N. 040-011308  
 8.95 AC. (AUDITOR)  
 GRANT RUN ESTATES  
 SECTION 1  
 P.B. 97, P. 89  
 RESERVE "A"

- = STONE FND.
- = MON. FND.
- = I.P. FND.
- = I.P. SET
- = MAG. NAIL FND.
- = MAG. NAIL SET
- ▲ = R.R. SPK. FND.
- △ = R.R. SPK. SET
- = P.K. NAIL FND.

LARRY C. HINTON  
 JOYCE E. HINTON  
 10.857 AC. (DEED)  
 O.R. 25523113  
 P.N. 040-006835  
 10.65 AC. (AUDITOR)

STEVEN D. CASA  
 DEBORAH L. CASA  
 1.740 AC. (DEED)  
 O.R. 22010A13  
 P.N. 040-008031  
 1.56 AC. (AUDITOR)

LINE TABLE		
LINE	BEARING	DISTANCE
L1	S02°29'42"W	55.71'



GRAPHIC SCALE (in feet)

I.P. Set are 13/16" I.D. iron pipes  
 30" long with cap inscribed EMHT INC.

By   
 John C. Dodgion  
 Professional Surveyor No. 8069

04/01/2019  
 Date

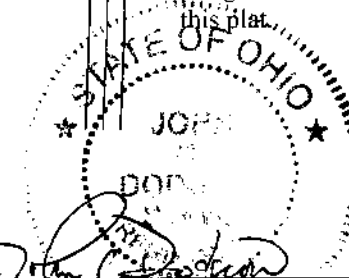

RECEIVED

APR 08 2019

J:\2017\1174\DWG\DSHEETS\BOUNDARY\0\_145 AC 2017\1174-VS-BNDY-04.DWG plotted by GEIGER, STEVEN on 4/1/2019 4:25:49 PM last saved by SGEIGER on 4/1/2019 4:25:31 PM  
 Xrefs: GRADMG 7-30-18.DWG