

LEGEND

- 5/8" IRON PIN (SET) WITH PLASTIC CAP STAMPED "McCARTY ASSOCIATES"
- 5/8" IRON PIN (FOUND)
- ⊕ SPIKE (FOUND) UNDER PAVEMENT
- ⊕ 1/4" IRON PIPE (FOUND)
- ⊕ 4" STEEL POST (FOUND)
- 3/4" IRON PIPE (FOUND)
- MAG NAIL (FOUND)
- MAG NAIL (SET)
- ⊠ MONUMENT BOX (FOUND)
- STONE (FOUND)
- x- WOVEN WIRE FENCE GENERALLY ON OR NEAR LINE UNLESS SHOWN OTHERWISE
- BOARD FENCE
- △ McCARTY ASSOCIATES GEODETIC SURVEY MONUMENT "PATTERSON (2701)" 5/8" IRON PIN (SET) WITH PLASTIC CAP STAMPED "McCARTY TRAVERSE"

(A) HARRY R. McDERMITT, TRUSTEE
INSTR. No. 199805130116813
PARCEL #2
6.262 Ac.

(B) BETHANY MEGAN STAINES
INSTR. No. 201703140035483
2.488 Ac.

(C) BARBARA A. HOOVER
TOD TO
CRAIG H. HOOVER
AND
CHRIS H. HOOVER
INSTR. No. 200803270046811
2.00 Ac.
S.R. J-9954

(D) FRANKLIN T. CORY
AND
KAREN M. CORY
O.R. 17655, PAGE B12
1.387 Ac.

(E) CYNTHIA MARIE NORDEN
AND
TIMOTHY A. MOORE
O.R. 10857, PAGE A03
5.002 Ac.
S.R. BROWN O-7-D

(F) BRIAN J. BENEVILLE
AND
LORI A. BENEVILLE
INSTR. No. 20091190166593
5.001 Ac.

(G) STEPHEN J. WEBER
O.R. 33275, PAGE D20
7.545 Ac.
S.R. BROWN 176 357 300

(H) STEPHEN E. YODER
AND
NICOLE M. YODER
INSTR. No. 201406060070472
5.057 Ac.
S.R. 76 357 300

(I) STEPHEN E. YODER, JR.
AND
NICOLE M. YODER
INSTR. No. 201406060070500
5.387 Ac.
S.R. 76 357 300

(J) CHARLES R. DERE
AND
STACY L. MEYER
INSTR. No. 201310090171777
5.366 Ac.

VOLUME _____ PLAT NO. _____
FRANKLIN COUNTY ENGINEER'S
RECORD OF LAND SURVEYS
DATE NOVEMBER 20, 2018
SCALE 1"=400'
DEED REFERENCE
OFFICIAL RECORD 18630 H19
TOWNSHIP BROWN
MILITARY SURVEY NUMBERS 882 & 5985

BEARINGS ARE BASED UPON THE GRID AZIMUTH (AZ 289°21'47") BETWEEN NATIONAL GEODETIC SURVEY CORS STATION "COLB" AND MCCARTY ASSOCIATES GEODETIC SURVEY MONUMENT "PATTERSON (2701)" AND DERIVED FROM GPS OBSERVATIONS TAKEN NOVEMBER 2, 2018, UTILIZING THE TRIMBLE ODOT CORS VRS (VIRTUAL REFERENCE SYSTEM).

WITH A LOCALIZED BEARING OF S 56°38'46" W PATTERSON ROAD (RR9, PAGE 60) BETWEEN (FRANKLIN COUNTY CENTERLINE MONUMENTS) FCGS 1321 AND FCGS 6105.

DEED REFERENCE:

DAVID C. SAYRE
AND
TERESA L. SAYRE
O. R. 8630, PAGE H19
PARCEL No. 2
FIRST PIECE
10 Ac.
PT. LOT No. 6 OF
JOSEPH O'HARRA HEIRS PARTITION
SUPERIOR COURT REC. 8, PAGE 179

SECOND PIECE
55 Ac.
PT. OF LOT No. 7 OF THE
JOSEPH O'HARRA HEIRS PARTITION
SUPERIOR COURT REC. 8, PAGE 179
PT. OF LOT No. 7 OF THE
BAILEY PARTITION, D.B. 111, PAGE 179
PART OF THE WILL OF
GIDEON ARMANTROUT
RECORD OF WILL P, PAGE 214

REMAINDER OF
THIRD PIECE
ORIG. 20 Ac., 57 POLES
PT. OF LOT No. 7 OF THE
BAILEY PARTITION, D.B. 111, PAGE 179
PART OF THE WILL OF
GIDEON ARMANTROUT
RECORD OF WILL P, PAGE 214
ALSO 1/2 Ac.

FIRST PARCEL
19 14/100 Ac.
SECOND PARCEL
WEST 1/2 OF 19 14/100 Ac.
THIRD PARCEL
30 3/4 SQ. RODS
P.N. 120-000109-00

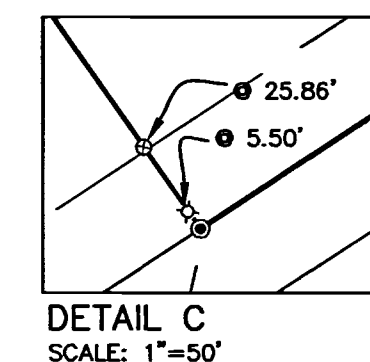

NAME	NAD 83 (2011)		ELLIPSOID HEIGHT	OHIO STATE PLANE NORTHING	COORDINATES NAVD 88 EASTING	NAV D ELEVATION
	LATITUDE	LONGITUDE				
SO 23 FRA CO PIC CO	39°48'30.26208"N	83°08'57.57350"W	754.450	659316.5947	1786083.7506	864.499
	RESIDUALS		ΔH = 0.072 SFT		ΔV = -0.574 SFT	
SO 38 FRA CO PIC CO	39°48'23.89346"N	83°05'21.47049"W	725.231	658556.5470	1802943.2313	835.083
	RESIDUALS		ΔH = 0.067 SFT		ΔV = -1.966 SFT	
COLUMBUS CORS (COLB)	39°57'35.11259"N	83°02'44.74726"W	611.632	714254.2735	1815510.6603	729.390
PATTERSON (2701)	SITE BASE STATION "PATTERSON (2701)" LOCAL SITE SETTINGS					
	40°00'26.60216"N	83°13'33.66518"W	823.679	731962.465	1765121.722	933.034
	LOCAL GROUND COORDINATES NAVD 88					
	GROUND SCALE FACTOR: 1.0000443377222	NORTHING	731962.465	EASTING	1765121.722	ELEVATION
	GEOID MODEL: GEOD12A (CONUS)				933.034	
	UNITS ARE IN U.S. SURVEY FEET (SFT)					

P.O.B. 11.399 Ac. N 731,605.030' E 1,763,628.157'
P.O.B. 89.392 Ac. N 732,094.392' E 1,765,366.800'

OWNER/DIVIDER
DAVID C. & TERESA L. SAYRE
8280 PATTERSON ROAD
HILLIARD, OHIO 43026
(614) 529-1669

ZONING
RURAL - R



I HEREBY CERTIFY THIS TO BE A PLAT OF A SURVEY MADE UNDER MY DIRECTION IN NOVEMBER, 2018.

Jason C. McConnaughey 12-20-18
JASON C. McCONNAUGHEY, P.S. 8509 DATE

NOTES
THE ABOVE LISTED DEED REFERENCES WERE USED AS A BASIS FOR CARRYING OUT THE WORK.
NO EVIDENCE OF OCCUPATION EXISTS ALONG PROPERTY LINES INDICATED BY SOLID LINES.
ALL MONUMENTS FOUND OR SET ARE IN GOOD CONDITION UNLESS OTHERWISE INDICATED.

ACCORDING TO THE FLOOD INSURANCE RATE MAP COMMUNITY PANEL NO. 39049C0140K, DATED JUNE 17, 2008, THE PROPERTY LIES IN A FLOOD HAZARD ZONE X.

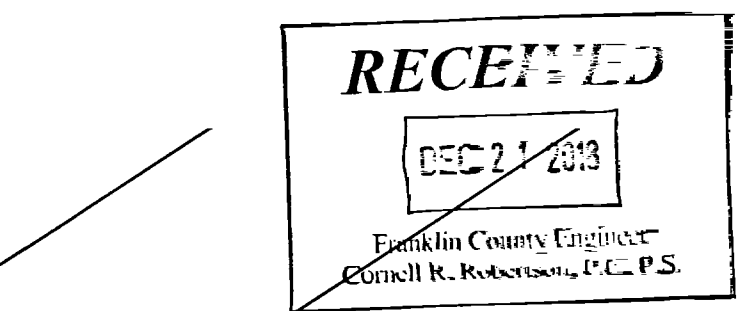

SECOND PIECE
55 Ac.
PT. OF LOT No. 7 OF THE
JOSEPH O'HARRA HEIRS PARTITION
SUPERIOR COURT REC. 8, PAGE 179
PT. OF LOT No. 7 OF THE
BAILEY PARTITION, D.B. 111, PAGE 179
PART OF THE WILL OF
GIDEON ARMANTROUT
RECORD OF WILL P, PAGE 214
(54.171 Ac.)

KATHRINE B. COLWELL,
TRUSTEE
INSTR. No. 200901270010375
ORIG. 153.426 Ac.

REMAINDER OF
THIRD PIECE
ORIG. 20 Ac., 57 POLES
PT. OF LOT No. 7 OF THE
BAILEY PARTITION, D.B. 111, PAGE 179
PART OF THE WILL OF
GIDEON ARMANTROUT
RECORD OF WILL P, PAGE 214
(5.885 Ac.)

11.479 Ac.
(0.253 Ac. IN R/W)

PARCEL No. 2
FIRST PIECE
10 Ac.
PT. LOT No. 6 OF
JOSEPH O'HARRA HEIRS PARTITION
SUPERIOR COURT REC. 8, PAGE 179
(9.999 Ac.)

1/2 Ac.
(0.622 Ac.)

FIRST PARCEL
19 14/100 Ac.
(18.894 Ac.)

SECOND PARCEL
WEST 1/2 OF
19 14/100 Ac.
(9.591 Ac.)

89.355 Ac.
(0.310 Ac. IN R/W)

PATTERSON ROAD (50')
(COUNTY ROAD No. 149)

PATTERSON WALKER
APTULU, LLC
INSTR. No. 201611290163233
50.670 Ac.

RESIDENCE
BARN
MONUMENT BOX FC GS 6105
C/L PER 1874 ROAD RECORD 9, PAGE 60
S 56°38'46" W 5788.06'
S 34°50'34" E 1373.82'
N 34°50'34" W 1373.82'
N 57°04'40" E 1480.00'
S 32°59'34" E 260.81'
N 56°51'30" E 1092.79'
S 32°59'34" E 1092.79'
S 32°59'34" E 1140.27'
S 56°38'46" W 364.52'
S 26°07'29" E 505.04'
S 26°07'29" E 476.01'
S 56°54'43" W 384.52'
S 56°54'43" W 540.71'
S 56°54'43" W 320.89'
S 56°38'46" W 363.95'
S 32°46'01" E 539.15'
S 57°04'21" W 1187.97'
S 32°46'01" E 13.89'
S 32°46'01" W 1.21'

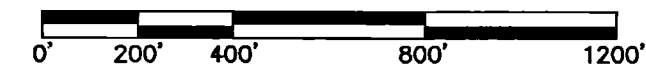
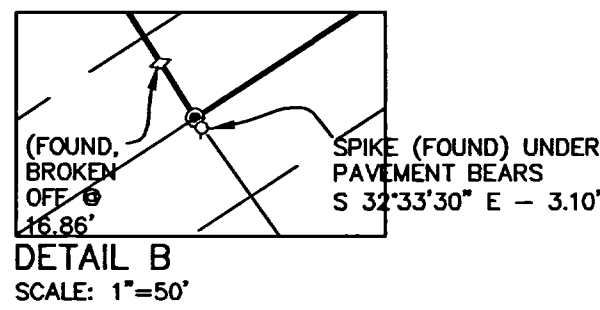
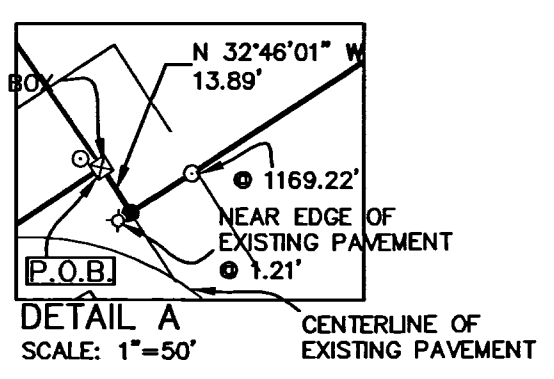

SURVEY FOR
DAVID C. SAYRE
BROWN TOWNSHIP
FRANKLIN COUNTY, OHIO
V.M.S. Nos. 882 & 5985

McCARTY ASSOCIATES, LLC
ARCHITECTS — ENGINEERS — SURVEYORS

213 N. HIGH ST., HILLSBORO, OHIO 45133 PH. 937-393-9971 FAX 937-393-2480
1515 ST. RT. 28 SUITE E, LOVELAND, OHIO 45140 PH. 513-722-0300 FAX 513-722-0500
304 E. MARKET ST., WASHINGTON C.H., OHIO 43160 PH. 740-335-3816 FAX 740-335-5828

REV. 12/18/18; 12/20/18 www.mccartyassociates.com

DATE	SCALE	PROJECT NO.
NOVEMBER 20, 2018	1"=400'	S18-786