

INCHCAPE LANE (PRIVATE) RESERVE "G" P.B. 121, P. 79

Cottages at Ballantrae Woods Condominium
C.P.B. 259, P. 11
I.N. 201707240101121

Parcel Exhibit 0.131 Ac.

City of Dublin, Franklin County, Ohio
Virginia Military Survey No. 6953

FRANCES DRIVE (PRIVATE)
RESERVE "G"

S42°10'20"W 149.69'

$\Delta=85^{\circ}06'28''$
R=20.00' FUTURE B-56
ArcL=29.71'
ChB=S84°43'34"W
ChD=27.05'

BALLANTRAE WOODS, LLC
I.N. 201607060086700

BALLANTRAE WOODS
RESERVE "M"
1.577 AC.
P.B. 121, P. 79

FUTURE B-56

FUTURE B-57

FUTURE B-64

RECEIVED

Franklin County
Council

TPOB

S47°49'40"E 98.00'

N42°10'20"E
39.24'

0.131 Ac.
B-58

$\Delta=90^{\circ}00'00''$
R=20.00'
ArcL=31.42'
ChB=N2°49'40"W
ChD=28.28'

City of Dublin Approval Not Required

C. Aaron Stanford
C. Aaron Stanford, P.E. 4/5/18
Senior Civil Engineer

S42°10'20"W 59.24'

N47°49'40"W 78.00'

GLENAPP LANE (PRIVATE) RESERVE "G" P.B. 121, P. 79

This exhibit is based on existing Franklin County Auditor's and Recorder's records and an actual field survey performed by American Structurepoint, Inc. in 2016.

Bearings are based on the bearing of N 05° 28' 57" W for the centerline of Cosgray Road between Franklin County Geodetic Survey monuments 0049 and 2210 (Ohio State Plane Coordinate System, South Zone, NAD83, NSRS 2007) as established using a GPS survey and as shown on the plat for Ballantrae Woods of record in Plat Book 121, Page 79.

Iron pins set are 3/4" diameter iron pins 30" long and capped Advanced-7661

LEGEND

- I.P. Found
- Iron Pin Set

GRAPHIC SCALE

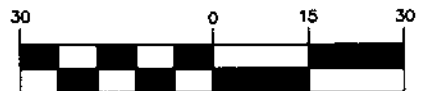

(IN FEET)
1 inch = 30 ft.

DRAWN BY: BCK	JOB NO.: 17-0005-606
DATE: 4/5/2018	CHECKED BY: DRB

ADVANCED
CIVIL DESIGN
ENGINEERS SURVEYORS

422 Beecher Road
Gohanna, Ohio 43230
ph 614.428.7750
fax 614.428.7755

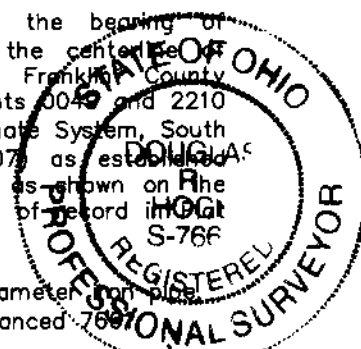

Douglas R. Hock
Douglas R. Hock, P.S. 7661 Date: 4/6/18