

# Parcel Exhibit 0.132 Ac.

City of Dublin, Franklin County, Ohio  
Virginia Military Survey No. 6953

City of Dublin Approval Not Required

C. Aaron Stanford, P.E.  
Senior Civil Engineer

3/22/18

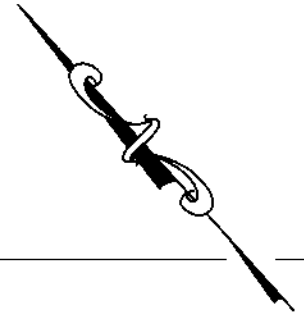

## GLENAPP LANE (PRIVATE) RESERVE "G" P.B. 121, P. 79

S47°49'40"E  
40.00'

$\Delta=90^{\circ}00'00''$   
 $R=20.00'$   
 $ArcL=31.42'$   
 $ChB=N87^{\circ}10'20''E$   
 $ChD=28.28'$

EVA LOOP S. (PRIVATE)  
RESERVE "G" P.B. 121, P. 79

N42°10'20"E 76.90'

0.132 Ac.  
B-67

S42°10'20"W 96.90'

FUTURE B-68

FUTURE B-69

TPOB

N47°49'40"W 60.00'

BALLANTRAE WOODS, LLC  
I.N. 201607060086700

FUTURE B-66

FUTURE B-72

$\Delta=71^{\circ}36'40''$   
 $R=71.50'$   
 $ArcL=89.36'$   
 $ChB=N77^{\circ}58'40''E$   
 $ChD=83.66'$

RPOB

BALLANTRAE WOODS  
RESERVE "N"  
1.267 AC.  
P.B. 121, P. 79

FUTURE B-65

FUTURE B-73

BALLANTRAE WOODS  
RESERVE "P"  
1.660 AC. (Open Space)  
P.B. 121, P. 79

This exhibit is based on existing Franklin County Auditor's and Recorder's records and an actual field survey performed by American Structurepoint, Inc. in 2016.

Bearings are based on the bearing of 05° 28' 57" W for the centerline of Cosgray Road between Franklin County Geodetic Survey monuments 0049 and 2210 (Ohio State Plane Coordinate System Zone, NAD83, NSRS 2011) as established using a GPS survey and as shown on the plat for Ballantrae Woods of record in Book 121, Page 79.

Iron pins set are 3/4" diameter and 30" long and capped Advanced

### LEGEND

- I.P. Found
- Iron Pin Set

### GRAPHIC SCALE

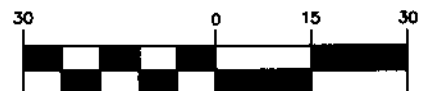

( IN FEET )  
1 inch = 30 ft.

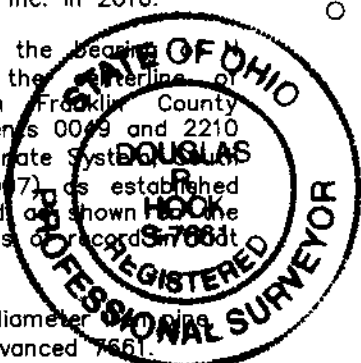

DRAWN BY: BCK	JOB NO.: 17-0005-606
DATE: 8/16/2017	CHECKED BY: DRB



422 Beecher Road  
Gahanna, Ohio 43230  
ph 614.428.7750  
fax 614.428.7755

Douglas R. Hock, P.S. 7661

Date:

3/23/18

RECEIVED

Franklin County Engineer  
Charles R. Reinhardt, P.E., P.S.