



IBI GROUP
 635 Brooksedge Boulevard
 Westerville OH 43081 USA
 tel 614 818 4900 fax 614 818 4901
 ibigroup.com

PROPERTY SPLIT EXHIBIT

TATE EXCAVATING INC.
ALUM CREEK DRIVE

GRAPHIC SCALE



(IN FEET)

1 Inch = 150 ft.

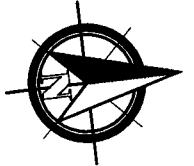

4344 JERMOORE LLC
 I.N. 201002030013828
 McFADYENS ACRES SUB.
 P.B. 26, PG. 20
 LOT 4

TATA EXCAVATING, INC.
 O.R.V. 34430, PG. H02
 10.11 ACRES (ORIG)
 PARCEL NO. 153-000034
 6.519 ACRES REMAINDER

Franklin County Engineer
 Dean C. Ringle PE JS

RECEIVED

JAN 24 2016

1"PIPE
 301.10'
 N3°51'37"E
 179.33'
 1"PIPE
 70'

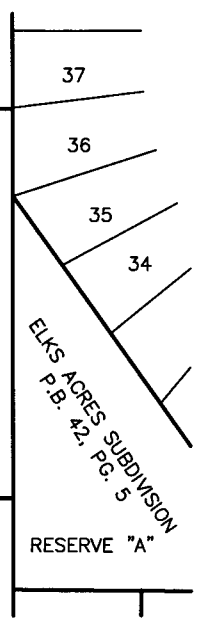

HERBERT LEE PERKINS
 MADONNA MAE PERKINS
 I.N. 200108070181240
 ORIG. 5.013 ACRES

3.426 ACRES
 PART OF
 P.N. 153-000034

TATA EXCAVATING, INC.
 I.N. 200604050063551
 3.816 ACRES

LEGEND

- ⊙ IRON PIN FOUND
CAPPED AS NOTED
- ⊠ ODOT MONUMENT BOX FOUND
- IRON PIN SET
5/8"REBAR 30" LONG
"IBI GROUP S-6872/7740"

BASES OF BEARINGS

BEARINGS HEREON ARE BASED ON GPS OBSERVATIONS ESTABLISHING A BEARING OF NORTH 03°52'25" EAST FOR THE CENTERLINE OF ALUM CREEK DRIVE BETWEEN OHIO DEPARTMENT OF TRANSPORTATION MONUMENT BOXES FOUND AT THE INTERSECTIONS OF INDUSTRIAL CENTER DRIVE AND MAUREEN BOULEVARD

ARUNA OBETZ
 4375 LLC
 I.N. 201612200175062

TRUE PLACE
OF BEGINNING

"ZANDE"
 179.97'

REFERENCE
POINT

N86°07'35"W
58.00'

S3°52'25"W
139.93'

SECTION 13, TWP. 4 RANGE 22
 SECTION 18, TWP. 11 RANGE. 21

ALUM CREEK DRIVE
 P.B. 99, PG. 59

Ⓐ STATE OF OHIO
 I.N. 200303140075902
 0.165 ACRE
 PARCEL No. 41-WDV

Ⓑ STATE OF OHIO
 I.N. 200302130045971
 0.184 ACRE
 PARCEL No. 42-WDV

Ⓒ STATE OF OHIO
 I.N. 200303060066650
 0.046 ACRE
 PARCEL No. 39-WDV



David L. Chiesa 7740
 REGISTERED SURVEYOR NO.

1-24-17
 DATE