

SITUATED IN THE STATE OF OHIO, COUNTY OF FRANKLIN,
TOWNSHIP OF MIFFLIN, IN QUARTER TOWNSHIP NO. 3,
TOWNSHIP NO. 1, RANGE NO. 17 UNITED STATES MILITARY LANDS

RECEIVED

DEC 19 2015

Franklin County Engineer
Dean C. Ringle, P.E., P.S.

SUNBURY ROAD

AGLER ROAD

POINT OF REFERENCE

LOT 5

ADVENT UNITED CHURCH OF CHRIST
ORV 30743 F05
10.425 ACRES (DEED)
PID 010-233703

PID 010-009769
1.461 ACRES

208.07'

0.746 ACRES
REMAINING

409.99'

S85°58'47"E

25.68'

S3°15'13"W

POB

PARTITION OF THE ESTATE OF EBENEZER DEAN, DEC'D,
FRANKLIN COUNTY COURT OF COMMON PLEAS,
COMPLETE RECORD 22 PAGE 184,

LEO AND SALLIE RICE
IN 201107140087736

PID 190-003732
7.29 ACRES

LOT 4

LEO RICE
IN 201510190148030
4.657 ACRES
0.322 PRO

SEPTIC
AREA

WELL
PIT

PID 190-000031
0.606 ACRES (RECORD)
0.101 PRO

PID 190-003732
7.29 ACRES (RECORD)
1.238 ACRES
0.063 PRO

RIGHT-OF-WAY EASE
FRANKLIN COUNTY
CV 3123, PG 367
0.101 ACRES

PID 190-003164
3.996 ACRES

494.62'

N3°15'13"E

N3°15'13"E

N3°15'13"E

N85°52'47"W

410.00'

24.45'

S3°15'13"W

LOT 3

AN ASSUMED BEARING OF SOUTH 3°15'13" WEST WAS USED ON THE CENTERLINE
OF CASSADY AVENUE AND ALL OTHER BEARINGS BASED UPON THIS MERIDIAN.

COLUMBUS SCHOOL FOR GIRLS
IN 200001140010503
19.379 ACRES

CITY OF COLUMBUS
IN 200003290060603
1.786 ACRES

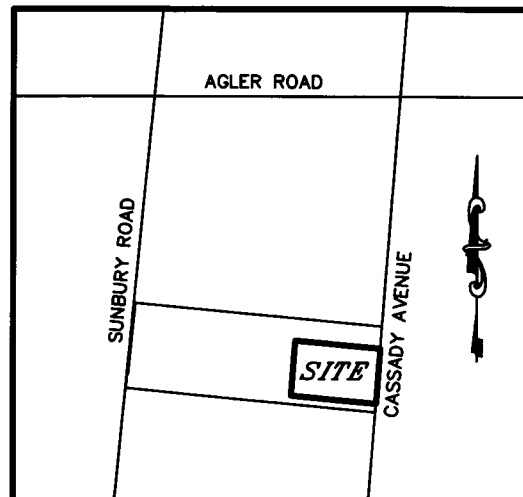

VICINITY MAP

NOT TO SCALE



GRAPHIC SCALE

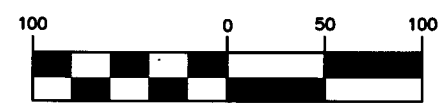

(IN FEET)

1 inch = 100 ft.

LEGEND

- 3/4" ID PIPE FOUND
- 3/4" ID PIPE SET
- △ RAIL ROAD SPIKE

HOCKADEN AND ASSOCIATES, INC.
CONSULTING ENGINEERS & SURVEYORS

By *Frank C. Long* 14 DEC 2015
FRANK C. LONG, P.S. No. 6615



LOT SPLIT SURVEY

LOCATION
EAST OF SUNBURY ROAD
WEST OF CASSADY AVENUE
SOUTH OF AGLER ROAD

CLIENT
STAGES PREMIER REALTORS

PREPARED BY:
HOCKADEN AND ASSOCIATES, INC.
Consulting Engineers & Surveyors
888 North Cassady Avenue
Columbus, Ohio 43218
Telephone: (614) 888-0888
Fax: (614) 888-0888

DESIGN BY: FCL	CHECKED BY: FCL	ORDER NO.	AREA NO.	SHEET
SCALE: 1"=100'	DWG. DATE: JULY 2015	42937/10.1	21-7	1 OF 1