

PLAT OF SURVEY OF A 0.490 ACRE TRACT

SITUATED IN THE STATE OF OHIO,
COUNTY OF FRANKLIN, TOWNSHIP OF PERRY,
CITIES OF COLUMBUS AND WORTHINGTON,
QUARTER TOWNSHIP 4, TOWNSHIP 2, RANGE 19,
UNITED STATES MILITARY LANDS.

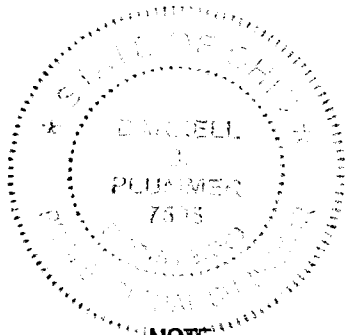

NOTE

ALL IRON PINS SET ARE 5/8" SOLID IRON PINS 30" IN LENGTH
WITH A YELLOW PLASTIC CAP STAMPED "CT CONSULTANTS".

NOTE

ALL RECORD INFORMATION SHOWN HEREON WAS OBTAINED
FROM THE RECORDER'S OFFICE, FRANKLIN COUNTY, OHIO.

BASIS OF BEARINGS

BEARINGS ARE BASED ON THE CENTERLINE OF LINWORTH ROAD
BEING NORTH 06°39'15" WEST AS ACQUIRED BY GPS
OBSERVATIONS AS PER NAD 83 (2011)-OHIO STATE PLANE
COORDINATE SYSTEM-SOUTH ZONE USING MONUMENT COLB FROM
THE OHIO DEPARTMENT OF TRANSPORTATION CORS NETWORK.

ACREAGE BREAKDOWN

0.175 ACRES OUT OF TAX PARCEL 100-006096.
0.315 ACRES OUT OF TAX PARCEL 610-217753.
0.175 ACRES IN CITY OF WORTHINGTON.
0.315 ACRES IN CITY OF COLUMBUS.

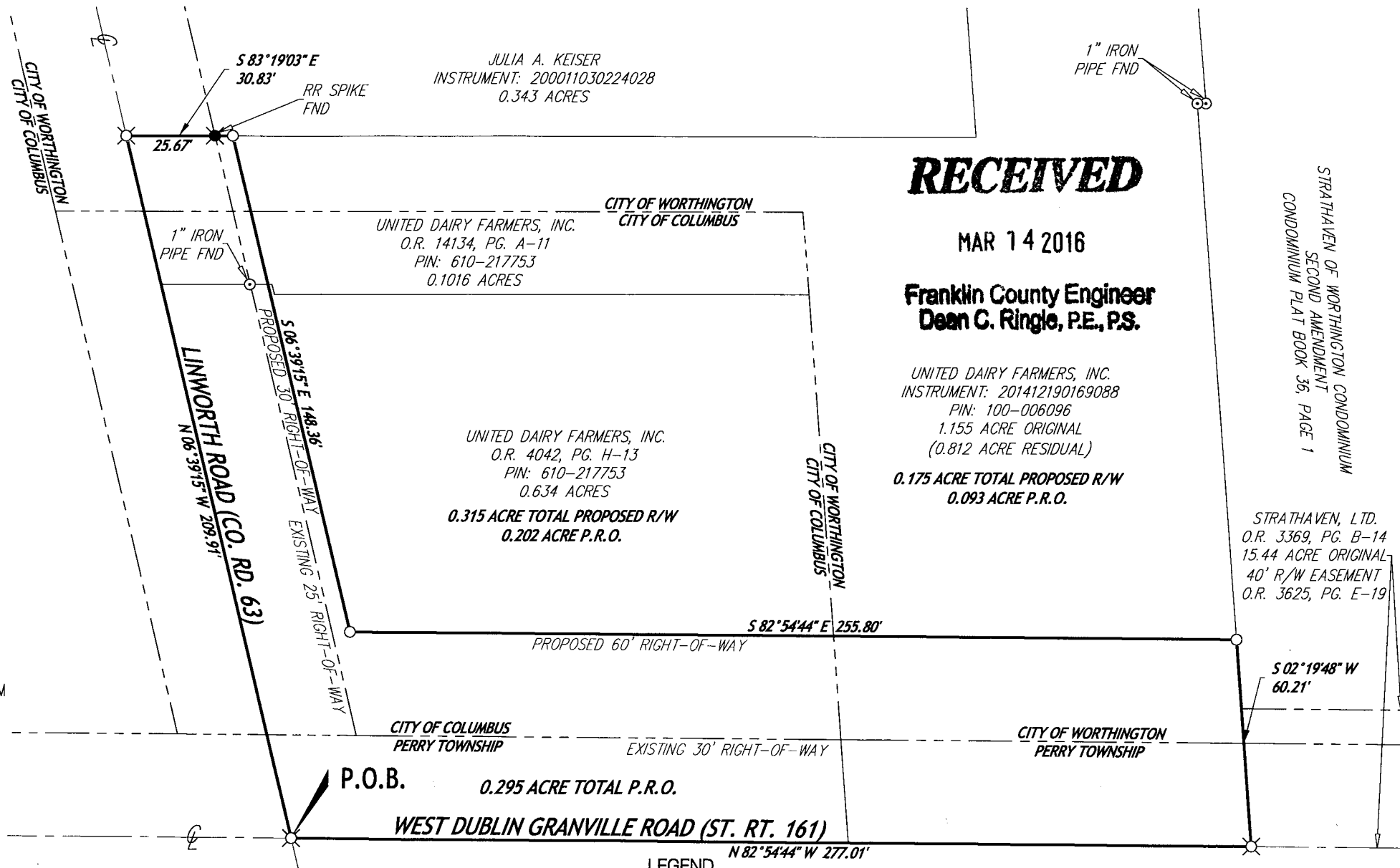

RECEIVED

MAR 14 2016

**Franklin County Engineer
Dean C. Ringle, P.E., P.S.**

UNITED DAIRY FARMERS, INC.
INSTRUMENT: 201412190169088
PIN: 100-006096
1.155 ACRE ORIGINAL
(0.812 ACRE RESIDUAL)

**0.175 ACRE TOTAL PROPOSED R/W
0.093 ACRE P.R.O.**

STRATHAVEN OF WORTHINGTON CONDOMINIUM
SECOND AMENDMENT
CONDOMINIUM PLAT BOOK 36, PAGE 1

STRATHAVEN, LTD.
O.R. 3369, PG. B-14
15.44 ACRE ORIGINAL
40' R/W EASEMENT
O.R. 3625, PG. E-19

LEGEND

- IRON PIN FND ●
- IRON PIPE FND ⊙
- RR SPIKE FND ⊗
- IRON PIN SET ○
- RR SPIKE SET ⊗



SCALE: 1" = 40'

PAGE 3 OF 3
DRAWN BY: DBP
CHECKED BY: KAS

FILE NO. 150088

CT Consultants
engineers | architects | planners
7965 North High Street, Suite 120, Columbus, Ohio 43235
614.885.1700 www.ctconsultants.com

I HEREBY STATE THAT THIS SURVEY IS BASED ON ACTUAL FIELD MEASUREMENTS
PERFORMED IN JULY, 2015 AND TO THE BEST OF MY KNOWLEDGE AND BELIEF IS CORRECT.

Darrell B. Plummer 3/10/2016
DARRELL B. PLUMMER, P.S. DATE
PROFESSIONAL SURVEYOR NO. 7595