

EXHIBIT "B"

RECEIVED

NOV 07 2013

Franklin County Engineer
Dean C. Ringle, P.E., P.S.

**PARCELS 1-WD
CITY OF NEW ALBANY
FREDERICK F. CAMPBELL, BISHOP OF
THE ROMAN CATHOLIC DIOCESE OF COLUMBUS
RIGHT-OF-WAY DEDICATION**

Plain Local Schools District,
Franklin County, Ohio

PID 222-002958
24.871 Acres
Inst. No.
200404210089326

Frederick F. Campbell,
Bishop of the Roman
Catholic Diocese
of Columbus

PARCEL 1
PID 222-002957
2.023 Acres
Inst. No.
200809030133762 (Name Affidavit)
O.R.V. 27360, G03 (Source Deed)

Frederick F. Campbell,
Bishop of the Roman
Catholic Diocese
of Columbus

PARCEL 2
PID 222-003102
1.644 Acres
Inst. No.
200809030133762 (Affidavit)
200302120044804 (Source Deed)

The City of
Columbus, Ohio

0.279 Acres
ORV 24824, A15
Inst. No.
200311200372935

The Board of
Education of
the Plain Local
School District
PID 222-000922
50.661 Acres
O.R.V. 15669, E17

REFERENCED
DOCUMENTS

- P.B. 20, PG. 45
- P.B. 83, PG. 11
- P.B. 90, PG. 53
- D.B. 735, PG 439
- O.R.V. 00984 F18
- O.R.V. 15669 E17
- O.R.V. 27360 G03
- Inst. No. 200008180166505
- Inst. No. 200311200372935
- Inst. No. 200404210089326
- Inst. No. 200606130114869
- Inst. No. 200809030133762
- Inst. No. 201204100049236

LINE	BEARING	LENGTH
L1	S77°14'20"W	201.31'
L2	S77°14'20"W	14.92'
L3	N03°24'03"E	59.97'
L4	N74°18'55"E	64.02'
L5	N15°28'26"W	61.96'
L6	S85°38'54"E	14.00'
L7	S20°47'54"E	81.96'
L8	S03°29'34"W	75.21'
L9	S03°19'04"W	41.63'

CURVE	LENGTH	RADIUS	DELTA	CHORD BEARING	CHORD DISTANCE
C1	94.95	1637.02	3°19'24"	S82°29'29"W	94.94'
C2	102.59	1637.02	3°35'27"	S79°02'04"W	102.58'
C3	244.26	1909.86	7°19'40"	S73°34'30"W	244.09'
C4	219.00	1964.86	6°23'09"	N73°06'15"E	218.88'
C5	78.39	1695.02	2°38'59"	N78°33'50"E	78.38'
C6	70.29	40.00	100°41'14"	N29°32'43"E	61.59'
C7	284.67	869.00	18°46'10"	N06°05'21"W	283.40'
C8	359.54	855.00	24°05'38"	S08°45'05"E	356.90'
C9	114.08	1677.02	3°53'51"	S79°11'16"W	114.06'
C10	197.55	1637.02	6°54'51"	S80°41'46"W	197.43'

PRO ACREAGE	ACREAGE	AUDITOR'S PID
0.000	0.147	PID 222-002957
0.000	0.200	PID 222-003102
0.141	0.261	PID 222-000373
0.368	0.676	PID 222-002954

TOTAL 1.284 FOR PARCEL 1-WD
OF WHICH 0.509 ACRES PRO

STATE OF OHIO
HIGHWAY EASEMENT
D.B. 735, PAGE 439

N69°54'40"E 457.52'

Frederick F. Campbell,
Bishop of the Roman
Catholic Diocese
of Columbus

PARCEL 9
PID 222-002954
7.364 Acres
Inst. No.
200809030133762 (Affidavit)
O.R.V. 00984, F18 (Source Deed)

Frederick F. Campbell,
Bishop of the Roman
Catholic Diocese
of Columbus

PARCEL 8
PID 222-000373
0.941 Acres
Inst. No.
200809030133762 (Affidavit)
200008180166505 (Source Deed)

New Albany-Plain
Township
Historical Society
PID 222-003432
0.407 Acres
Inst. No.
200408200196293

Village of New Albany
PID 222-0003130
6.119 Acres
Inst. No.
200311200372935

Village of New Albany
Inst. No.
200606130114869
POC
(S. R. 161)
P.B. 90, PG. 53

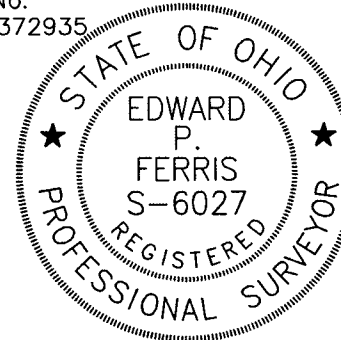

BY: *E. P. Ferris* 8-9-13
Edward P. Ferris, P.E., P.S.
Registered Surveyor No. 6027
Date

DRAWN BY MLS CHK BY EPF DATE 8-09-13

Consulting Civil Engineers and Surveyors
880 King Avenue, Columbus Ohio, 43212

(PH) 614-299-2999
(FX) 614-299-2992

We hereby certify that the foregoing
Boundary Survey was prepared from
actual field measurements in
accordance with Chapter 4733-37
Ohio Administrative Code.

- Legend**
- Area to be Dedicated
 - Area in PRO to be Dedicated
 - Property Line
 - CL Center Line
 - Ex. R/W Ex. Right-of-Way
 - EA Permanent Easement
 - R/W Dedicated Right-of-Way
 - TMP Temporary Easement
 - POC Point of Commencement
 - POB Point of Beginning
 - Railroad Spike Found (RRF)
 - △ Centerline Road Deflection Point
 - Iron Pipe Found (IPF)/P K Nail Found (PKF)
5/8" Rebar Found (RBF)
 - I.P.S. Iron Pin Set (5/8" Rebar x 30" Long)

BASIS OF BEARING:

The bearing shown are based on the Ohio
State Plane Coordinate System South Zone,
NAD83, CORS96, said bearings originated
from a field traverse witch was tied to said
coordinate system by GPS observation and
observations of select stations in the Ohio
Department of Transportation Virtual
Reference Station Network.
Bearing along Centerline of Fodor Road is
NORTH 20°47'54" WEST

All Set Iron Pins are 5/8" Rebar,
plastic capped with "E.P. FERRIS
SURVEYOR 6027" inscribed on top.
All iron pins found are in good condition.

STATE OF OHIO
HIGHWAY EASEMENT
D.B. 735, Pg 423

Deanna Steele &
William A. Steele
PID 222-000651
2.833 Acres
Inst. No. 201204100049236

West New Albany
Land, LTD.
O.R.V. 00984 F18
Ownership left in source title

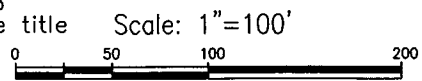

E. P. FERRIS & ASSOCIATES, INC.