

SURVEY OF ACREAGE PARCEL

VIRGINIA MILITARY SURVEY 6748

CITY OF DUBLIN, COUNTY OF FRANKLIN, STATE OF OHIO

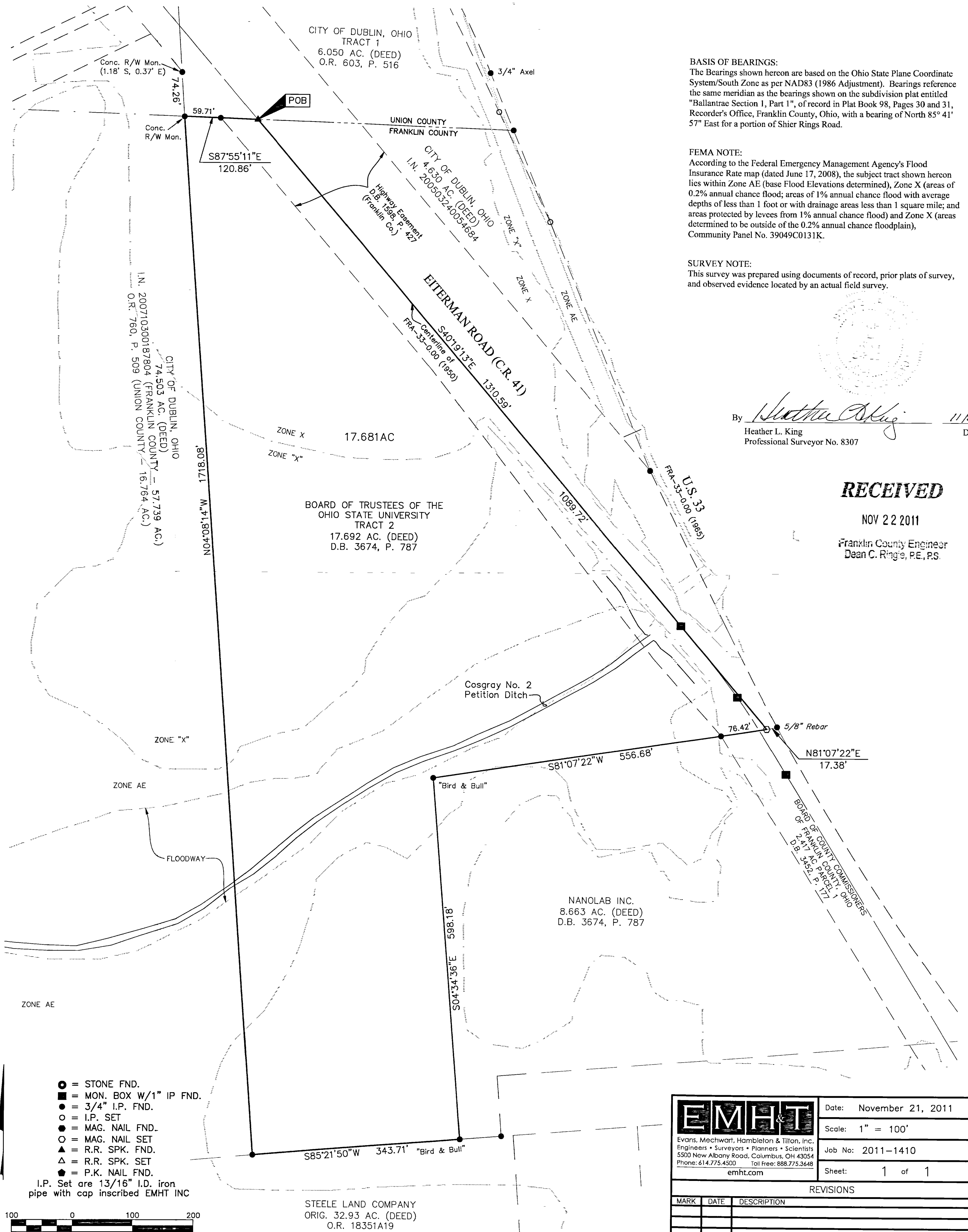

BASIS OF BEARINGS:

The Bearings shown hereon are based on the Ohio State Plane Coordinate System/South Zone as per NAD83 (1986 Adjustment). Bearings reference the same meridian as the bearings shown on the subdivision plat entitled "Ballantrae Section 1, Part 1", of record in Plat Book 98, Pages 30 and 31, Recorder's Office, Franklin County, Ohio, with a bearing of North 85° 41' 57" East for a portion of Shier Rings Road.

FEMA NOTE:

According to the Federal Emergency Management Agency's Flood Insurance Rate map (dated June 17, 2008), the subject tract shown hereon lies within Zone AE (base Flood Elevations determined), Zone X (areas of 0.2% annual chance flood; areas of 1% annual chance flood with average depths of less than 1 foot or with drainage areas less than 1 square mile; and areas protected by levees from 1% annual chance flood) and Zone X (areas determined to be outside of the 0.2% annual chance floodplain), Community Panel No. 39049C0131K.

SURVEY NOTE:

This survey was prepared using documents of record, prior plats of survey, and observed evidence located by an actual field survey.

By Heather L. King 11/22/11
 Heather L. King Date
 Professional Surveyor No. 8307

RECEIVED

NOV 22 2011

Franklin County Engineer
 Dean C. Ringle, PE, PS.

- = STONE FND.
 - = MON. BOX W/1" IP FND.
 - = 3/4" I.P. FND.
 - = I.P. SET
 - = MAG. NAIL FND.
 - = MAG. NAIL SET
 - ▲ = R.R. SPK. FND.
 - ▲ = R.R. SPK. SET
 - ◆ = P.K. NAIL FND.
- I.P. Set are 13/16" I.D. iron pipe with cap inscribed EMHT INC

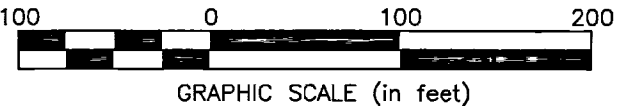

EMHT		Date: November 21, 2011
Evans, Mechwart, Hambleton & Tilton, Inc. Engineers • Surveyors • Planners • Scientists 5500 New Albany Road, Columbus, OH 43054 Phone: 614.775.4500 Toll Free: 888.775.3648 emht.com		Scale: 1" = 100'
		Job No: 2011-1410
		Sheet: 1 of 1
REVISIONS		
MARK	DATE	DESCRIPTION

L:\2011\1410\20111410BNDY_02.DWG plotted by KING, HEATHER on 11/21/2011 11:24:15 AM last saved by KING on 11/21/2011 11:23:32 AM