

**RECEIVED**

FEB 14 2011

Franklin County Engineer  
Dean C. Ringle, P.E., P.S.

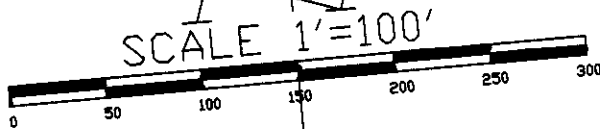
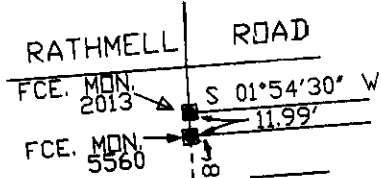

BASIS OF BEARINGS: THE WEST LINE OF THE SCIOTO VALLEY TRACTION COMPANY RIGHT-OF-WAY AS S 05°47'00" W FROM INST.#200902250025698.

P-K NAIL SET 42+75

C/L REESE ROAD  
FRA. CO. COMM.  
DB-162 PG-196

RAILROAD C/L INTERSECTION  
STA.= 159+30.4

PRIOR DEED REFERENCE:  
JODY E. SLOANE UNDIVIDED 3/18 INTEREST  
MATHEW J. DILL UNDIVIDED 3/18 INTEREST  
HEATHER J. DILL UNDIVIDED 3/18 INTEREST  
ANDREW J. DILL UNDIVIDED 3/18 INTEREST  
JONATHAN DILL UNDIVIDED 2/18 INTEREST  
DAVID DILL UNDIVIDED 2/18 INTEREST  
STEPHANIE DILL-FARRELL UNDIVIDED 2/18 INTEREST  
INST.#200902250025698

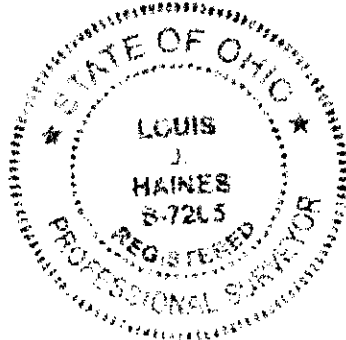

TRACT TWO  
56.1840 ACRES  
(TAX DUP.= 60.34 ACRES)  
A PORTION OF 150-000132

BOUNDARY SURVEY  
OF TRACT THREE 0.4900 ACRES IN  
SEC-26, TWP-04, RGE-22,  
HAMILTON TOWNSHIP, FRANKLIN COUNTY,  
STATE OF OHIO:  
FOR  
JODY E. SLOANE et.al. (7)  
AND OR  
KENNETH E. ZWAYER

**Louis Haines**

354 Kessler Street  
Groveport, Ohio 43125  
Phone 837-2181

I HEREBY CERTIFY THE PLAT SHOWN HEREON  
IS CORRECT AS SURVEYED BY US.  
DATE: Feb. 22, 2011  
SIGNED: [Signature]

ALL 3/4" IRON PIPE SET ARE 3/4" GALVANIZED IRON PIPE CUT TO 30' LENGTHS WITH AN ORANGE PLASTIC ID CAP INSCRIBED "HAINES SURV."

ALL DEED, SURVEY, PLAN AND OTHER INFORMATION NOTED HEREON IS AVAILABLE FROM THE COUNTY AND STATE IN WHICH THIS SURVEY WAS PERFORMED.

