

LEGEND  
 ● IRON PIN SET (M-E ENG/S-6872)  
 ○ IRON PIN FOUND

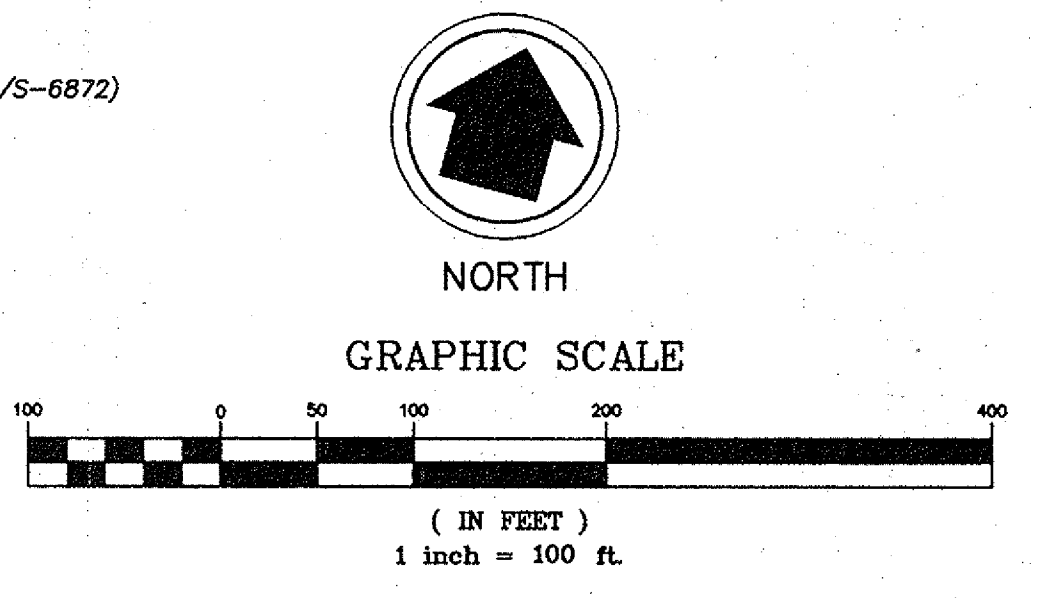

Situated in the State of Ohio, Counties of Franklin and Delaware, City of Dublin, Virginia Military Survey No. 2545 & 2544.  
 Bearings herein are based on North 14°55'40" West for the centerline of Dublin - Bellepoint Road south of Highway Station 156+08.80.

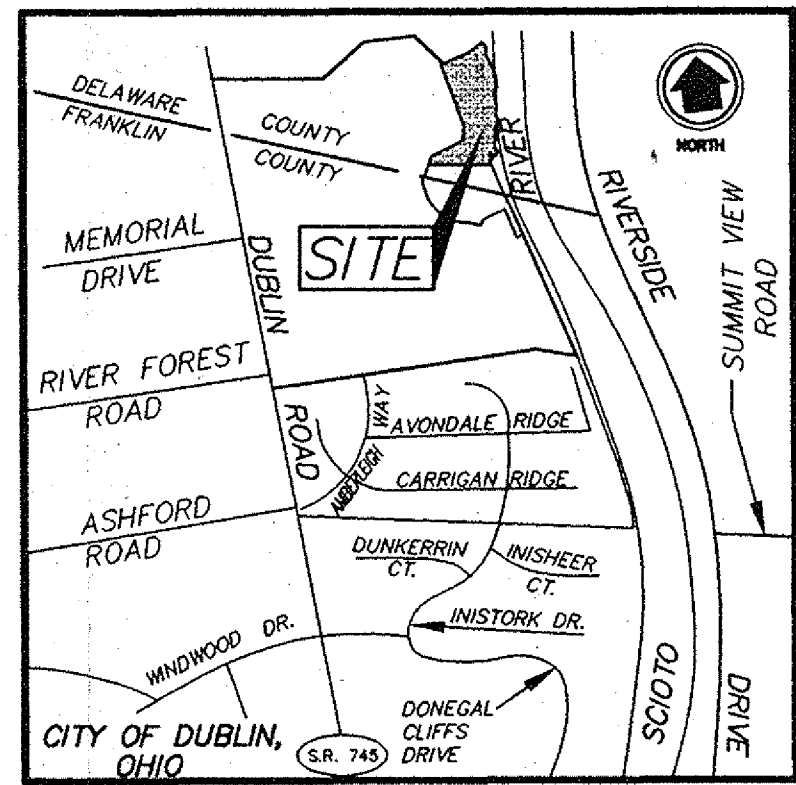

12,000 ACRES  
 EAST OF DUBLIN-BELLEPOINT ROAD (S.R. 745)  
 SOUTH OF GLICK ROAD  
 CITY OF DUBLIN, OHIO

Situated in the State of Ohio, Counties of Franklin and Delaware, City of Dublin, being part of Virginia Military Survey Nos. 2544 and 2545, being 10,147 acres out of that 43,965 acre tract (Tract 2) and 1,853 acres out of that 78,677 acre tract (Tract 1), as described in a deed to Hoag Limited Partnership, of record in Official Records Volume 33470, Page 609 (Franklin County) and Deed Volume 613, Page 433 (Delaware County), all references herein being to the records of the Recorder's Office of the respective County, and being more particularly described as follows:

Beginning FOR REFERENCE at an iron pin found at the southwesterly corner of said 43,965 acre tract, the northwesterly corner of said 78,677 acre tract, in the line between Virginia Military Survey No. 2545 and Virginia Military Survey No. 2544 and in the centerline of Dublin-Bellepoint Road (State Route 745), 60 feet in width at this location; thence North 73° 52' 44" East, along the common line between Tract 1 and Tract 2, a distance of 1100.14 feet to the TRUE PLACE OF BEGINNING;

- Thence through said Tract 2 the following courses:
1. North 14° 32' 20" East, a distance of 38.64 feet to an iron pin set;
  2. North 61° 23' 04" East, a distance of 367.24 feet to an iron pin set;
  3. North 2° 19' 20" East, a distance of 142.08 feet to an iron pin set;
  4. North 22° 13' 54" West, a distance of 715.95 feet to an iron pin set in the southerly line of Deer Run Estates, a subdivision of record in Plat Book 18, Pages 34 and 35 (Delaware County), the northerly line of Tract 2;

- Thence along said northerly line and the southerly perimeter of Deer Run Estates the following courses:
1. South 79° 35' 49" East, a distance of 38.10 feet to an iron pin found;
  2. North 64° 59' 38" East, a distance of 82.88 feet to an iron pin found;
  3. North 64° 57' 32" East, a distance of 184.75 feet to an iron pin found;
  4. North 50° 37' 49" East, passing the southeasterly corner of Reserve "A" of Deer Run Estates at 126.37 feet, a total distance of 182.64 feet to a point on the west bank of the Scioto River;

- Thence along said bank with the meanders of the low water mark, approximated by the following courses of a meander line:
1. South 15° 28' 54" East, a distance of 136.17 feet to an angle point;
  2. South 25° 06' 46" East, a distance of 246.77 feet to an angle point;
  3. South 0° 34' 22" West, passing from Tract 2 into Tract 1, a distance of 792.63 feet to a point;

- Thence continuing through said Tract 1 the following courses:
1. South 69° 15' 09" West, a distance of 708.17 feet to an iron pin set;
  2. North 14° 32' 20" East, a distance of 163.17 feet to the TRUE PLACE OF BEGINNING and containing 12,000 acres of land to the low water mark of the Scioto River, 8,865 acres of which lies in Delaware County and 3,135 acres of which lies in Franklin County.

\*11.057 acres upland from the meander line.  
 Bearings herein are based on North 14° 55' 40" West for the centerline of Dublin-Bellepoint Road south of Station 156+08.80.  
 Iron pins set consist of a 1" (O.D.) iron pipe, 30" long with a plastic cap inscribed "M-E ENG/S-6872".

DESCRIPTION OF FOR CLASSIFICATION

REVISIONS	DATE	BY	DESCRIPTION

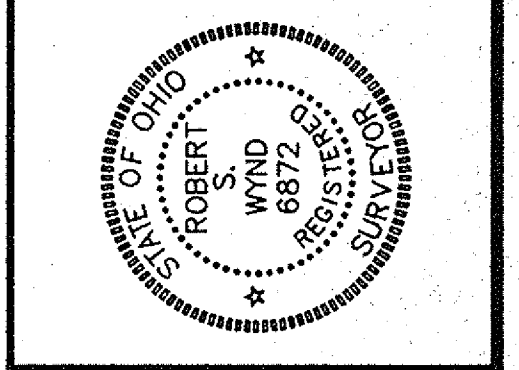

M-E CIVIL ENGINEERING INC.  
 635 BROOKSEDGE BOULEVARD  
 WESTERVILLE, OHIO 43081  
 PHONE: (614) 818-4900  
 FAX: (614) 818-4902  
 REGISTERED SURVEYOR NO. 6872  
 DATE 8/21/97

PROPERTY SPLIT  
 HOAG LIMITED PARTNERSHIP  
 DUBLIN - BELLEPOINT ROAD (S.R. 745)  
 DUBLIN, OHIO

FIELD	PM	DRAWN
EM	BW	DC
SCALE	HORIZ. 1"=60' VERT.	
JOB	973187-1-1-2	
DATE	JULY 1997	
SHEET NO.	1/1	
PRINT DATE		
M-E CIVIL ENGINEERING WESTERVILLE, OHIO SEP 23 1997 PRINTED		

V.M.S. 2545

DELAWARE COUNTY  
 APPROVAL ONLY

18.97 Ad. Tract  
 City of Dublin of 8.37 Acs.  
 (DWS NAME, AMBALTA)