

SEE SHEET #2
101.25 ACRES
 ENA REAL ESTATE INVESTMENTS, LLC (ETAL 4)
 IN 200512090260285
 101.25 AC. (DEED)
 (AUD. PAR. NO. 240-000286)

DESCRIPTION OF 2.510 ACRE TRACT
 Situated in the State of Ohio, County of Franklin, Township of Prairie, in Virginia Military Survey No. 12837 and 13245, being 2.510 acres of the land conveyed to ENA Real Estate Investments, LLC (Etal 4) as recorded in Instrument Number 200612290257718 (all references refer to records in the Franklin County Recorder's Office, Ohio) and more fully described as follows:
 Beginning at an existing Franklin County Monument Number 8845 in the centerline of Murnan Road being the southeast corner of said 2.510 acre tract and a southwest property corner of Virgil W. and Norma J. Thompson 9.77 acre tract (200003100048128);
 Thence North 85°52'34" West a distance of 110.79 feet, along the centerline of said Murnan Road to a point at the southwest corner of said 2.510 acre tract and southeast property corner of Dale C. Chapman 2.50 acre tract;
 Thence North 3°49'16" East a distance of 988.69 feet, along a westerly line of said 2.510 acre tract and easterly property line of said Chapman, passing over an existing 3/4" ID pipe at 19.89 feet to an existing 3/4" ID pipe in a southerly property line of ENA Real Estate Investments, LLC (Etal 4) 50.664 acre tract (N 200512210268265);
 Thence South 87°20'22" East a distance of 110.11 feet, along a southerly property line of said 50.664 acre tract to an existing stone at the southwesterly property corner of said 50.664 acre tract and a northwesterly property corner of said 2.510 acre tract in the westerly property line of Henrietta M. Dyer Revocable Living Trust, Gen H. & Henrietta M. Dyer, Trustees 15.00 acre tract (N 199809180237982);
 Thence South 3°46'50" West a distance of 991.51 feet, along a westerly property line of said 15.00 acre tract, passing over an existing 3/4" ID pipe at 971.45 feet to the Point of Beginning containing 2.510 acres more or less according to an actual field survey made by Hockaden and Associates, Inc. in November of 2005.
 For the purpose of this description, a bearing of North 1°38'20" East was used on the centerline of Murnan Road, and all other bearings based upon this meridian.
 42695/10.1-112406-L1

Certified to: Franklin Soil and Water
 Old Republic National Title Insurance Co.
 Columbus Title Agency of Central Ohio, LLC
 ENA Real Estate Investments, LLC (etal 4)

This is to certify that this map or plat and the survey on which it is based were made in accordance with "Minimum Standard Detail Requirements for ALTA/ACSM Land Title Surveys," jointly established and adopted by ALTA, ACSM and NSPS in 1999, and includes items 2.3.4, 6.7(a), (b)(1), (b)(1)(a), (c), (d), (e), (f), (g), (h), (i), (j), (k), (l), (m), (n), (o), (p), (q), (r), (s), (t), (u), (v), (w), (x), (y), (z), (aa), (ab), (ac), (ad), (ae), (af), (ag), (ah), (ai), (aj), (ak), (al), (am), (an), (ao), (ap), (aq), (ar), (as), (at), (au), (av), (aw), (ax), (ay), (az), (ba), (bb), (bc), (bd), (be), (bf), (bg), (bh), (bi), (bj), (bk), (bl), (bm), (bn), (bo), (bp), (bq), (br), (bs), (bt), (bu), (bv), (bw), (bx), (by), (bz), (ca), (cb), (cc), (cd), (ce), (cf), (cg), (ch), (ci), (cj), (ck), (cl), (cm), (cn), (co), (cp), (cq), (cr), (cs), (ct), (cu), (cv), (cw), (cx), (cy), (cz), (da), (db), (dc), (dd), (de), (df), (dg), (dh), (di), (dj), (dk), (dl), (dm), (dn), (do), (dp), (dq), (dr), (ds), (dt), (du), (dv), (dw), (dx), (dy), (dz), (ea), (eb), (ec), (ed), (ee), (ef), (eg), (eh), (ei), (ej), (ek), (el), (em), (en), (eo), (ep), (eq), (er), (es), (et), (eu), (ev), (ew), (ex), (ey), (ez), (fa), (fb), (fc), (fd), (fe), (ff), (fg), (fh), (fi), (fj), (fk), (fl), (fm), (fn), (fo), (fp), (fq), (fr), (fs), (ft), (fu), (fv), (fw), (fx), (fy), (fz), (ga), (gb), (gc), (gd), (ge), (gf), (gg), (gh), (gi), (gj), (gk), (gl), (gm), (gn), (go), (gp), (gq), (gr), (gs), (gt), (gu), (gv), (gw), (gx), (gy), (gz), (ha), (hb), (hc), (hd), (he), (hf), (hg), (hh), (hi), (hj), (hk), (hl), (hm), (hn), (ho), (hp), (hq), (hr), (hs), (ht), (hu), (hv), (hw), (hx), (hy), (hz), (ia), (ib), (ic), (id), (ie), (if), (ig), (ih), (ii), (ij), (ik), (il), (im), (in), (io), (ip), (iq), (ir), (is), (it), (iu), (iv), (iw), (ix), (iy), (iz), (ja), (jb), (jc), (jd), (je), (jf), (jg), (jh), (ji), (jj), (jk), (jl), (jm), (jn), (jo), (jp), (jq), (jr), (js), (jt), (ju), (jv), (jw), (jx), (jy), (jz), (ka), (kb), (kc), (kd), (ke), (kf), (kg), (kh), (ki), (kj), (kk), (kl), (km), (kn), (ko), (kp), (kq), (kr), (ks), (kt), (ku), (kv), (kw), (kx), (ky), (kz), (la), (lb), (lc), (ld), (le), (lf), (lg), (lh), (li), (lj), (lk), (ll), (lm), (ln), (lo), (lp), (lq), (lr), (ls), (lt), (lu), (lv), (lw), (lx), (ly), (lz), (ma), (mb), (mc), (md), (me), (mf), (mg), (mh), (mi), (mj), (mk), (ml), (mm), (mn), (mo), (mp), (mq), (mr), (ms), (mt), (mu), (mv), (mw), (mx), (my), (mz), (na), (nb), (nc), (nd), (ne), (nf), (ng), (nh), (ni), (nj), (nk), (nl), (nm), (nn), (no), (np), (nq), (nr), (ns), (nt), (nu), (nv), (nw), (nx), (ny), (nz), (oa), (ob), (oc), (od), (oe), (of), (og), (oh), (oi), (oj), (ok), (ol), (om), (on), (oo), (op), (oq), (or), (os), (ot), (ou), (ov), (ow), (ox), (oy), (oz), (pa), (pb), (pc), (pd), (pe), (pf), (pg), (ph), (pi), (pj), (pk), (pl), (pm), (pn), (po), (pp), (pq), (pr), (ps), (pt), (pu), (pv), (pw), (px), (py), (pz), (qa), (qb), (qc), (qd), (qe), (qf), (qg), (qh), (qi), (qj), (qk), (ql), (qm), (qn), (qo), (qp), (qq), (qr), (qs), (qt), (qu), (qv), (qw), (qx), (qy), (qz), (ra), (rb), (rc), (rd), (re), (rf), (rg), (rh), (ri), (rj), (rk), (rl), (rm), (rn), (ro), (rp), (rq), (rr), (rs), (rt), (ru), (rv), (rw), (rx), (ry), (rz), (sa), (sb), (sc), (sd), (se), (sf), (sg), (sh), (si), (sj), (sk), (sl), (sm), (sn), (so), (sp), (sq), (sr), (ss), (st), (su), (sv), (sw), (sx), (sy), (sz), (ta), (tb), (tc), (td), (te), (tf), (tg), (th), (ti), (tj), (tk), (tl), (tm), (tn), (to), (tp), (tq), (tr), (ts), (tt), (tu), (tv), (tw), (tx), (ty), (tz), (ua), (ub), (uc), (ud), (ue), (uf), (ug), (uh), (ui), (uj), (uk), (ul), (um), (un), (uo), (up), (uq), (ur), (us), (ut), (uu), (uv), (uw), (ux), (uy), (uz), (va), (vb), (vc), (vd), (ve), (vf), (vg), (vh), (vi), (vj), (vk), (vl), (vm), (vn), (vo), (vp), (vq), (vr), (vs), (vt), (vu), (vv), (vw), (vx), (vy), (vz), (wa), (wb), (wc), (wd), (we), (wf), (wg), (wh), (wi), (wj), (wk), (wl), (wm), (wn), (wo), (wp), (wq), (wr), (ws), (wt), (wu), (wv), (ww), (wx), (wy), (wz), (xa), (xb), (xc), (xd), (xe), (xf), (xg), (xh), (xi), (xj), (xk), (xl), (xm), (xn), (xo), (xp), (xq), (xr), (xs), (xt), (xu), (xv), (xw), (xx), (xy), (xz), (ya), (yb), (yc), (yd), (ye), (yf), (yg), (yh), (yi), (yj), (yk), (yl), (ym), (yn), (yo), (yp), (yq), (yr), (ys), (yt), (yu), (yv), (yw), (yx), (yy), (yz), (za), (zb), (zc), (zd), (ze), (zf), (zg), (zh), (zi), (zj), (zk), (zl), (zm), (zn), (zo), (zp), (zq), (zr), (zs), (zt), (zu), (zv), (zw), (zx), (zy), (zz)

RECEIVED
 DEC 11 2008
 Franklin County Engineer
 Dean C. Ringle, P.E., P.S.

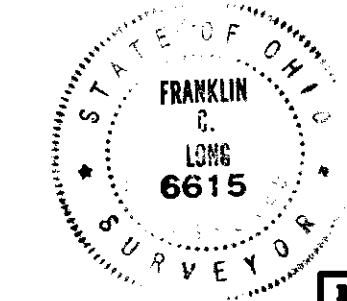

HOCKADEN AND ASSOCIATES, INC.
 CONSULTING ENGINEERS & SURVEYORS
 By: *Frank C. Longo*
 FRANK C. LONGO, P.S. No. 6615

ALTA/ACSM SURVEY

LOCATION
**EAST OF MURNAN ROAD
 WEST OF ALTON ROAD
 SOUTH OF S.R. 40**

CLIENT
JIM SICARAS

PREPARED BY:
HOCKADEN AND ASSOCIATES, INC.
 Consulting Engineers & Surveyors
 803 North Cassady Street
 Columbus, Ohio 43215
 Telephone: (614) 252-0883
 Fax: (614) 252-0444

OLD REPUBLIC NATIONAL TITLE INSURANCE COMPANY, COMMITMENT NO. 1313511-S
 EFFECTIVE DATE: NOVEMBER 12, 2008 AT 7:00 A.M.

ITEM	DOCUMENT	GRANTEE	REMARK
9	DB 924, PG 99	OHIO TELEPHONE & TELEGRAPH CO.	BLANKET EASEMENT, LOCATION NOT DETERMINED
9	DB 924, PG 107	OHIO TELEPHONE & TELEGRAPH CO.	BLANKET EASEMENT, LOCATION NOT DETERMINED
9	DB 924, PG 116	OHIO TELEPHONE & TELEGRAPH CO.	BLANKET EASEMENT, LOCATION NOT DETERMINED
9	DB 924, PG 118	OHIO TELEPHONE & TELEGRAPH CO.	BLANKET EASEMENT, LOCATION NOT DETERMINED
10	DB 1127, PG 230	COLUMBUS AND SOUTHERN OHIO ELECTRIC CO.	ON SITE, ALONG WEST R/W OF ALTON RD
11	DB 2881, PG 669	JEANETTE McDOWELL	DRAINAGE EASEMENT, ON SITE AS SHOWN
12	DB 3163, PG 457	OHIO TELEPHONE & TELEGRAPH CO.	BLANKET EASEMENT ON SITE
12	DB 3163, PG 390	OHIO TELEPHONE & TELEGRAPH CO.	ON SITE, NOT PLOTTABLE
13	DB 1033, PG 457	COLUMBUS RAILWAY, POWER & LIGHT CO.	ON SITE AS SHOWN
14	DB 1127, PG 258	COLUMBUS AND SOUTHERN OHIO ELECTRIC CO.	NOT ON SITE, ALONG WEST R/W OF ALTON RD
14	DB 1720, PG 513	COLUMBUS AND SOUTHERN OHIO ELECTRIC CO.	ON SITE AS SHOWN
14	DB 3068, PG 211	COLUMBUS AND SOUTHERN OHIO ELECTRIC CO.	ON SITE AS SHOWN
15	DB 2885, PG 342	BOARD OF COUNTY COMMISSIONERS	ON SITE AS SHOWN
16	DB 967, PG 594	COLUMBUS RAILWAY, POWER & LIGHT CO.	NOT ON SITE
17	DB 1771, PG 298	COLUMBUS AND SOUTHERN OHIO ELECTRIC CO.	NOT ON SITE
18	DB 1334, PG 379	COLUMBUS SOUTHERN OHIO ELECTRIC	ON SITE, WITHIN MURNAN ROAD R/W
18	DB 1334, PG 382	COLUMBUS SOUTHERN OHIO ELECTRIC	NOT ON SITE, WEST OF MURNAN ROAD

- LEGEND**
- FF 3/4" ID PIPE FOUND
 - ⊠ 3/4" SOLID BAR FOUND
 - ⊠ FRANKLIN COUNTY MONUMENT
 - PS 3/4" ID PIPE SET
 - RAIL ROAD SPIKE
 - SANITARY MANHOLE
 - GAS VALVE
 - ⊠ STORM CATCH BASIN
 - ⊠ STORM MANHOLE
 - ⊠ TELEPHONE PEDISTAL
 - ⊠ TELEPHONE PEDESTAL
 - SIGN
 - WATER VALVE
 - FIRE HYDRANT
 - ⊠ ELECTRIC MANHOLE
 - ⊠ ELECTRIC PEDESTAL
 - ⊠ POWER POLE
 - GUY POLE
 - ⊠ ELECTRIC BOX
 - ☆ LIGHT POLE
 - LANDSCAPE LIGHT
 - UNDERGROUND TELEPHONE MARKER
 - CABLE TV MARKER
 - CAUTION MARKER

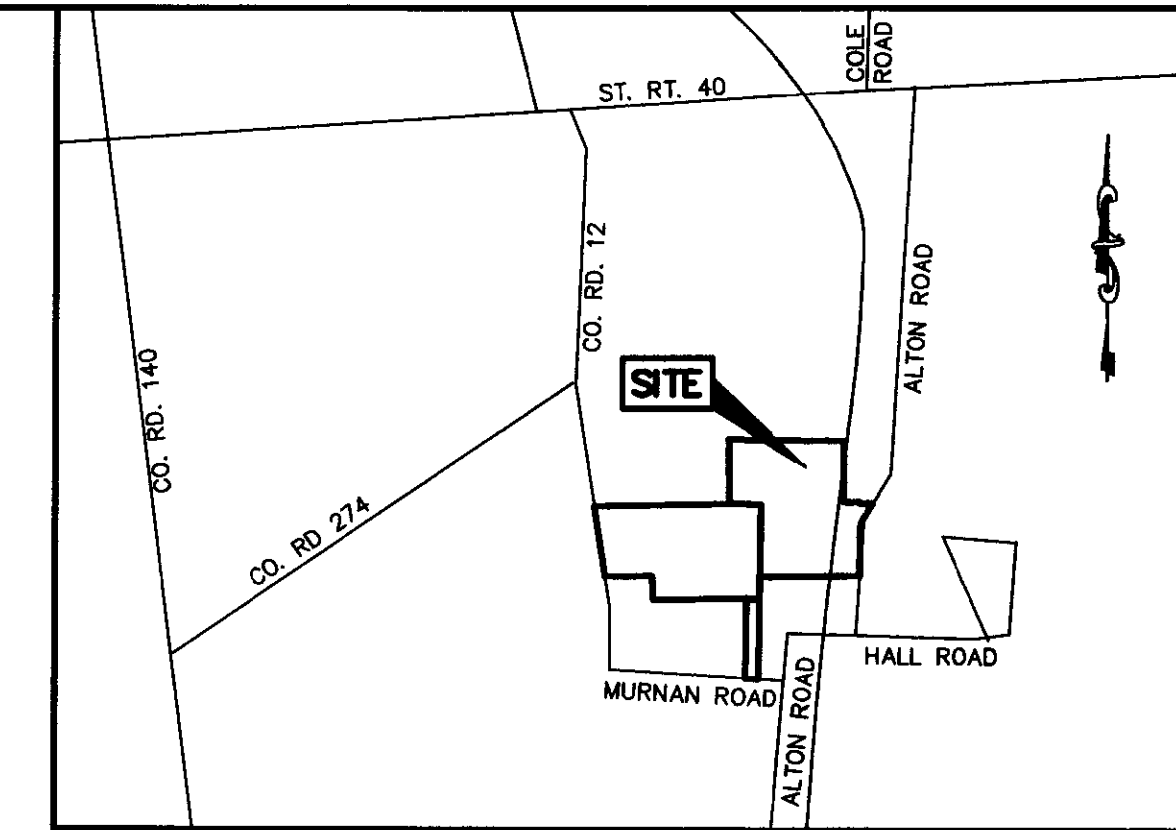

LOCATION MAP
NO SCALE

DESCRIPTION OF 145.629 ACRE TRACT

Situated in the State of Ohio, County of Franklin, Township of Prairie, located in Virginia Military Survey Numbers 5106 and 5234, being all of Parcel One (PIN 240-000178 & 240-000286) and all of Parcel Two (PIN 240-002186) conveyed to ENA Real Estate Investments, LLC (Etal 4) in Instrument Number 200512090260285 (all references refer to records in Franklin County Recorder's Office, Ohio) and more fully described as follows:

Beginning for reference at a Franklin County Monument #1147 at the centerline intersection of Hall Road (County Road 125) and Alton Road (County Road 35);

Thence North 2°48'19" East a distance of 619.81 feet, along the centerline of said Alton Road, to an existing railroad spike at the northeast property corner of Gary S. & Jann L. Kimmel 0.581 acre tract (ORV 4156 C18) being the Point of Beginning;

Thence North 87°12'53" West a distance of 2090.00 feet passing over an existing 1/2" ID pipe at 29.86 feet, along the northerly property line of said 0.581 acre tract, Steven D. and Charlene Y. Scharr 5.303 acre tract (ORV 3378 A15), Thomas G. and Karen L. Abram, Co-Trustees 6.3791 acre tract (IN 200808080121470) and Henrietta M. Dyer Revocable Living Trust Glen H. & Henrietta M. Dyer, Trustees 15.00 acre tract (IN 199809180237982), to an existing 1/2" ID pipe at the northwest corner of said 15.00 acre tract on an easterly property line of ENA Real Estate Investments, LLC 50.664 acre tract (IN 2005121026285);

Thence North 3°55'59" East a distance of 977.98 feet, along the easterly property line of said 50.664 acre tract, to an existing 1" solid iron pin, at the northeast corner of said 50.664 acre tract and southeast property corner of James E. & Joy Timperley 45.697 acre tract (IN 200712270220201);

Thence North 3°57'11" East a distance of 523.32 feet, along the easterly line of said 45.697 acre tract, to an existing 1/2" ID pipe at a southeasterly property corner of James E. & Joy Timperley 8.718 acre tract (ORV 4408 C12);

Thence North 2°50'57" East a distance of 1339.83 feet, along the easterly line of said 8.718 acre tract and 45.697 acre tract, to an existing 1/2" ID pipe at a southeasterly property corner of Sunset Hills Burial Park Association 277.8387 acre tract (IN 200002140030033);

Thence South 86°23'14" East a distance of 2385.58 feet, along a southerly line of said 277.8387 acre tract and passing over an existing 3/4" ID pipe at 1179.11 feet at the southwest corner of said 277.8387 acre tract and southwest property corner of Board of Trustees of Prairie Township, Franklin County, Ohio 118.228 acre tract (IN 200212190326490) to an existing 1/2" ID pipe in a westerly property line of John R. & June C. Bast 6.692 acre tract (DB 2470, Pg. 193);

Thence South 3°02'47" West a distance of 1287.17 feet, along the westerly line of said 6.692 acre tract, Roland G. & Mary Ellen Couture 1.748 acre tract (ORV 31947 E17), Douglas A. Stormont 10.246 acre tract (ORV 8846 D13) and Carlton K. & Gail D. Waters 3.153 acre tract (ORV 30460 E92), to an existing 3/4" ID pipe at the southeasterly corner of said 3.153 acre tract;

Thence South 86°05'46" East a distance of 328.00 feet, along a southerly line of said 3.153 acre tract to an existing 1/2" ID pipe;

Thence South 1°52'52" West a distance of 24.14 feet, along a westerly line of said 3.153 acre tract to an existing 1/2" ID pipe;

Thence South 87°37'25" East a distance of 275.17 feet, along a southerly line of said 3.153 acre tract, passing over an existing 3/4" ID pipe at 246.21 feet, to an existing railroad spike in the centerline of said Alton Road;

Thence South 33°58'08" West a distance of 371.44 feet, along the centerline of said Alton Road, to a point of curvature;

Thence along a curve to the left (delta=31°09'49", radius=573.76 feet, length=312.07 feet, tangent=160.00 feet) to a chord bearing South 18°23'13" West a distance of 308.24 feet, along the centerline of said Alton Road, to a point;

Thence South 2°48'19" West a distance of 879.07 feet, along the centerline of said Alton Road, to the Point of Beginning containing 145.629 acres more or less (72.859 acres in VMS 5106, 72.770 acres in VMS 5234, 113.074 acres in PIN 240-000286, 31.255 acres in PIN 240-000178 and 1.300 acres in PIN 240-002186) according to and actual field survey made by Hockaden and Associates, Inc. in March of 2004 and December of 2008.

For the purpose of this description, a bearing of North 2°48'18" East was used on the centerline of Alton Road, and all other bearings based upon this meridian.

4269510.1-120308-1.1

RECEIVED
DEC 4 2008
Franklin County Engineer
Dean C. Ringler, P.E., P.S.

RECEIVED
DEC 4 2008

DESCRIPTION	
ALTA/ACSM SURVEY	
LOCATION	
EAST OF MURNAN ROAD WEST OF ALTON ROAD SOUTH OF S.R. 40	
CLIENT	
JIM SICARAS	
PREPARED BY:	
HOCKADEN AND ASSOCIATES, INC. Consulting Engineers & Surveyors 883 North Cassady Avenue Columbus, Ohio 43218 Telephone: (614) 292-0893 Fax: (614) 292-0444	
DRAWN BY: FCL	CHECKED BY: FCL
SCALE: 1"=100'	DATE: DEC 2008
ORDER No. 42695/10.1	AREA No. 33-9
SHEET 2 OF 2	

ZONE X (2)
(AUD. PAR. NO. 240-000286)
(AUD. ACREAGE = 101.25 AC.)
(CALCULATED. ACREAGE = 113.074 AC.)

ENA REAL ESTATE INVESTMENTS, LLC (ETAL 4)
IN 200512090260285

PARCEL ONE
144.07 AC. (DEED)
AUD. PAR. NO. 240-000178 & 240-000286

(72.859 ACRES IN VMS 5106)
VMS 5106
(72.770 ACRES IN VMS 5234)

145.629 ACRES TOTAL (DEED)
142.68 AC. TOTAL (AUDITORS)

145.629 ACRES
(BY SURVEY)

ROADWAY R/W = 1.146 ACRES

(AUD. PAR. NO. 240-000286)
(AUD. ACREAGE = 101.25 AC.)
(CALCULATED. ACREAGE = 113.074 AC.)

SEE SHEET #1
50.664 ACRES
ENA REAL ESTATE INVESTMENTS, LLC (ETAL 4)
IN 2005121026285
50.676 AC. (DEED)
(AUD. PAR. NO. 240-00102)

FLOODPLAIN

ZONE AE AS SHOWN HEREON, THE SUBJECT PREMISES LIES WITHIN "ZONE AE" (SPECIAL FLOOD HAZARD AREAS INUNDATED BY 100-YEAR FLOOD; BASE FLOOD ELEVATIONS DETERMINED)

ZONE X (1) AND "ZONE X" (AREAS OF 500-YEAR FLOOD; AREAS OF 100-YEAR FLOOD WITH AVERAGE DEPTHS OF LESS THAN 1 FOOT OR WITH DRAINAGE AREAS LESS THAN 1 SQUARE MILE, AND AREAS PROTECTED BY LEVEES FROM 100-YEAR FLOOD)

ZONE X (2) AND "ZONE X" (AREAS DETERMINED TO BE OUTSIDE 500-YEAR FLOODPLAIN) AS DETERMINED BY THE FEDERAL EMERGENCY MANAGEMENT AGENCY, AS GRAPHICALLY DEPICTED FROM FIRM COMMUNITY PANEL NO. 39049C0220 G, EFFECTIVE DATE AUGUST 2, 1995.

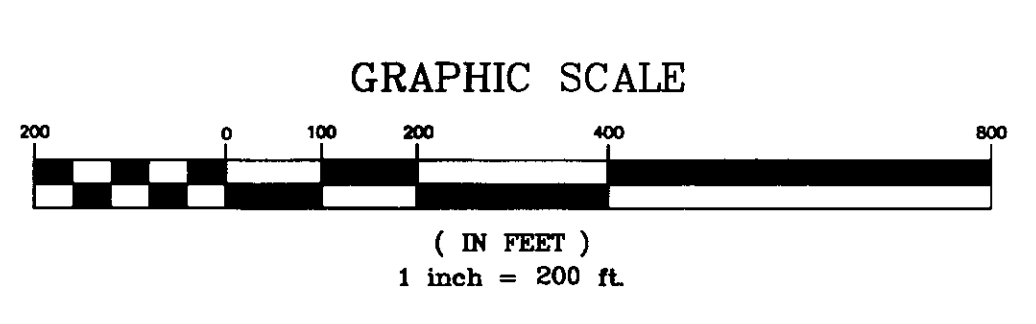

- LEGEND**
- PF 3/4" ID PIPE FOUND
 - ⊗ 3/4" SOLID BAR FOUND
 - FRANKLIN COUNTY MONUMENT
 - PS 3/4" ID PIPE SET
 - ▲ RAIL ROAD SPIKE
 - SANITARY MANHOLE
 - ⊕ GAS VALVE
 - ⊖ STORM CATCH BASIN
 - ⊙ STORM MANHOLE
 - ⊞ STORM INLET
 - ⊠ TELEPHONE PEDISTAL
 - ⊡ TELEPHONE PEDISTAL
 - ⊢ SIGN
 - ⊘ WATER VALVE
 - ⊙ FIRE HYDRANT
 - ⊕ ELECTRIC MANHOLE
 - ⊖ ELECTRIC PEDISTAL
 - ⊙ POWER POLE
 - ⊙ GUY POLE
 - ⊗ ELECTRIC BOX
 - ⊙ LIGHT POLE
 - ⊙ LANDSCAPE LIGHT
 - ⊙ UNDERGROUND TELEPHONE MARKER
 - ⊙ CABLE TV MARKER
 - ⊙ CAUTION MARKER

