

Gregory B. Drake
Official Record 29269G08

RECEIVED

MAR 01 2005
Franklin County Engineer
Dean C. Ringle, P.E., P.S.

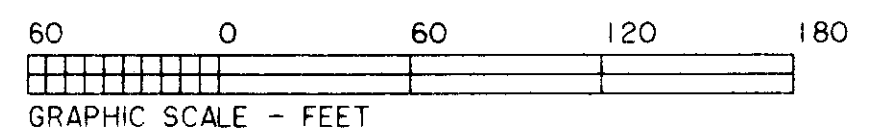
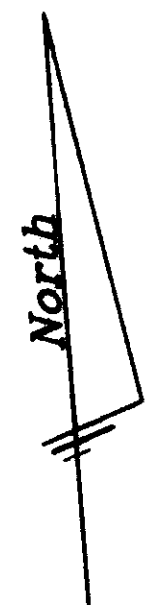
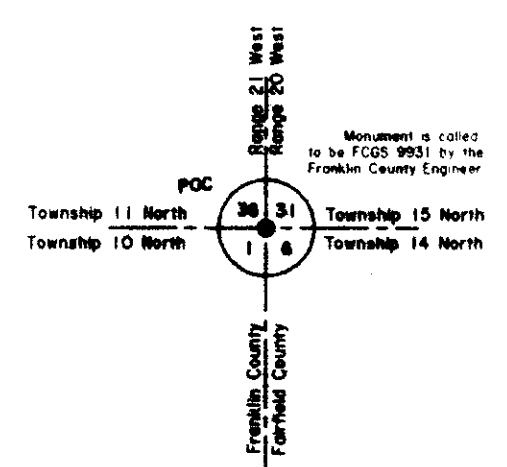

The bearings based on all the bearings shown in instrument Number 200405100106702.

Mary Ann Clark
Official Record 10469C01

N 04°25'48"E 441.40'

Rex F. & Michelle R. Williams
Instrument Number 200405100106702

8.3695 Acres

Canal Winchester South Road
AKA Winchester-Southern Road
AKA Washington Street (60')

S 85°09'40"E 285.00'

1.3729 Acres

N 04°25'48"E 180.01'

S 63°23'15"E 54.00'

330.00'

460.00'

160.00'

30.00'

30.00'

30.00'

30.00'

30.00'

30.00'

30.00'

30.00'

30.00'

30.00'

30.00'

Lithopolis Road
N 49°35'18"W 70.47'
(60')

483.04'

N 85°07'39"W 818.04'

335.00'

William S. & Lora E. Griffith
Official Record 3594F10

LEGEND

- 3/4 inch Iron Pipe Found
- 3/4 inch Iron Pipe Set (as per ORC 4733-37-03 (C))
- △ Railroad Spike Found
- △ Railroad Spike Set
- Stone Found
- ⊙ Concrete Monument w/ Brass Cap

I, Eric A. Long, Fiscal Officer for the Village of Lithopolis do hereby certify that this is a true and accurate copy of: *LOT SPLIT*

E. Long 3-01-05

Two Parcels		Ahlers, Moe & Assoc., Inc. Engineers & Surveyors 360 West Waterloo Street P.O. Box 2 Canal Winchester, Ohio 43110 (614) 837-1178	<i>RGR</i> Job No.: 04-0520
D.B.	Page		
P.B.	Page		
Scale:	1" = 60'		
Date:	27 July 2004		
Drawn By:	RGR	Part of Section 1, Township 10 North, Range 21 West of the Buckingham Survey of the Congress Lands Madison Township, Franklin County, Ohio	