

Situated in the State of Ohio,
 County of Franklin, City of
 Columbus, being located in Virginia
 Military Survey Nos. 1396 and 2668,

LEGEND

- IRON PIN SET IRON PIN SET
("M-E COMPANIES/S-6872)
- ⊙ 1" HOLLOW IRON PIN FOUND
- MAG NAIL SET

BEARING REFERENCE

Bearings herein are based on North 85°54'25" West,
 for the northerly right-of-way line of McKinley
 Avenue as referenced in Instrument No.
 200106270145760

RECEIVED

MAR 24 2005

Franklin County Engineer
 Dean C. Ringle, P.E., P.S.

PRINT DATE:	FIELD	PM	DRAW
	DC	BW	EM
	F.B.	PG.	
	JOB NO.: 05-117		
SHEET NO.:	DATE: MARCH 2005		
	SCALE: 1"=50'		

PROPERTY SPLIT EXHIBIT

F/W INVESTMENT, LTD.
 1330 MCKINLEY AVENUE
 COLUMBUS, OHIO

M-E COMPANIES

635 Brookside Boulevard
 Westerville, OH 43081
 Contact: DAVE CHIESA
 614-818-4900 ext. 225
 Fax: 618-4902

David L. Chiesa 7740
 REGISTERED SURVEYOR NO. DATE 3/24/05

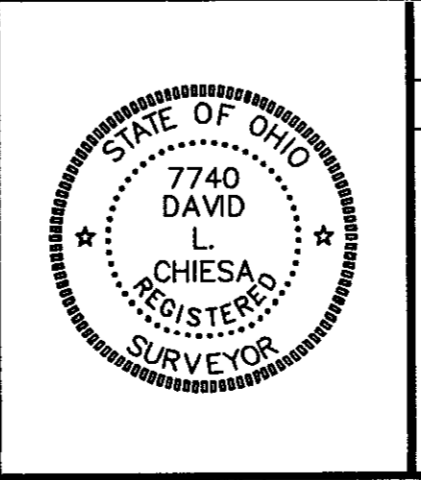

REVISIONS		
DATE	BY	DESCRIPTION

J:\Land Projects\05-05-117.dwg (0517)BND.dwg by dchiesa on 03/24/2005 © 08:57:41 am for M-E Companies, Inc.