

LOT SPLIT EXHIBIT

STATE OF OHIO, COUNTY OF FRANKLIN, CITY OF COLUMBUS
SECTION 21, TOWNSHIP 12, RANGE 21, REFUGEE LANDS

INTERSTATE ROUTE 70
N85°59'00"E 183.49'

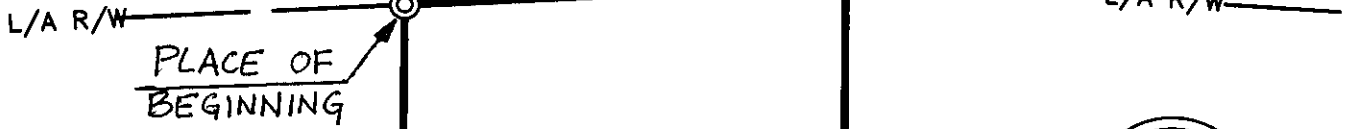

NORTH

VACANT LAND

LIONMARK DEVELOPMENT PARTNERS
7.093 ACRES (PARCEL 2)
O.R.V. 7793, PG. J16

LIONMARK CORPORATE CENTER
P.B. 65, PG. 87
LOT 2

LEGEND

- ⊙ IRON PIN SET 1" PIPE
30" LONG CAPPED
"M-E COMPANIES/S-6872"
- ⊙ 1" O.D. IRON PIN FOUND (NO CAP)
- PK NAIL FOUND

BEARING REFERENCE

BEARINGS HEREON ARE BASED
ON NORTH 89°43'46" WEST
FOR HILTON LANE AS
REFERENCED ON THE PLAT
LIONMARK CORPORATE CENTER
PLAT BOOK 65, PAGE 87

PLATINUM LODGING, LLC
INSTR. No. 200404180085915
7.689 ACRES

2.500 ACRES

PART OF LOT 2
(NO BUILDING)

RECEIVED

OCT 26 2004

Franklin County Engineer
Dean C. Ringle, P.E., P.S.

~~PLACE OF
BEGINNING~~

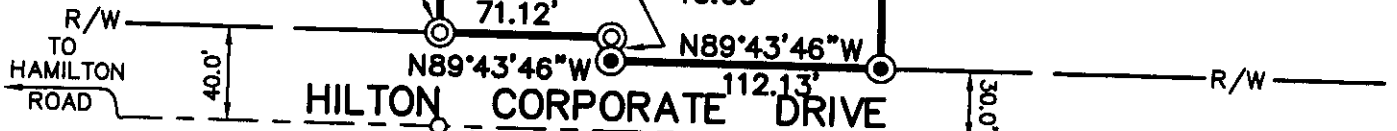

HILTON CORPORATE DRIVE
(f.k.a. HILTON LANE)

CLOVERLEAF
STREET EAST

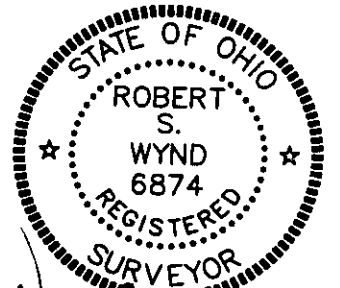

SCALE: 1"=80'

SURVD	DRAW	CHECKED
EM	DC	<i>Rha</i>

DATE 10/4/04	04-408
REVISED DATES	JOB NUMBERS
10/26/04	

BY *Robert S. Wynd* 6874
REGISTERED SURVEYOR No.