

TOY ROAD (33' R/W)

SWISHER RD.

FRANKLIN MONUMENT IS AT THE N.E. CORNER OF THE S.E. QTR. OF SECT. #33.

JOHN E. & MARGARET A. STANBAUGH D.B. 1574 PG. J-05 107.43 AC.

DETAIL 'A'

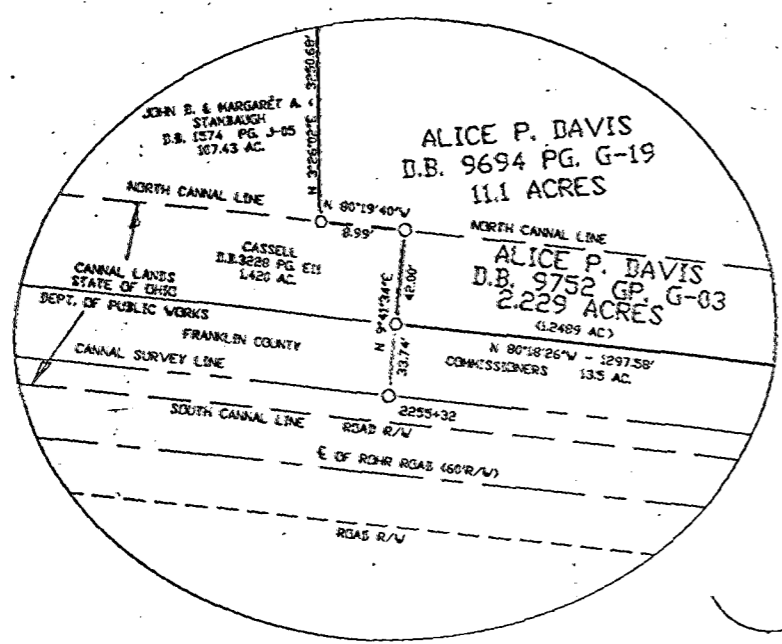

100.0000 ACRES

ALICE P. DAVIS D.B. 9694 PG. G-19 11.1 ACRES
ALICE P. DAVIS D.B. 9694 PG. G-19 48.9 ACRES (48.9121 AC.)

ALICE P. DAVIS D.B. 9752 PG. G-03 105 ACRES

LEGEND

- CORNER STONE (FOUND)
- IRON PIPE (FOUND)
- IRON PIPE & YELLOW PLASTIC CAP STAMPED "ENHET" (FOUND)
- RAILROAD SPIKE (SET)
- 5/8" DIA REBAR & YELLOW PLASTIC CAP STAMPED "COTTRILL 6856" (SET)
- △ FRANKLIN COUNTY MONUMENT

BEARINGS BASED ON THE C. OF ROHR ROAD (58018'26"E) AS SHOWN ON SHEET #9 OF THE PLAT OF OHIO CANAL LANDS TO BE ACQUIRED FOR PUBLIC ROADS BY FRANKLIN CO. COMMISSIONERS ON APRIL 11, 1961 ON FILE IN THE OFFICE OF THE FRANKLIN CO. ENGINEER.

NOTE

REFERENCE IS MADE TO SHEET #9 OF THE PLAT OF THE OHIO CANAL LANDS TO BE ACQUIRED FOR PUBLIC ROADS BY FRANKLIN CO. COMMISSIONERS ON APRIL 11, 1961 ON FILE IN THE OFFICE OF THE FRANKLIN CO. ENGINEER.



SECTION 30
SECTION 31

SECTION 30
SECTION 31

11.1 ACRES (11.4686 AC.)

ALICE P. DAVIS D.B. 9752 PG. G-03 2.229 ACRES

JOHN E. & JOYCE CASSELL D.B. 3228 PG. E11 1.420 AC.

DETAIL 'A'

ROHR ROAD (60' R/W)



I HEREBY CERTIFY THAT THIS PLAT DEPICTS AN ACTUAL FIELD SURVEY PERFORMED BY JAMES R. COTTRILL, P.S. #8753 DATE 12-17-91

JAMES R. COTTRILL P.S.
8256 S.R. 207 NE MT. STERLING, OHIO 43143 PH. (614) 860-3814

PLAT OF
100.0000 ACRES, S.E. QTR. SECT. #30 & N.E. QTR. SECT. # 31, TOWNSHIP 11, RANGE 2, MATTHEWS SURVEY, CONGRESS LAND, MADISON TOWNSHIP, FRANKLIN CO., OHIO.

SCALE: 1" = 200'
DATE: 12-17-91