

# HOCKADEN AND ASSOCIATES, INC.

CONSULTING ENGINEERS

883 N. CASSADY AVENUE

COLUMBUS, OHIO 43219

(614) 252-0993

EXHIBIT FOR  
TRACT 2

SITUATED IN THE STATE OF OHIO, COUNTY  
OF FRANKLIN, CITY OF COLUMBUS,  
SECTION 7, TOWNSHIP 11, RANGE 21,  
CONGRESS LANDS.

FRANKLIN COUNTY MON. No. 8840  
POINT OF REFERENCE

WATKINS ROAD  
S 84° 54' 30" E

FOR THE PURPOSE OF THIS PLAT A BEARING OF  
SOUTH 4° 45' 12" WEST WAS USED ON THE  
CENTERLINE OF ALUM CREEK DRIVE.

ALUM CREEK DRIVE  
S 4° 45' 12" W 879.78'

PAINE DEVELOPMENT CO., LTD.  
34.009 ACRES  
PARCEL 2  
D.B. 3700, PG. 555

IRON PIN FOUND (TYP.)

S 4° 50' 46" W  
122.00'

TRUE PLACE OF BEGINNING

S 84° 58' 22" E  
60.00'

SEE DETAIL "A"

ALUM CREEK DRIVE  
S 4° 50' 46" W 1004.29'  
TRACT 2  
N 4° 50' 46" E 1004.44'

Ⓐ CITY OF COLUMBUS OHIO  
0.1384 AC.  
O.R.V. 15439 C12

Ⓑ HENRY O'CONNOR  
AND  
JAMES R. POSPISIL  
0.602 AC. (ORIG.)  
O.R.V. 15439 C10

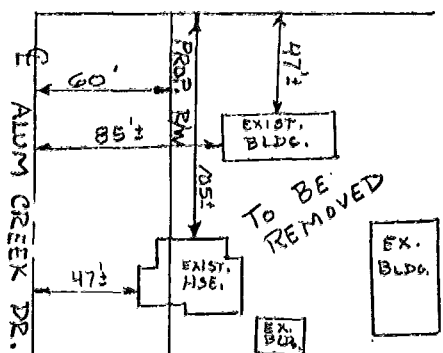

DETAIL "A" NO SCALE

PAINE DEVELOPMENT CO., LTD.  
48.308 ACRES  
PARCEL 1  
D.B. 3700, PG. 555

RAILROAD SPIKE FOUND

ALUM CREEK DRIVE  
S 4° 55' 41" W 768.97'  
2.443 ACRES  
N 4° 55' 41" E 769.41'

WE HEREBY CERTIFY THAT THE FORGOING  
PLAT HAS BEEN PREPARED FROM AN  
ACTUAL FIELD SURVEY OF THE PREMISES.

N 85° 32' 16" W  
60.00'

BOARD OF EDUCATION OF THE CITY  
SCHOOL DISTRICT OF COLUMBUS, OHIO  
25.09 ACRES ; D.B. 3411, PG. 111

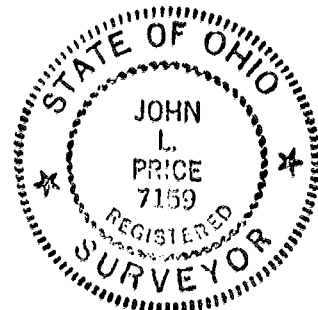

HOCKADEN AND ASSOCIATES, INC.  
CONSULTING ENGINEERS

By *John L. Price*  
REGISTERED SURVEYOR 7159

SCALE 1" = 300'

DATE: 2/26/91  
REVISED DATES

P-774  
ORDER NUMBERS

SURV'D.	DRAWN	CHECKED
D.W.	J.L.P.	

0466925  
E-11190

MADISON  
O-11190  
Twp