

Ezra Stapleton  
Deed Book 2561, Page 509

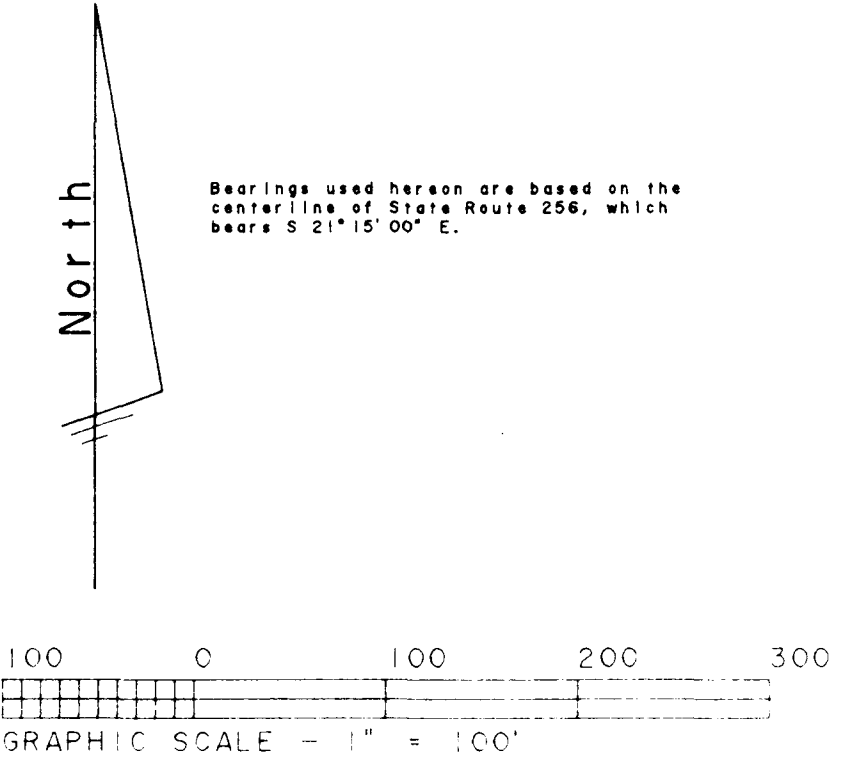

LEGEND

- Iron Pin Found
- Iron Pin Set
- ▲ Railroad Spike Found
- △ Railroad Spike Set
- Stone Found
- ⊙ Concrete Monument with Brass Cap

TO ALL PARTIES INTERESTED IN TITLE TO THE PREMISES SURVEYED:

I do hereby state that this is a true and accurate survey made by me or under my supervision, and that all points are as called, and that there are no encroachments either way across any line except as shown.

*R.G. Rudnik*  
Rena'd G. Rudnik P.S. 5323

Date 11-20-89

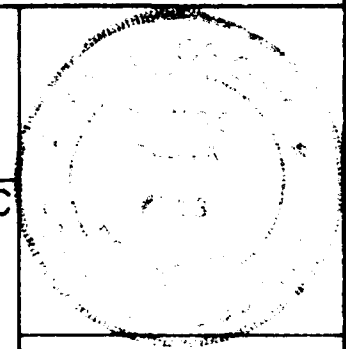
<b>Boundary Survey</b>		
Truro Township, Franklin County, Ohio Half Section 29, Section 18, Township 16 North, Range 20 West, Refugee Lands		
C.R.	13468A10	<b>AHLERS, MOE &amp; ASSOC, INC</b> Engineering & Surveying 360 West Waterloo Street P.O. Box 2 Canal Winchester, Ohio 43110 (614) 837-1178
P.B.	Page	
Scale	1" = 100'	
Date	11-15-89	
Drawn By	RGR	
		Job No. 89-2110