

SURVEY OF 19.308 ACRE TRACT

Located in Part of Lot II, Section 2
Township 1, Range 16
United States Military Lands
Jefferson Township, Franklin County, Ohio

27 Ac.

West Half Lot II
East Half Lot II

588°47'30"W 435.08' N. Line Lot II 89.14' 116.60'
589°19'E 205.74'

N. W. corner East Half Lot II

Burdette F. & Iva Cleora Spaeth
D.B. 1305, Page 409

11.767 Ac.

7.541 Ac.

Helen M. Brookhouse
58.86 Ac.
D.B. 1050, Page 95

Marian L. Beck
12 Ac.
D.B. 1559, Page 479

19.308 Ac.
(Total)

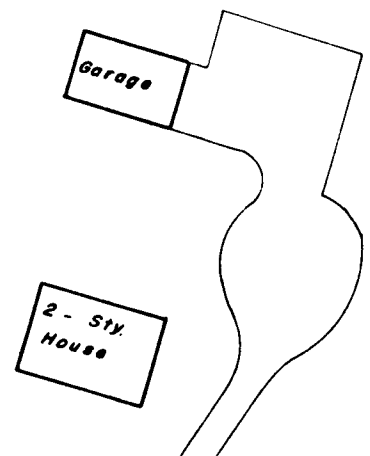

Well

gar.

693

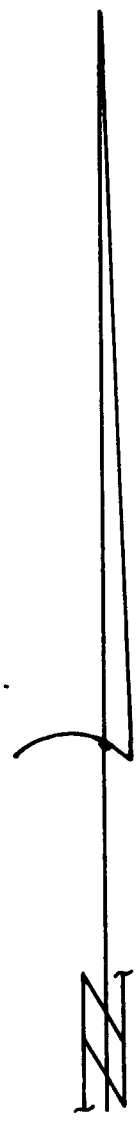

Fence

N 0° 38' E 1327.05'

N 12° 30' 40" E 901.63'

S 1° 12' 20" W 1298.79'

76.32' N 1° 30' W

335.0'

N 13° 20' E

270'

S 82° 05' 36" W

143.0'

N 31° 26' E

26.34'

R.R. Spike

66.72'

N 13° 20' E

335.0'

N 13° 20' E

335.0'

N 13° 20' E

335.0'

ROAD

363.25'

S 82° 05' 36" W

54.8'

S 82° 05' 36" W

0.098 Ac.

1/8 Acre

228.36'

221.36'

N 20° 12' E

2205.12'

CLARK STATE ROAD

Jack B. Nell Oyer
1 Ac.
D.B. 2686, Page 245

1.520 Ac.

1.053 Ac.

9.188 Ac.

0-37

Surveyed & Platted
By
EVANS, MECHWART, HAMBLETON & TILTON, INC.
Consulting Engineers & Surveyors
Gahanna, Ohio

By E. E. Maddy
Registered Surveyor No. 4465

Scale: 1" = 60'

September 13, 1966

o = Iron Pin

0730 120 059 064 M CLARK STATE RD 1966 0975 030

S.W. corner East Half Lot II