

NOTE: IRON PINS SET ARE 30' X 1" O.D. WITH YELLOW PLASTIC CAPS INSCRIBED 6065.

NOTE: SUBJECT PREMISE IS SUBJECT TO ALL EASEMENTS, RESTRICTIONS, AND RIGHTS OF WAY (IF ANY) OF PREVIOUS RECORD.

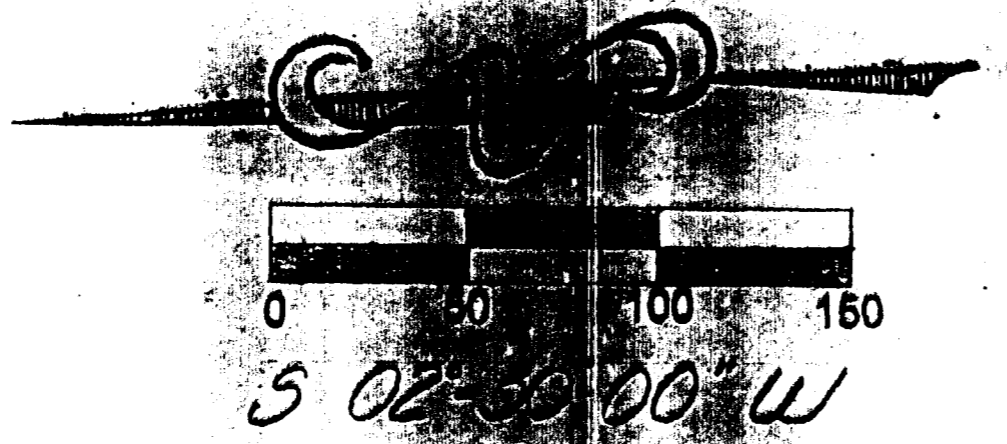

LOTTIE J. MOOK
2.20 AC.
O.R. 28929 A10

S 87° 45' 00" E
109.81'
IRON PIN (FOUND)

S 87° 59' 30" E 404.82'

601.32'
1.515 ACRES
AMERICAN LEGION POST NO. 532
O.R. 18412 B07
2.389 ACRES (DEED)

601.32'
N 02° 30' 00" E

S 87° 45' 00" E
109.81'
IRON PIN (SET)

357.00'
0.899 ACRES
1 STORY RANCH
ASPHALT
POINT OF BEGINNING
1.515 ACRE TRACT
IRON PIN (SET)

0.069 ACRE TRACT
TRUE POINT OF BEGINNING
RAILROAD SPIKE (FOUND)
0.077 ACRE
O.R. 2764 A10

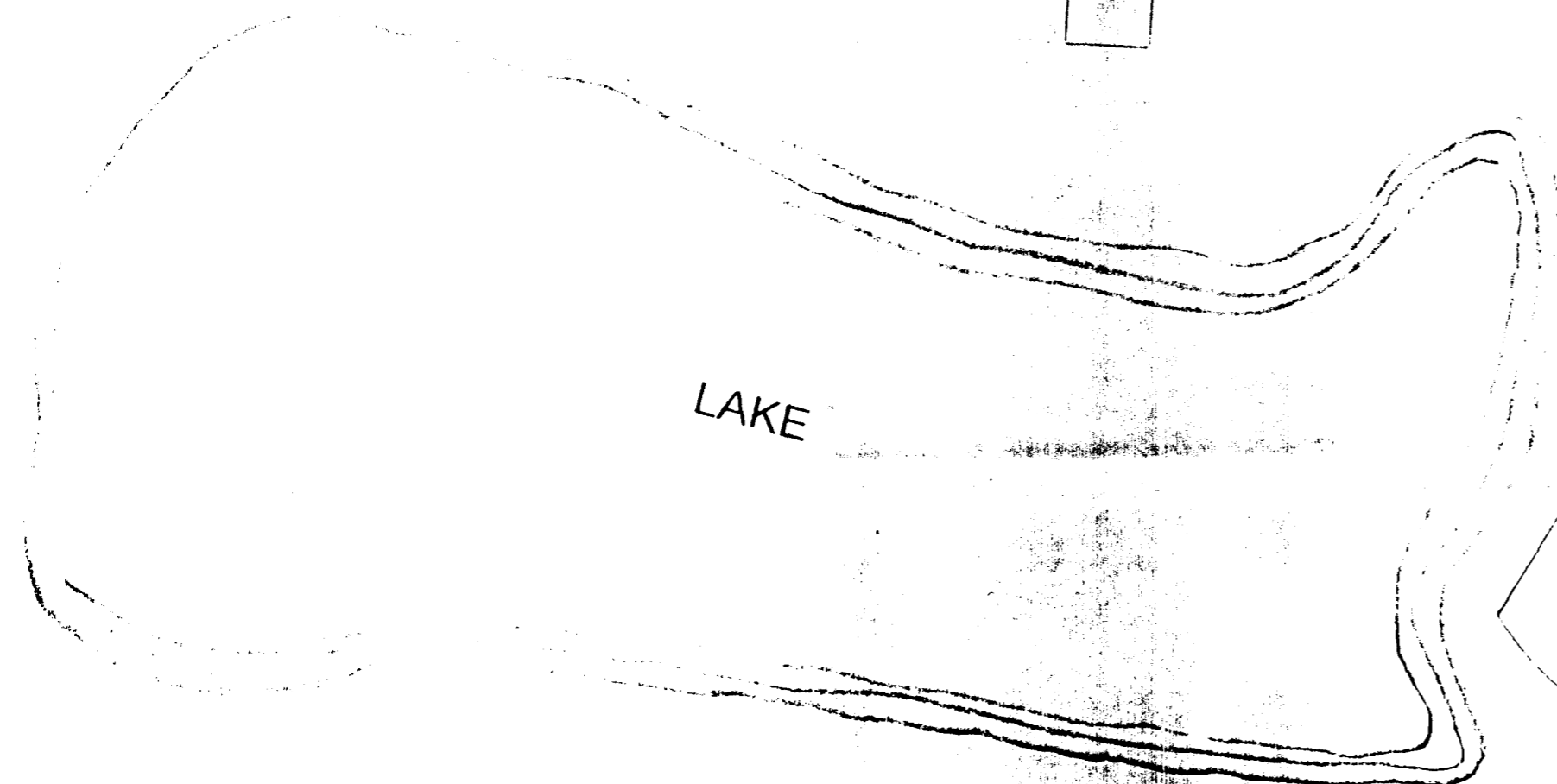

LAKE

AMERICAN LEGION POST NO. 532
O.R. 03297 C18
8.886 ACRES

RIGHT-OF-WAY
CITY OF COLUMBUS 0.277 ACRES O.R. 29764 A10
30'

V.M.S. 2442
V.M.S. 1388
N 87° 45' 00" W 109.81'

DEMOREST ROAD 50'

N 02° 30' 00" E 960.23'

DONNA AND MARY L.
SCHRECK
O.R. 10879 G07
13.616 ACRES

Basis of Bearing used within the attached plat is the centerline of Demorest Road being, N 87 45' 00" W, as shown in Official Record 18412 B07 Franklin County Recorders Office, Franklin County, Ohio

Arnold Survey Company

3911 BROADWAY STREET SUITE C GROVE CITY, OHIO 43123 TEL. (614) 875-7400



I HEREBY CERTIFY THAT THE ATTACHED PLAT WAS PREPARED FROM INFORMATION OBTAINED FROM AN ACTUAL FIELD SURVEY OF THE PREMISES AND THAT SAID PLAT IS CORRECT TO THE BEST OF MY KNOWLEDGE.

Roger P. Arnold
REGISTERED SURVEYOR NO. 6065
ROGER P. ARNOLD

Boundary Survey

PROPOSED LOT SPLIT

SCALE: 1" = 50'	APPROVED BY: <i>R.P. Arnold</i>	DRAWN BY: <i>R.P. Arnold</i>
DATE: 7-14-2000	REV: 12-17-2000	
CITY OF COLUMBUS		FRANKLIN TWP.
FRANKLIN COUNTY, OHIO		DRAWING NUMBER: 798

REFERENCE POINT OF BEGINNING
0.899 ACRE TRACT
1.515 ACRE TRACT