

W. MOUND ST. 60'

Beginning Point of description

N 71°45'E 260.51'

PX nail

S 18°15'04"E 161.03'

N 71°43'29"E 24.47'

S 18°15'04"E 282.08'

UNITED WAY OF FRANKLIN COUNTY, INC.
7.745 Ac.
TRACT 2 Parcel 1 D.R.V. 6727 H-08

3.300 AC.

1 sty. block/metal building (to be demolished)

BALTIMORE & OHIO RAILROAD

Survey of 3.300 Acres, (part of the 7.745 Ac. tract, Tract 2, Parcel 1, and all of a 0.20 Ac. tract, Tract 2, Parcel 2), conveyed to United Way of Franklin County, Inc., in Official Records Volume 6727 H-08 (Recorder's Office, Franklin County, Ohio), in Virginia Military Survey #422, City of Columbus, Ohio.

For
UNITED WAY OF FRANKLIN COUNTY, INC.

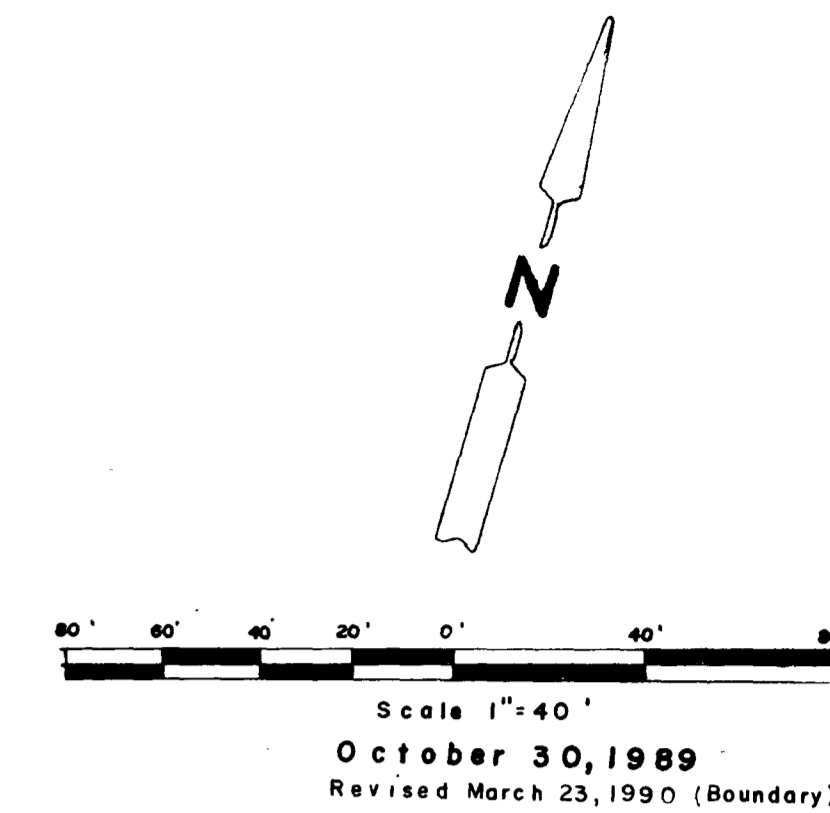

We hereby certify that the foregoing plot was prepared from an actual survey of the premises made in October, 1989, and is correct to the best of our knowledge. Iron pins set are 30" x 1/2" (O.D.) with orange plastic caps inscribed P.S. 6579. Basis of bearings is centerline bearing of W. Mound Street from former deed (D.R.V. 6727 H-08).

Albert J. Myers

Myers Surveying
COMPANY

2740 East Main Street
Bexley, Ohio 43209
(614) 235-8877
Telefax 235-4559

