

ELIZABETH K. CHAPMAN
O.R.V. 539 A13

7.609 ACRES

RUTH H. SAVAGE
INSTR. 199712290176469

CHARLES A. SMITH & TED A. SMITH
INSTR. 199712230173842

NOTES PERTAINING TO SCHEDULE B-II FROM
CARDINAL TITLE AGENCY, INC., APPLICATION NO.
CT 3749 EFFECTIVE DATE SEPTEMBER 15, 1999 AT
8:00 A.M.

ITEM 7: Roadside Right of Way granted to Columbia Gas of Ohio, Inc. appearing of record in Deed Book 2709, Page 563, Recorder's Office, Franklin County, Ohio. (does not affect the premises as shown)

ITEM 8: Deed of Permanent Easement granted to City of Columbus, Ohio appearing of record in Deed Book 3428, Page 484, Recorder's Office, Franklin County, Ohio. (does not affect the premises as shown)

DESCRIPTION OF A 7.609 ACRE TRACT, NORTH OF WEST CASE ROAD, EAST OF SAWMILL ROAD, 1704 WEST CASE ROAD

Situate in the State of Ohio, County of Franklin, and Township of Perry, Section 1, Township 2, Range 19, United States Military Lands, being 7.609 acres of that tract conveyed to Elizabeth K. Chapman, Official Record Volume 539 A13, (being on file in the Recorder's Office, Franklin County, Ohio) and being more particularly described as follows:

Beginning for reference at a OSUPort United States Coast & Geodetic Survey (USC & GS) Monument; Thence South 44°19'25" East, a distance of 215.74 feet to an iron pin found at the northeast corner of 7.609 acre tract conveyed to said Elizabeth K. Chapman, and being the northwest corner of that tract conveyed to Charles A. Smith & Ted A. Smith, Instrument No. 199712230173842, being the True Point of Beginning;

Thence South 02°04'57" West along the westerly property line of said Charles A. Smith & Ted A. Smith, a distance of 1116.27 feet to an existing iron pin at the northeast corner of that tract conveyed to Ruth H. Savage, Instrument No. 199712290176469;

Thence North 87°20'53" West along the northerly property line of said Savage, a distance of 191.66 feet to an iron pin found;

Thence North 87°20'53" West a distance of 101.83 feet to an iron pin set;

Thence North 01°36'25" East along the easterly property line of that tract conveyed to the State of Ohio, Deed Book 1951, Page 323, a distance of 1107.56 feet to an iron pin set;

Thence South 89°01'19" East along the southerly property line of that tract conveyed to the State of Ohio, Deed Book 2247, Page 588, a distance of 302.72 feet to the Point of Beginning, containing 7.609 acres more or less according to an actual field survey of the premises made by Hockaden and Associates, Inc. in October of 1999.

For the purpose of this Survey North 01°36'25" East was assumed along the westerly property line of said Chapman.

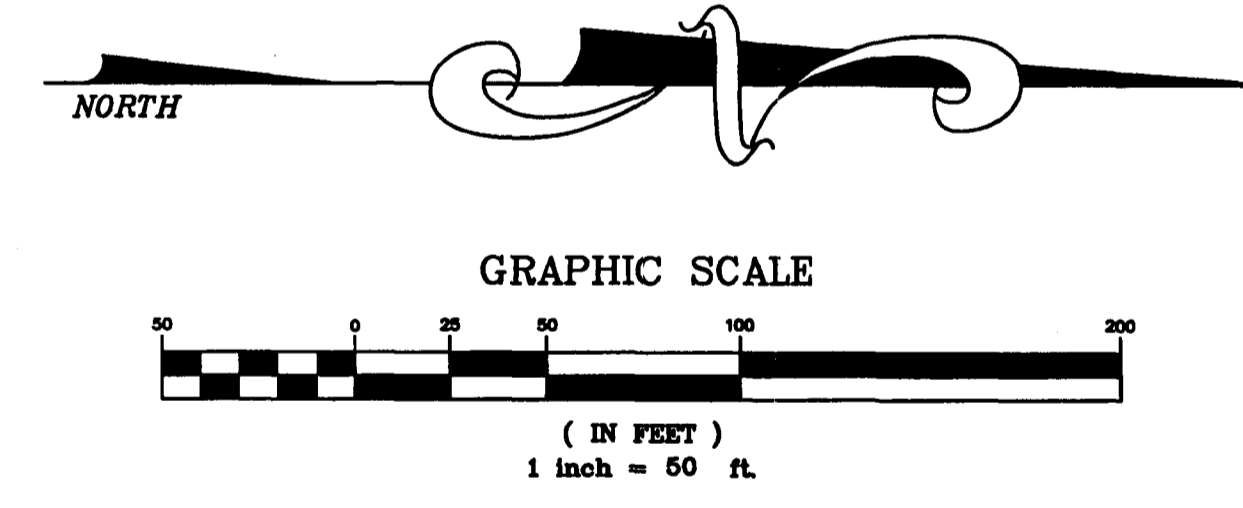

ACCORDING TO THE FEDERAL EMERGENCY MANAGEMENT AGENCY FLOOD INSURANCE RATE MAP "FIRM" MAP NUMBER 39049C0130 G EFFECTIVE DATE AUGUST 2, 1995 THIS TRACT OF LAND IS IN ZONE "X" AREAS DETERMINED TO BE OUTSIDE 500-YEAR FLOODPLAIN.

CERTIFIED TO: THE OHIO STATE UNIVERSITY

THIS IS TO CERTIFY THAT THIS MAP OR PLAT AND SURVEY ON WHICH IT IS BASED WERE MADE IN ACCORDANCE WITH "MINIMUM STANDARD DETAIL REQUIREMENTS FOR ALTA/ACSM LAND TITLE SURVEYS," JOINTLY ESTABLISHED AND ADOPTED BY ALTA, ACSM AND NSPS IN 1997, AND INCLUDES ITEMS 1,2,3,4,6,7,8,9,10,11,13,14,15, AND 16 OF TABLE A THEREOF AND PURSUANT TO THE ACCURACY STANDARDS AS ADOPTED BY ALTA AND ACSM AND IN EFFECT ON THE DATE OF THIS CERTIFICATION OF AN URBAN SURVEY.

HOCKADEN AND ASSOCIATES, INC.
CONSULTING ENGINEERS

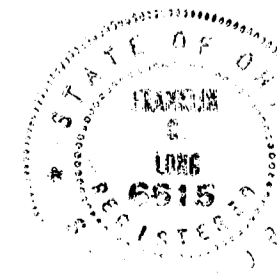

FRANK C. LONG
PROFESSIONAL SURVEYOR NO. 6615

LEGEND

- = WATER LINE
- = WIREFENCE
- = DECIDUOUS TREE
- ▲ = CONIFER TREE
- △ = SEPTIC TANK
- = IRON PIN FOUND
- = MAILBOX
- ⊕ = TELEPHONE PEDISTAL
- ⊕ = POWER POLE
- = CATCH BASIN
- = STORM PIPE INVERT
- ⊕ = WATER TAP
- ⊕ = GAS TAP
- = IRON PIN SET

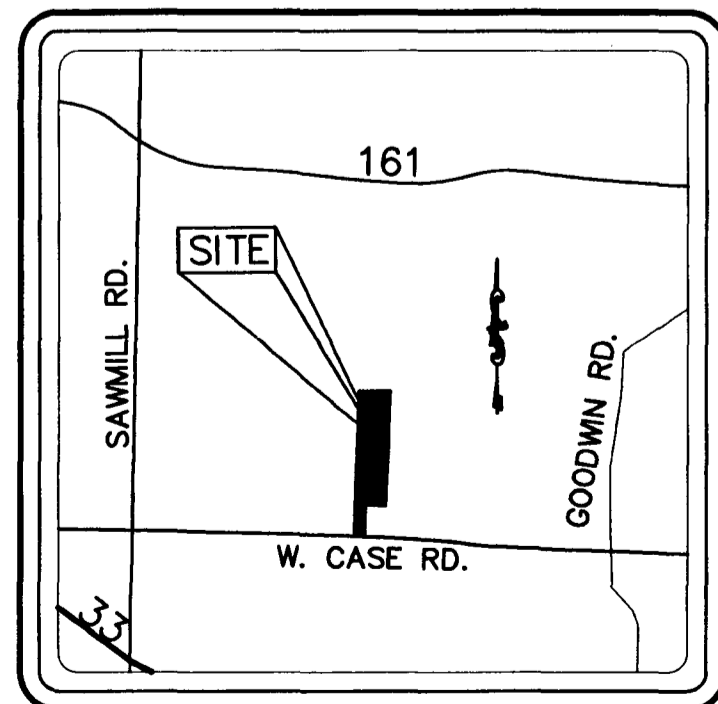

LOCATION MAP
-NOT TO SCALE-

DESCRIPTION
ALTA/ACSM SURVEY

LOCATION
NORTH OF WEST CASE ROAD
EAST OF SAWMILL ROAD
1704 WEST CASE ROAD

CLIENT
THE ROBERT WEILER CO. REALTORS

PREPARED BY:
HOCKADEN AND ASSOCIATES, INC.
Consulting Engineers & Surveyors
883 North Casady Avenue
Columbus, Ohio 43219
Tele.: (614) 252-0993
Fax: (614) 252-0444
Engineering E-Mail: hockeng@osacomp.com
Surveying E-Mail: hocksurv@osacomp.com