

N. 69° 48' E.

May 31, 1945.

PLAT OF CETA & CARL F. WORLEY TRACT,  
Plain Township, Franklin County, Ohio.

For: James M. Watts.  
Showing division into two tracts.  
Order No. 5837

ROSS A & RUTH M. WATTS  
21.844 AC.

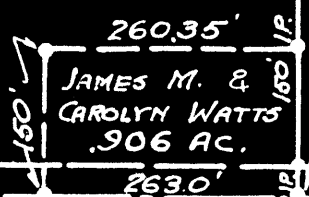

N. 0° 03' E. 1352.6'

20.000 AC.

S. 0° 03' W. 1334.5'

N. 0° 03' E.

39.908 AC.

653.3' WEST

1299.7' WEST

WALNUT ST. 60'

S. 0° 13' W. 1338.4'

WM. F. BLAINE - 160. AC.

THE THOMAS ENGINEERING & SURVEY

*Walter B. Blaine*

